

Mercedes A-Klasa (W169)
Mercedes B-Klasa (W245)

(10/2004 - 2012)
(06/2005 - 2011)

M-098

- PL** **Zaczep Kulowy** Instrukcja montażu i eksploatacji
- GB** **Tow bar** Installation and operating instructions
- D** **Die Anhängerkupplung** Montage- und Gebrauchsanleitung
- ES** **Gancho de remolque** Las instrucciones de instalación y de operación
- RU** **Фаркоп** Инструкция по установке и эксплуатации ТСУ
- FR** **Attelage** Notice de montage et d'utilisation
- IT** **Gancio traino** Istruzioni di montaggio
- CZ** **Tažné zařízení** Návod na montáž a použití
- RO** **Cârlig de remorcare** Instrucția de montaj și exploatare
- SE** **Dragkulan** Monterings- och bruksanvisningar.

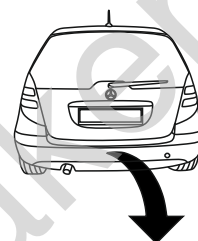

YES NO



YES NO

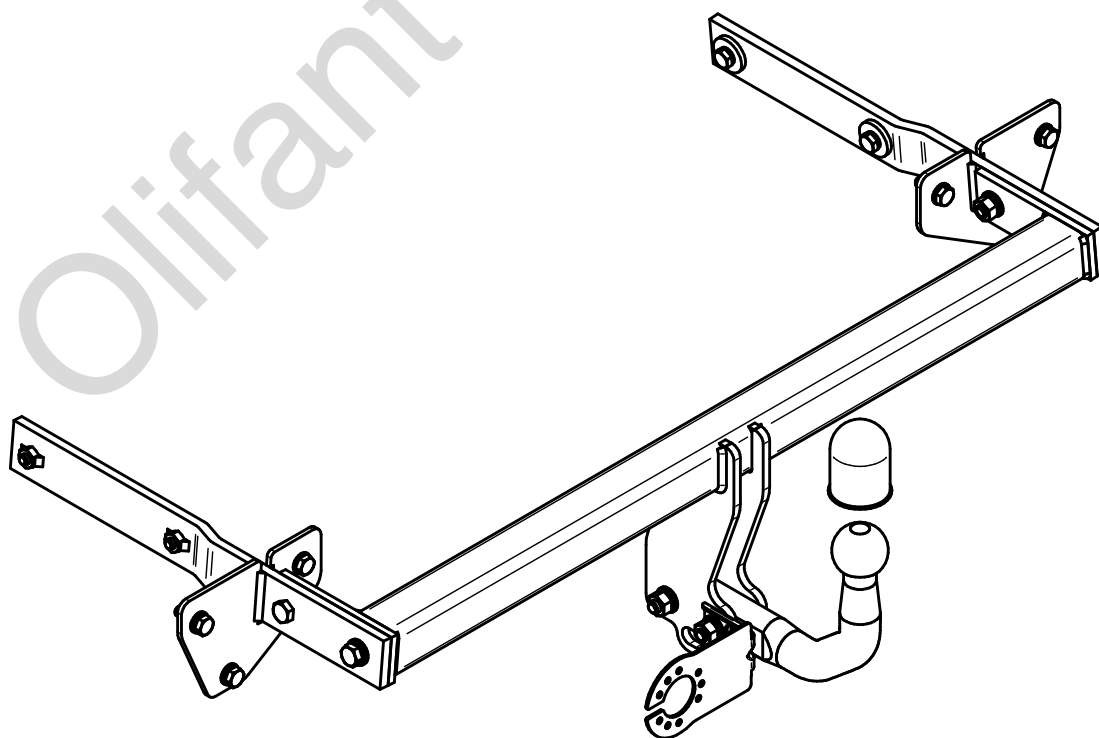

Typ: M-098
 A50-X
 (E20) 55R-01 3218
 D = 8,65kN
 S = 70kg

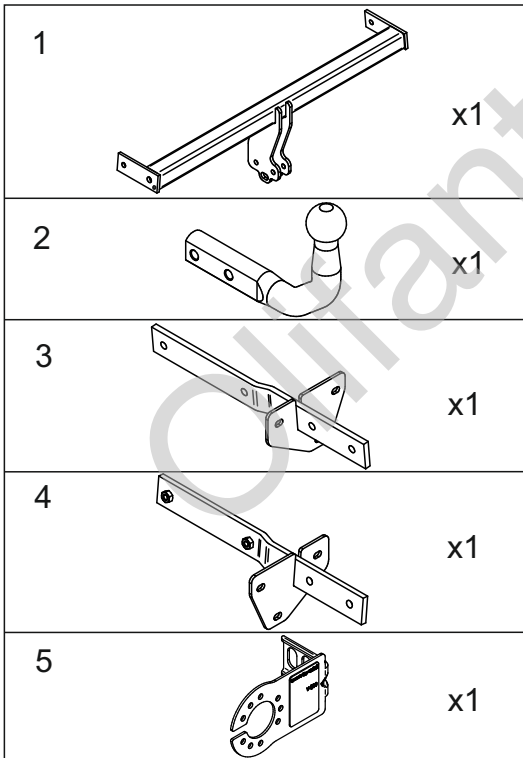
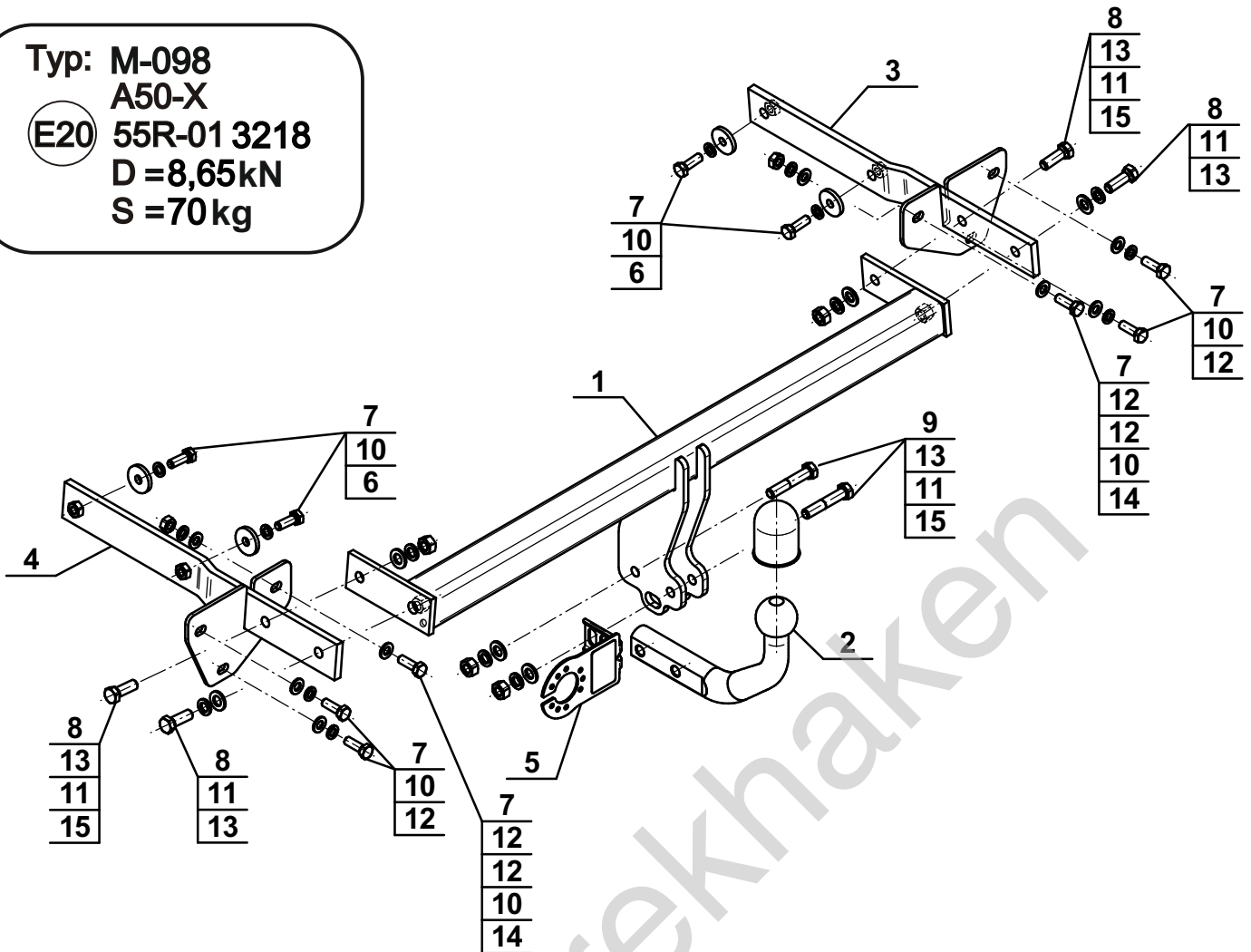

6		Ø35/Ø10,5x5	x4
7		M10x30 (PN/M-82105) (8.8)	x10
8		M12x35 (PN/M-82105) (8.8)	x4
9		M12x65 (PN/M-82101) (8.8)	x2
10		Ø10,2	x10
11		Ø12,2	x6
12		Ø10,5	x8
13		Ø13,0	x6
14		M10 (8)	x2
15		M12 (8)	x4



8.8	
M6 - 10 (Nm)	M12 - 85 (Nm)
M8 - 25 (Nm)	M14 - 135 (Nm)
M10 - 50 (Nm)	M16 - 200 (Nm)

1

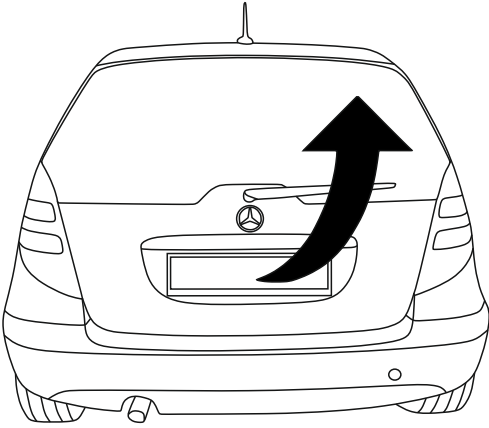

2

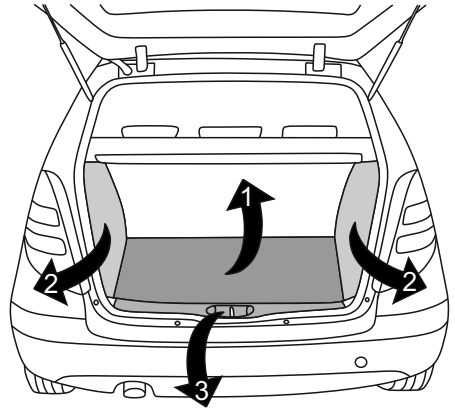

3

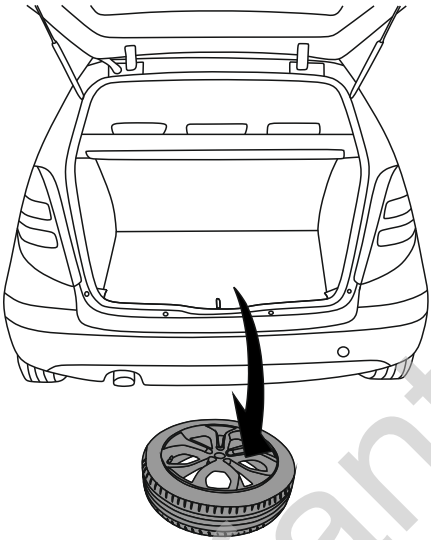

4

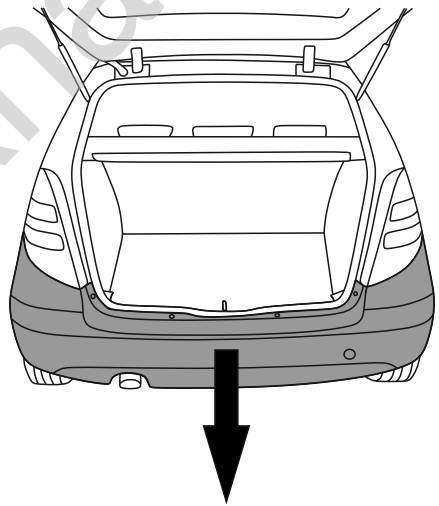

5

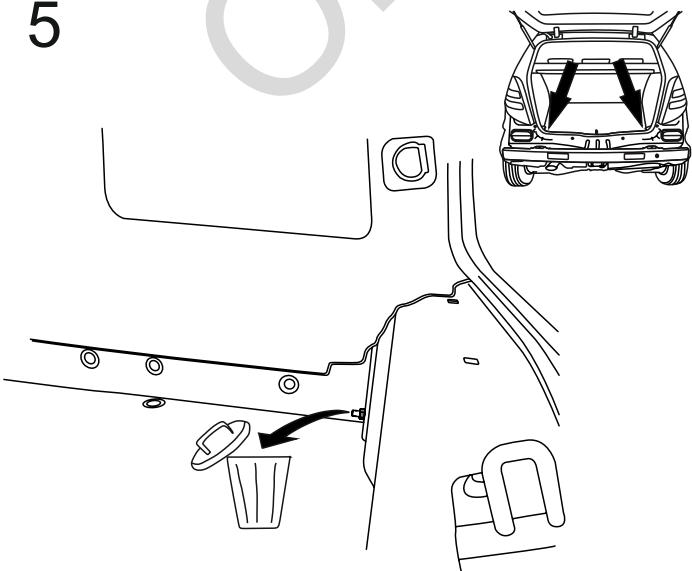

6

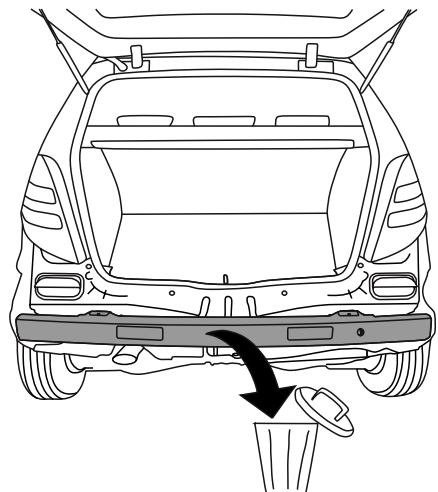

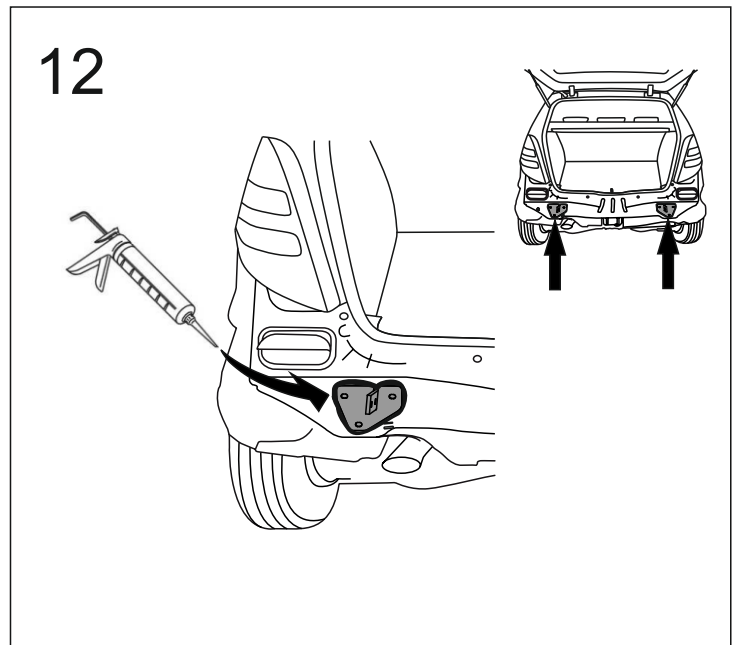
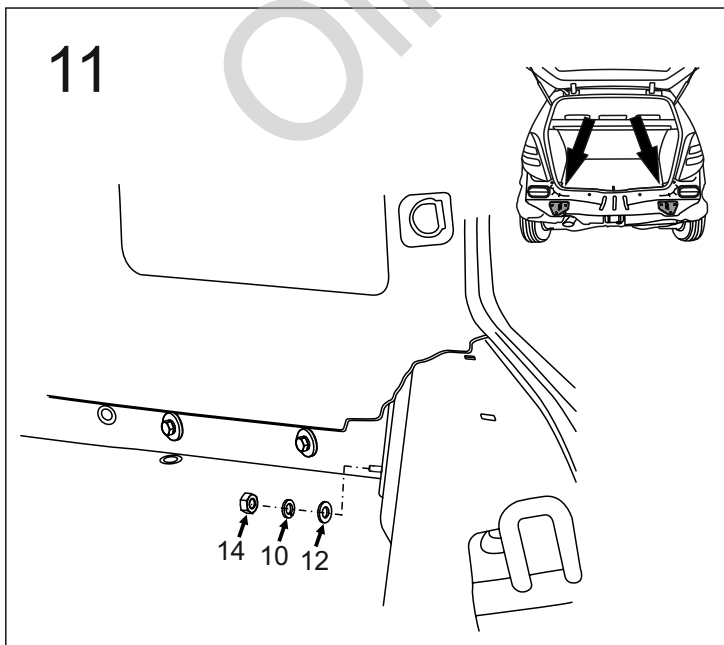
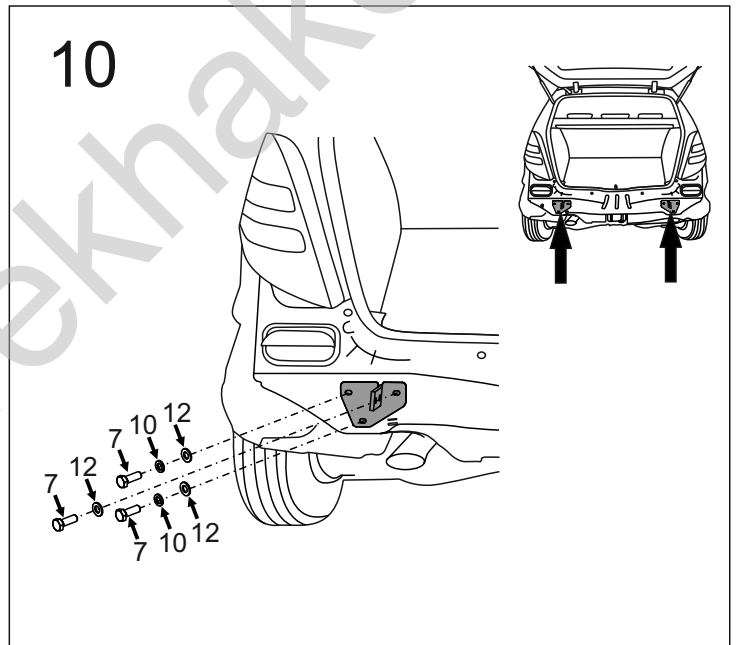
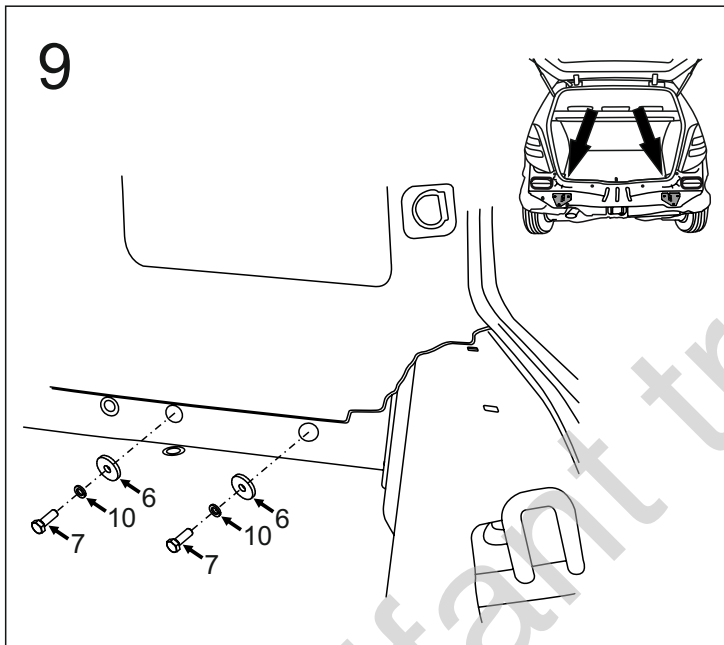
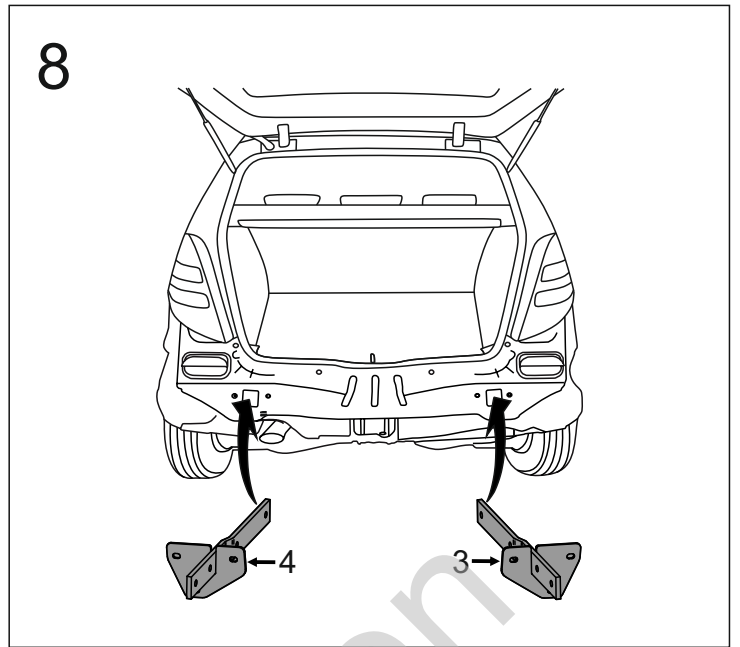
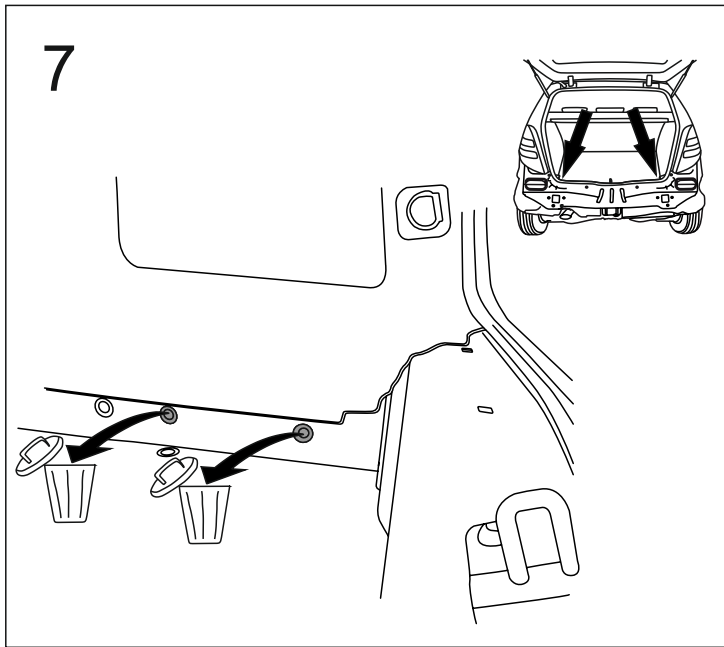

13

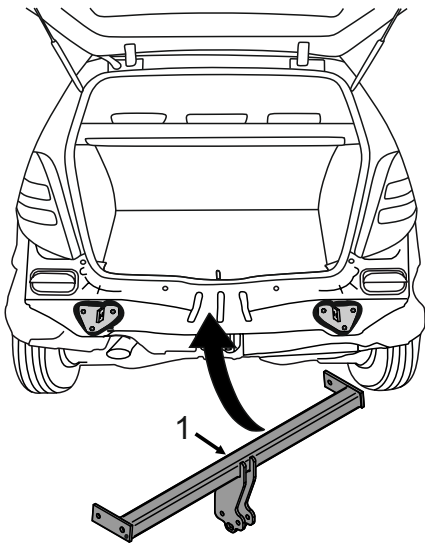

14

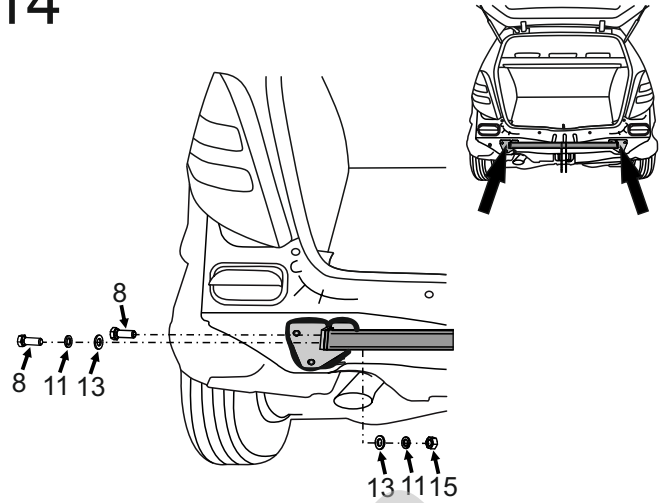

15

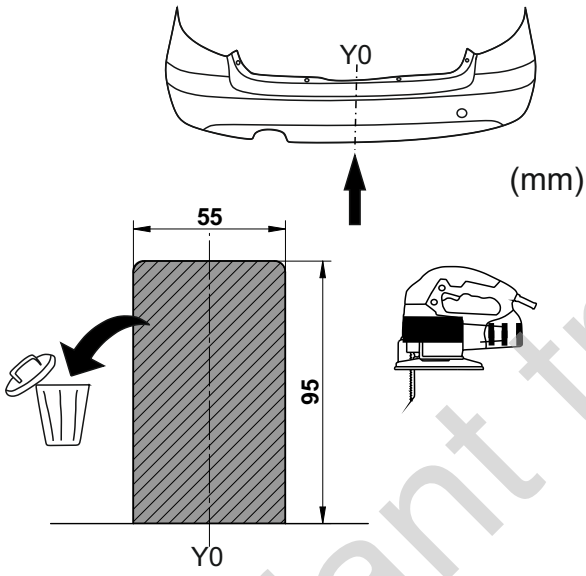

16

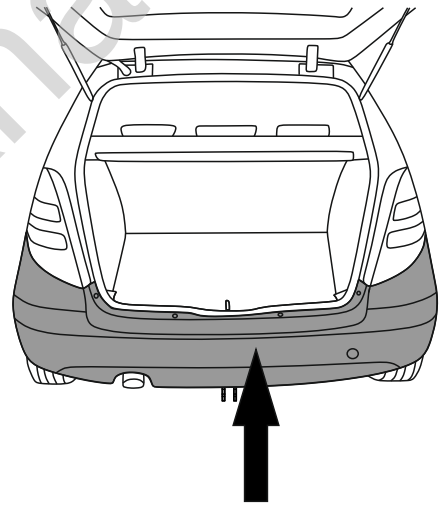

17

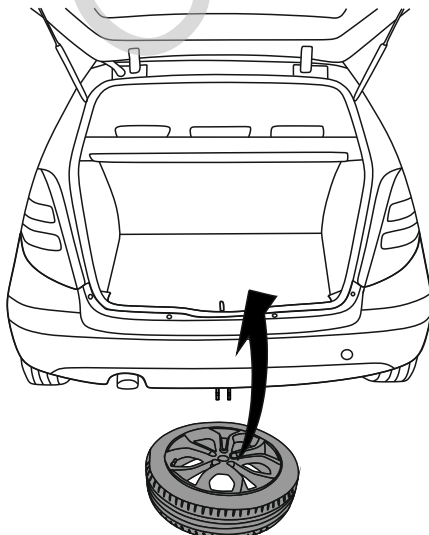

18

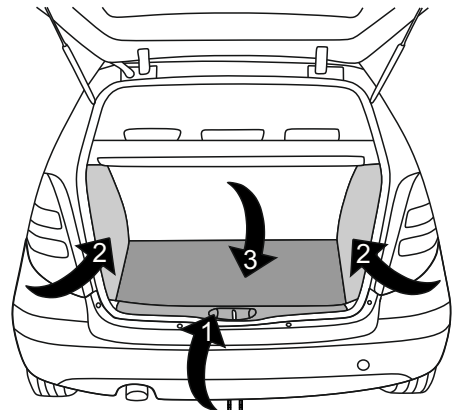

19

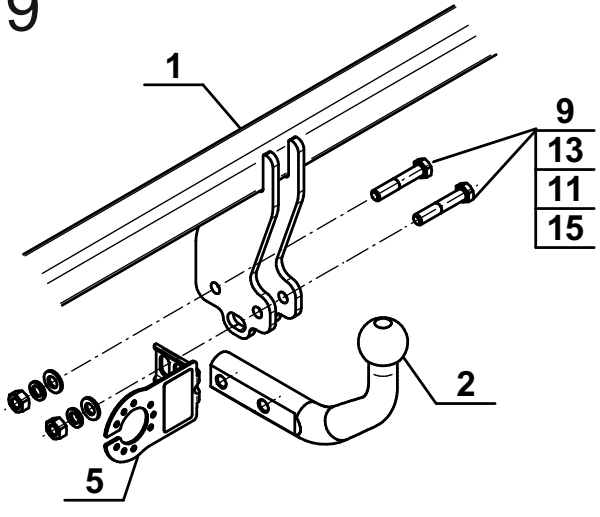

Olifant trekhaken