

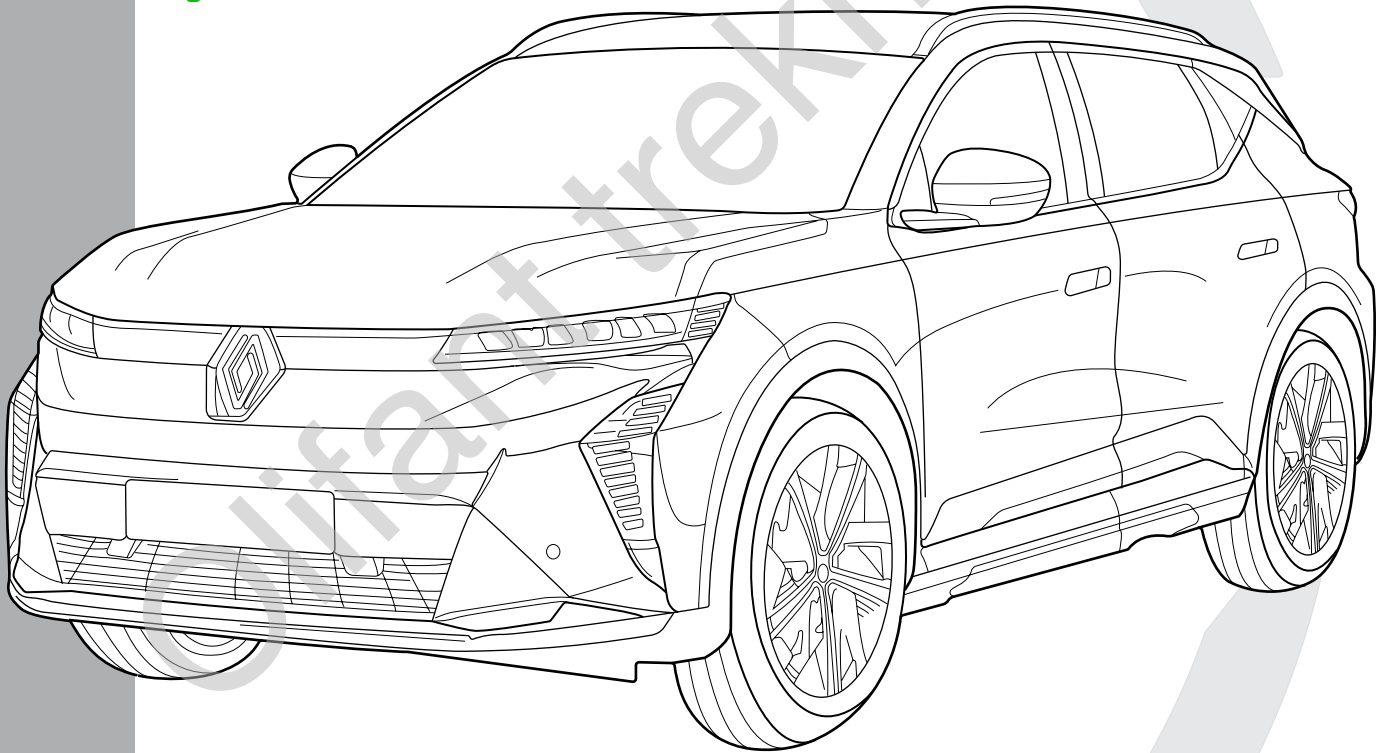

## Renault Scénic 11/'23-

- ✓ EVOLUTION
- ✓ TECHNO
- ✓ ESPRIT ALPINE
- ✓ ICONIC

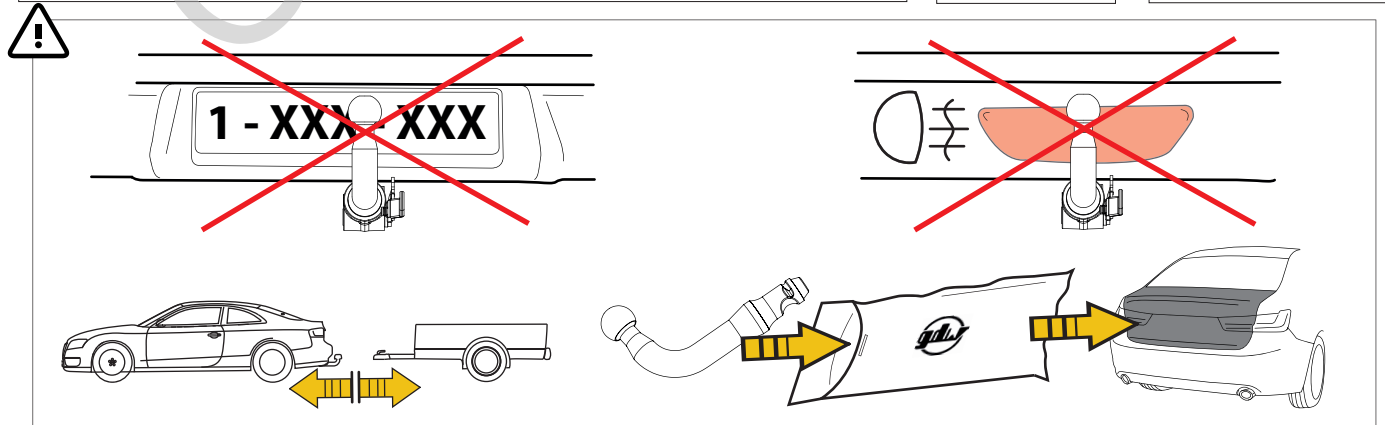

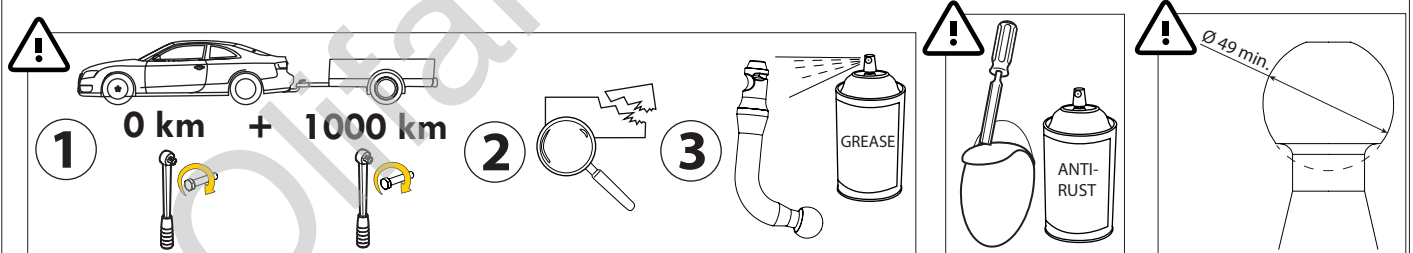
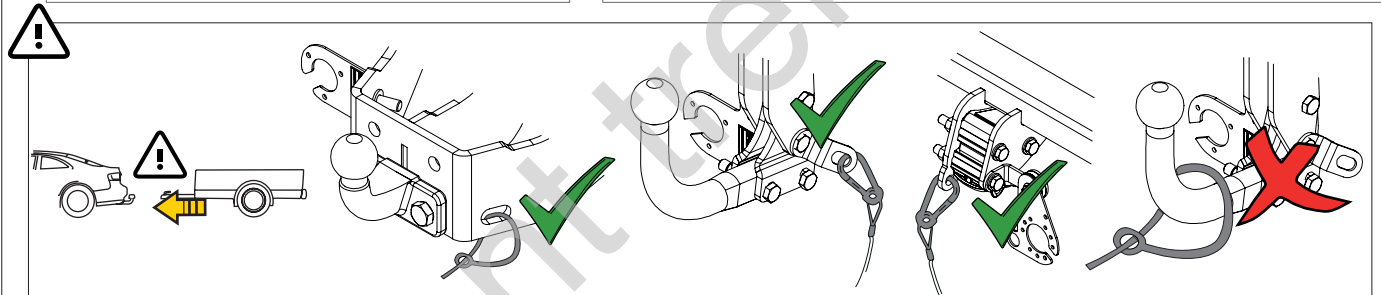
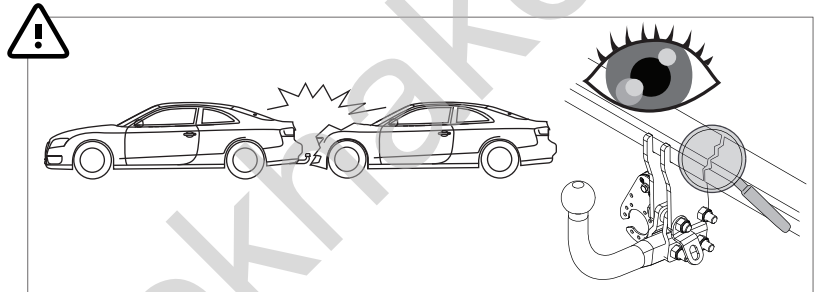
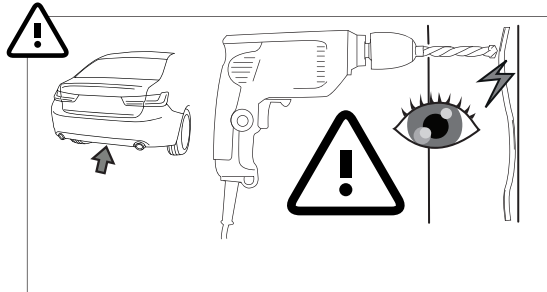
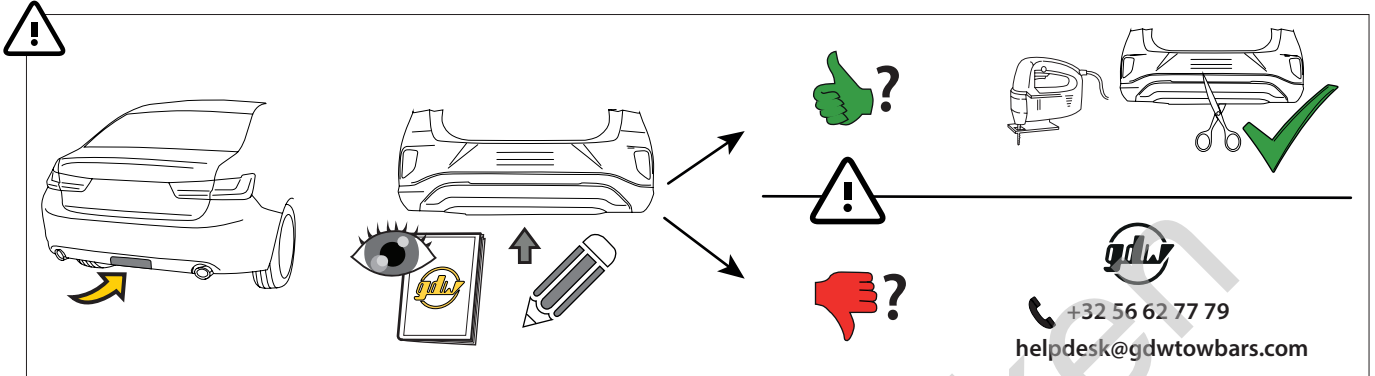
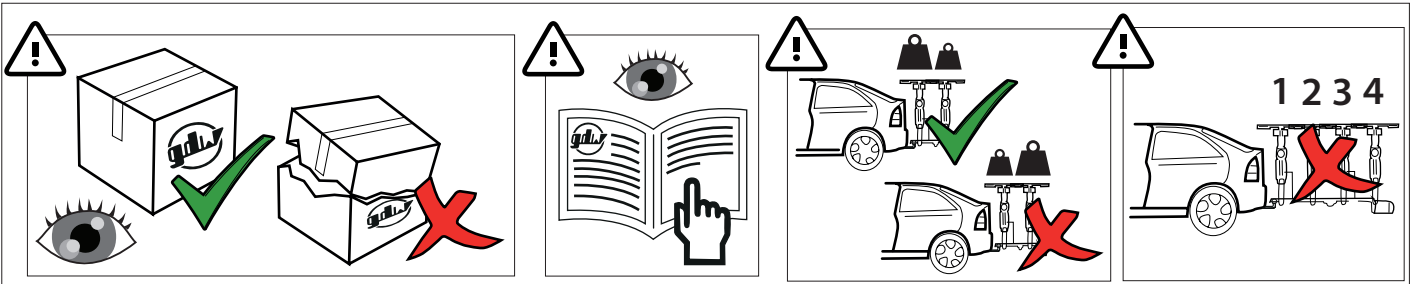

MADE BY



**D 8,00**

**F**

EC-N°

**E6**

BELGIUM

**S 95**

55R-02 1834

REF N°

2842T60

SERIAL N°

XXXX

DESCRIPTION

Renault Scénic 11 /'23-



$$D = \frac{\text{max kg (car)} \times \text{max kg (trailer)}}{\text{max kg (car)} + \text{max kg (trailer)}} \times 0.00981 \leq 8,00 \text{ kN}$$

$$S = \text{max kg (hook)} \leq 95 \text{ kg} \quad \text{max kg (trailer)} \leq 1200 \text{ kg}$$

S =

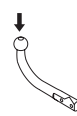

≤ 95 kg

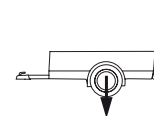

≤ 1200 kg



See the Certificate Of Conformity (COC) of your vehicle or contact your dealer to verify the max. trailer weight of your car!



See the user manual of the vehicle for correct use of bicycle carriers!

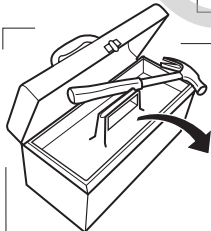
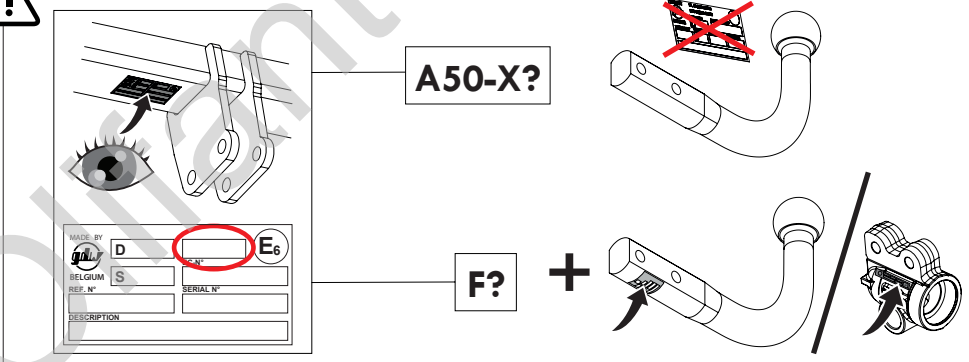
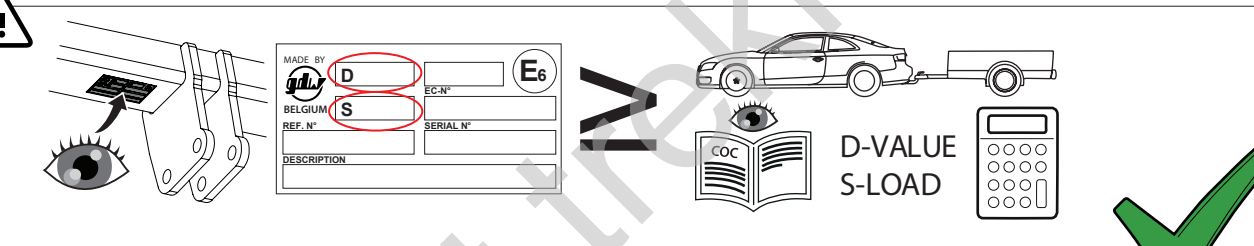
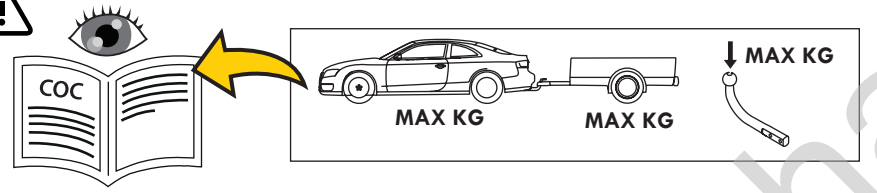

8

10

19

TX20

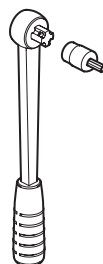
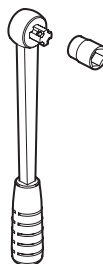
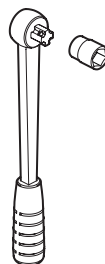
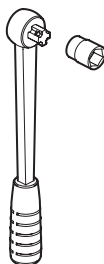

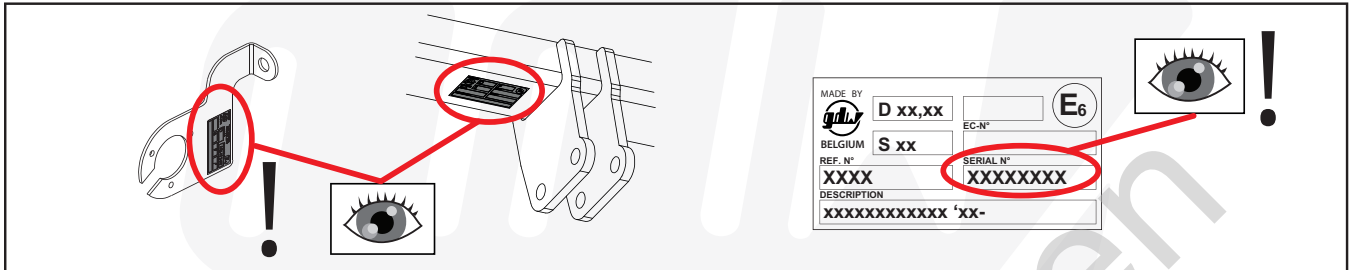





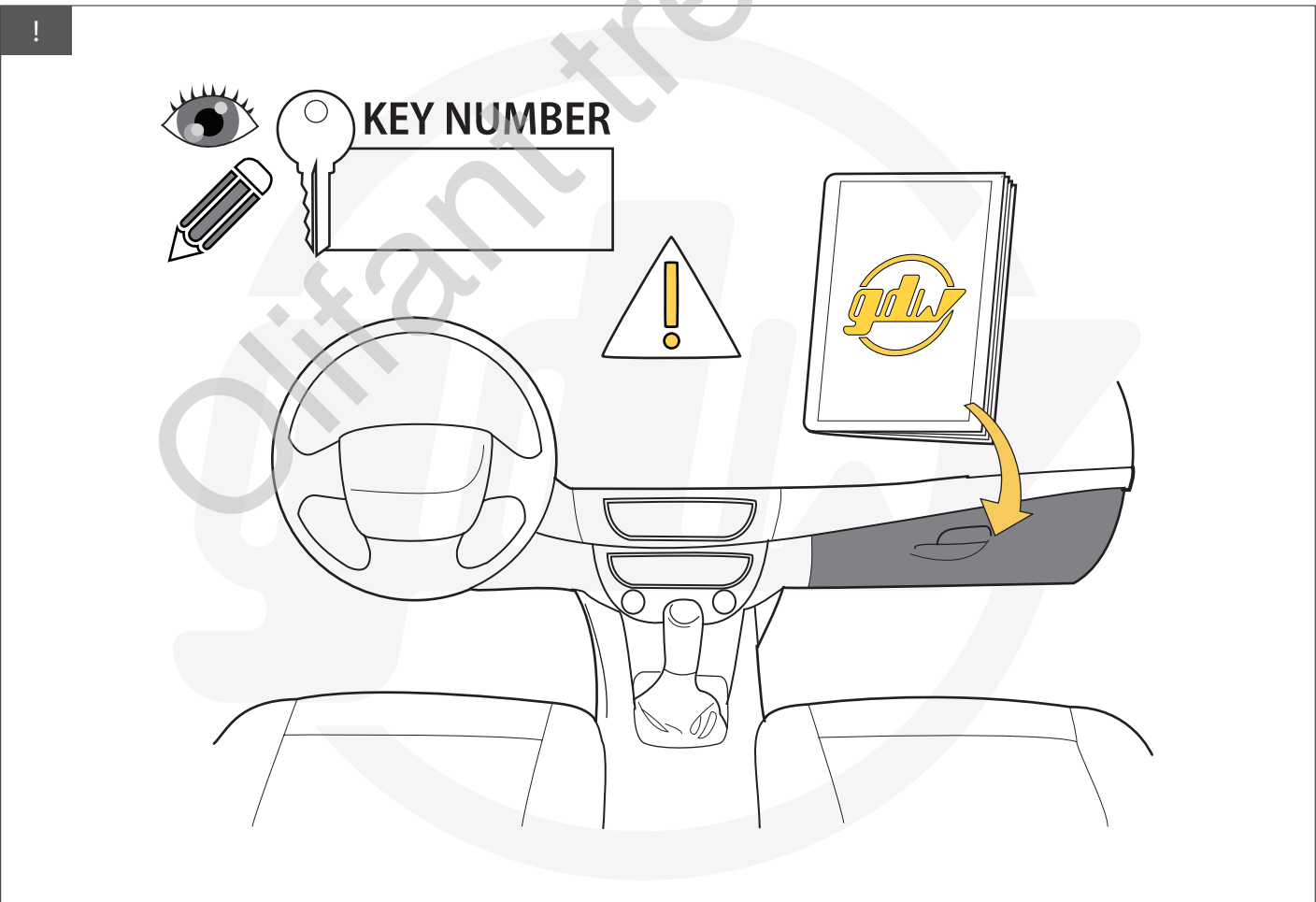

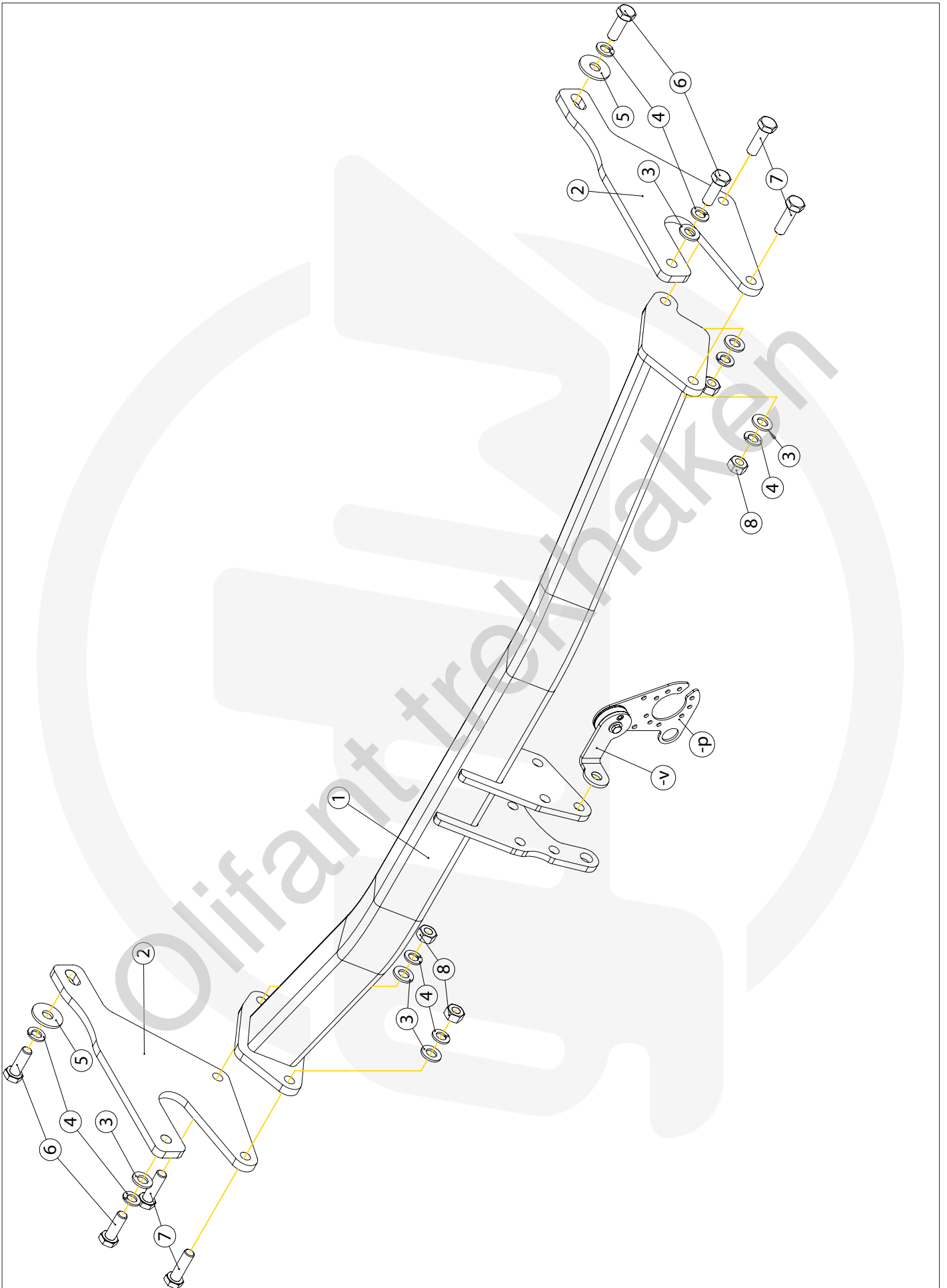

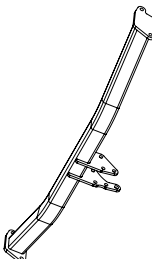
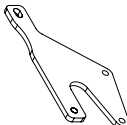





**helpdesk@gdwtowbars.com**  
**+32 56 62 77 79**



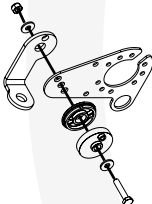
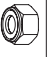



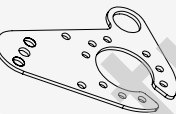

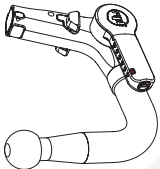

Monday	08:00 - 12:00	12:30 - 16:30
Tuesday	08:00 - 12:00	12:30 - 16:30
Wednesday	08:00 - 12:00	12:30 - 16:30
Thursday	08:00 - 12:00	12:30 - 16:30
Friday	08:00 - 12:00	12:30 - 15:30

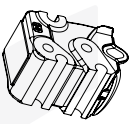

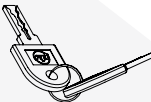

1		X1	GDW REF. 2842T60
2		X2	GDW REF. 2
3		X6	DIN 125A-13x24x2.5
4		X8	GROWER VSK-M12
5		X2	DIN 9021-13x37x3
6		X4	DIN 961-M12x35x1.25
7		X4	DIN 933-M12x40
8		X4	DIN 934-M12
-S		X1	GDW REF. 900.053
-V		X1	GDW REF. 908.101

-P		X1	GDW REF. P46
↑		X1	DIN985-M6
↑		X2	6,2 X 15,4 X 1,6 (NYLON)
↑		X1	GDW REF. 718.16.002
↑		X1	GDW REF. 718.16.003
↑		X1	GDW REF. 908.094
↑		X1	DIN933-M6 X 30
↑		X1	GDW REF. 908.101

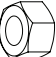
Geleverd met - Livré avec - Delivered with Geliiefert mit - Elementos adjuntos-Leveres med		X1	GDW REF. 960.V0810	
	↑		X1	GDW REF. 740.200
	↑		X1	GDW REF. 912.003
	↑		X1	GDW REF. 740.112
	↑		X1	GDW REF. 740.111
	↑		X1	GDW REF. 740.12X X= LAST NUMBER ON KEY
	↑		X1	GDW REF. 718.15.001
	↑		X1	GDW REF. SYST60-10
	↑		X3	DIN931-M12x110-8.8
	↑		X3	DIN128A-M12
	↑		X6	DIN125A-M12
	↑		X3	DIN934-M12

1

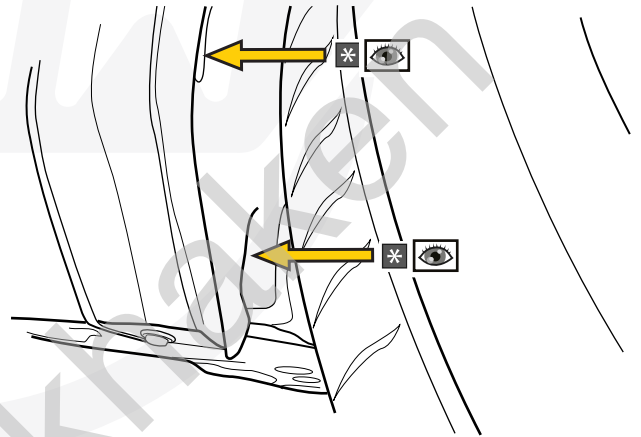
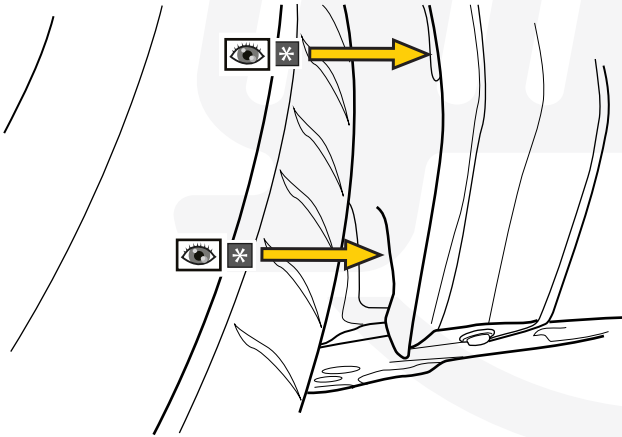
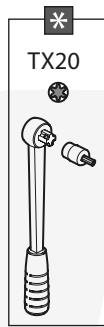
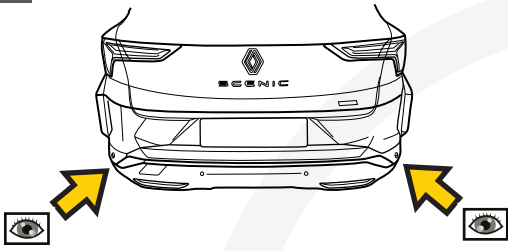

2

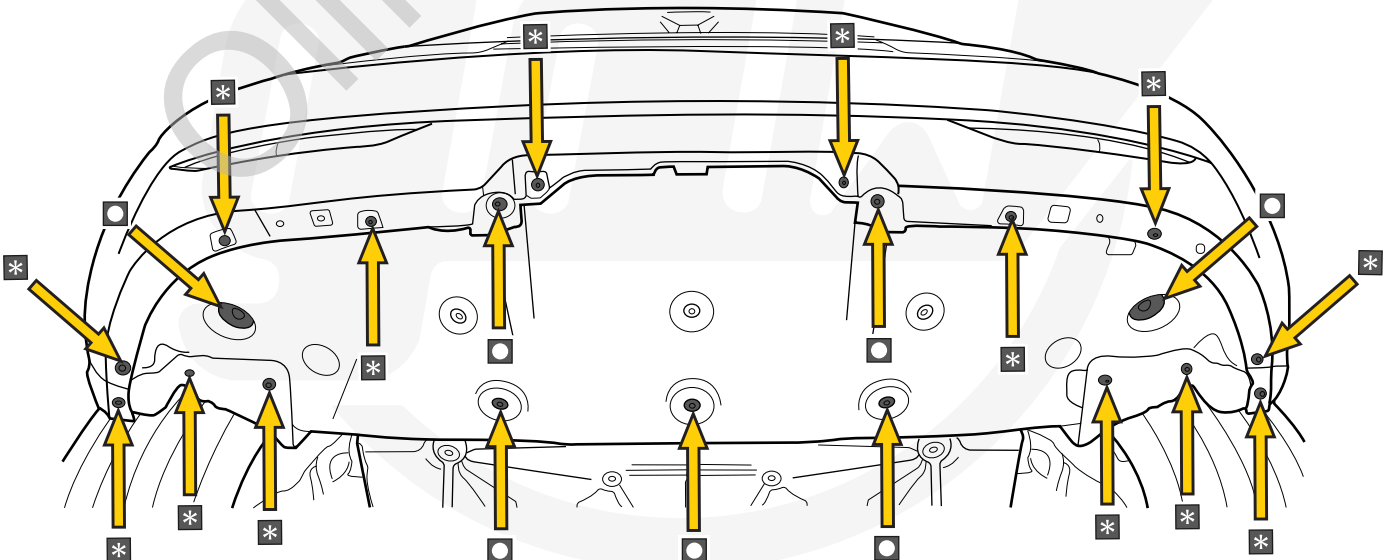
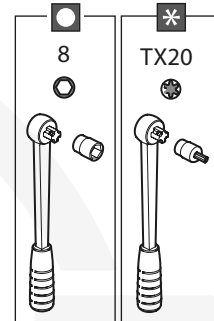
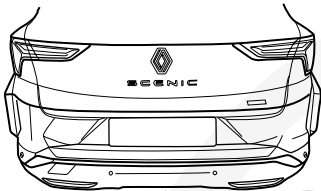

3

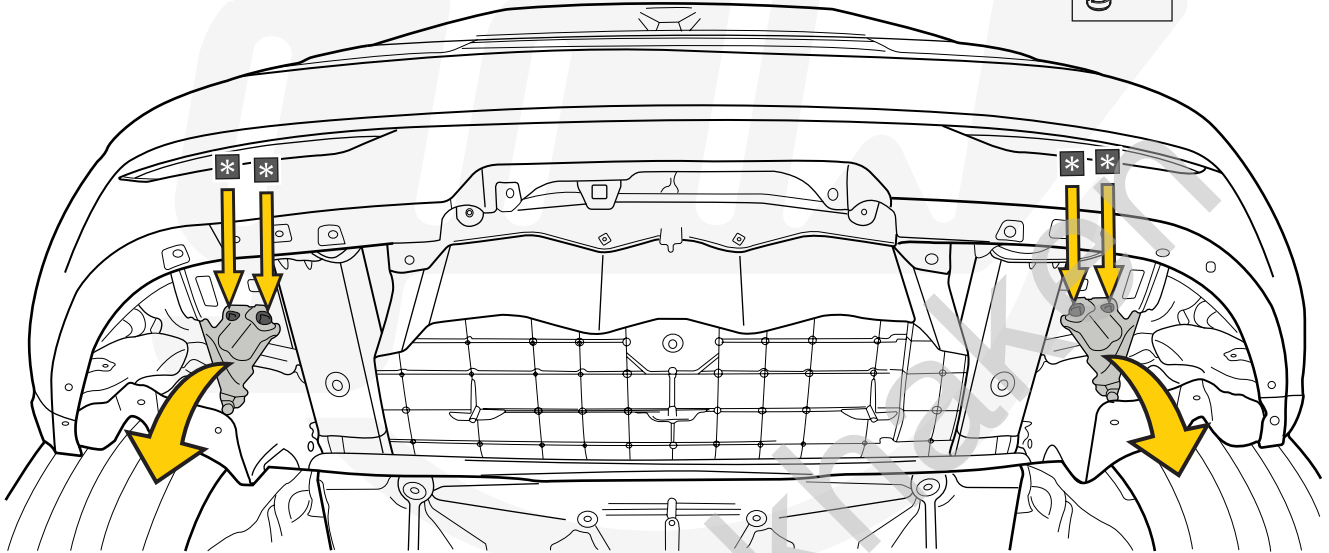
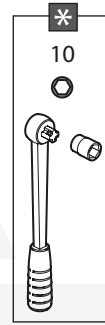
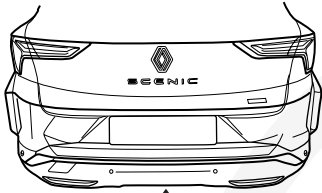

4

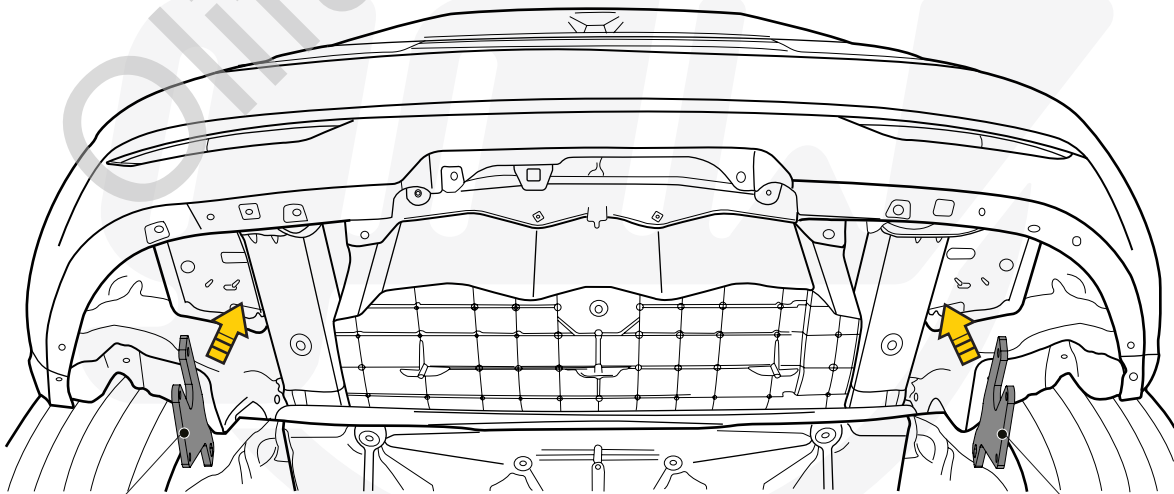
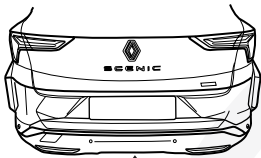



5

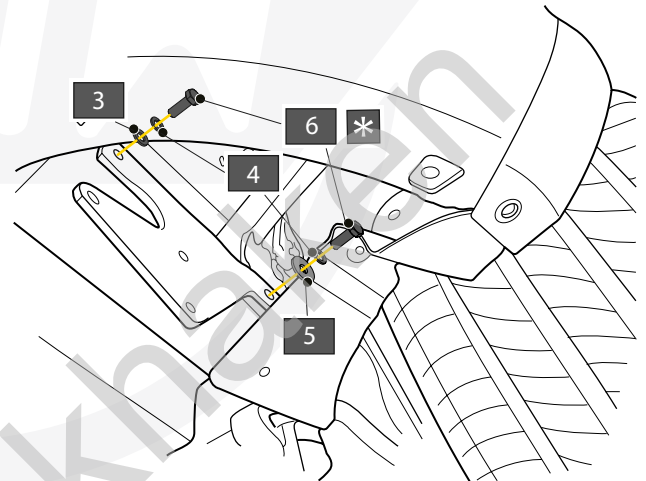
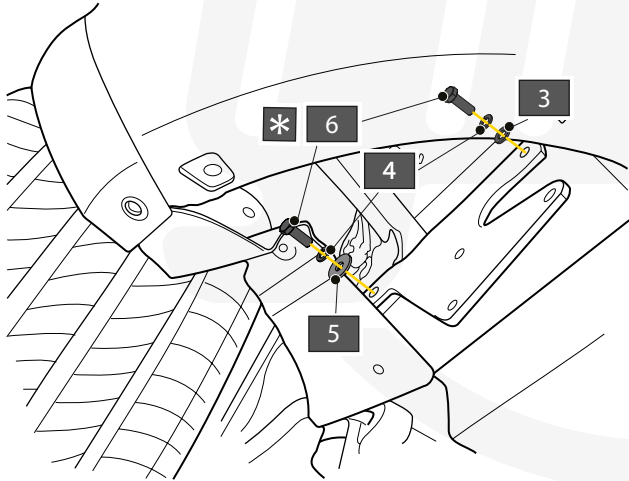
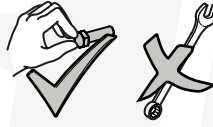
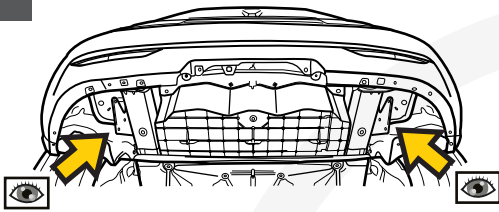

6

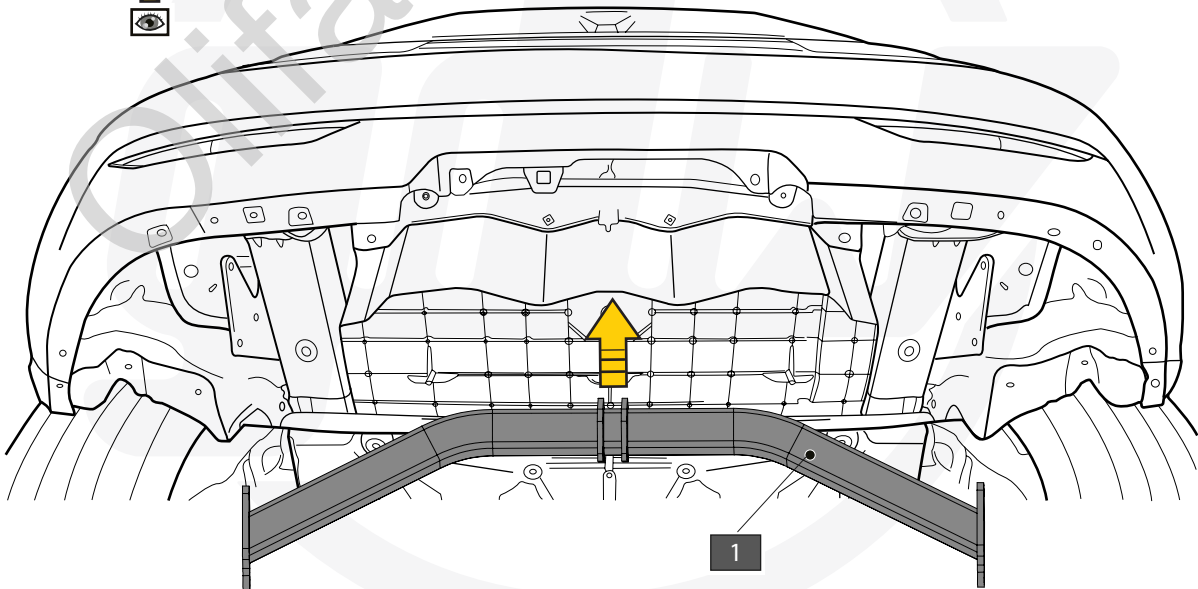
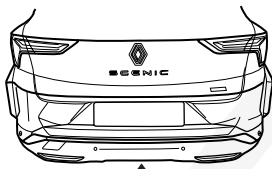

7

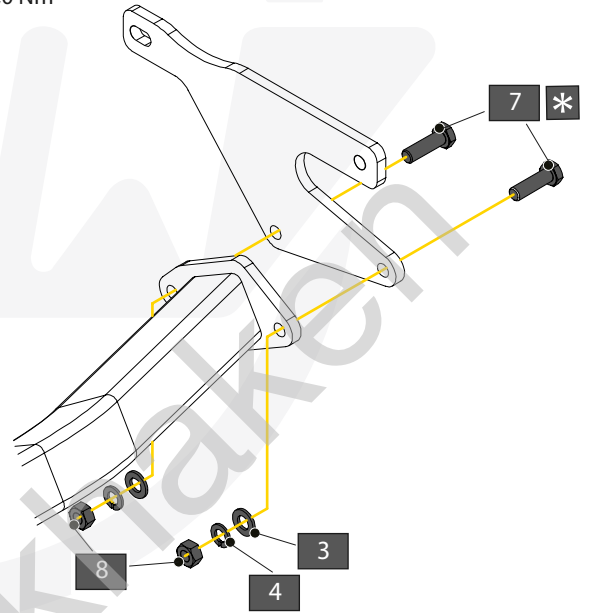
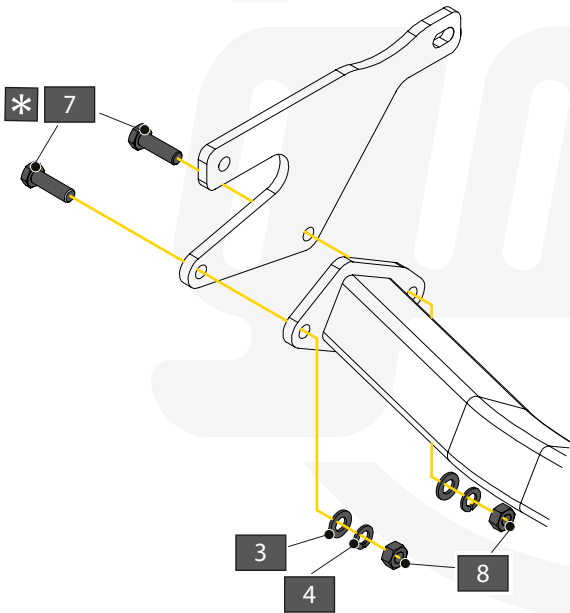
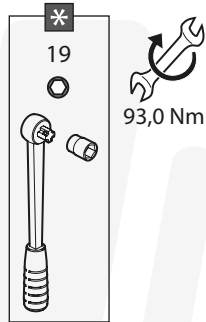
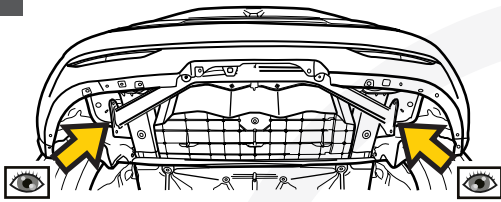

8

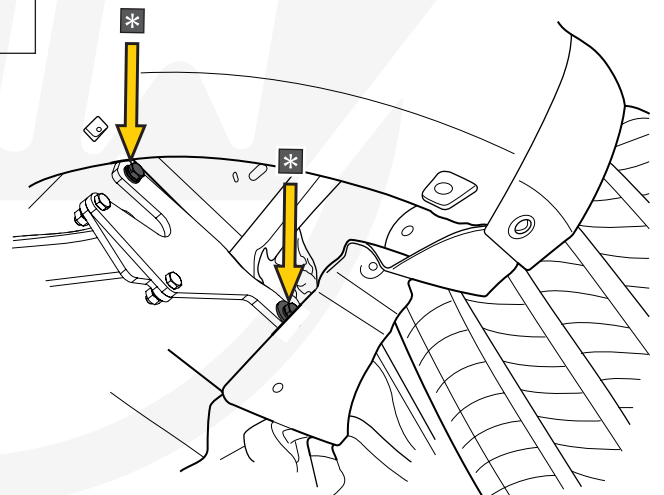
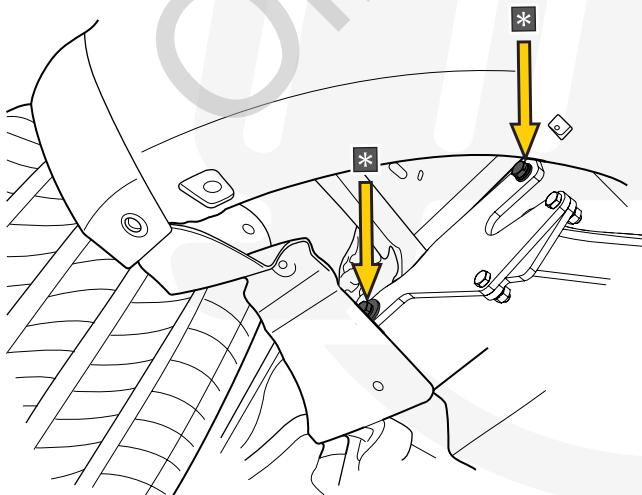
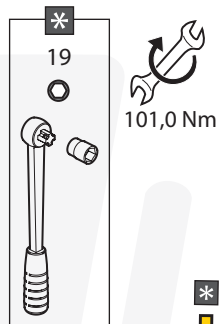
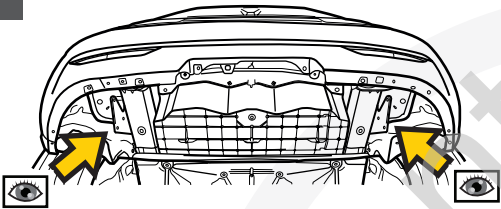

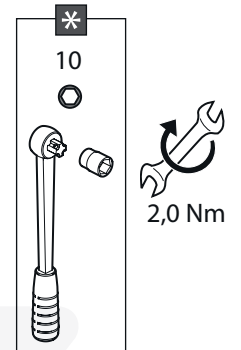
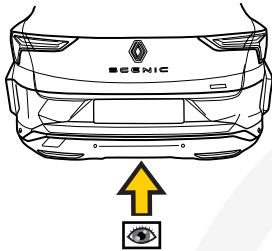
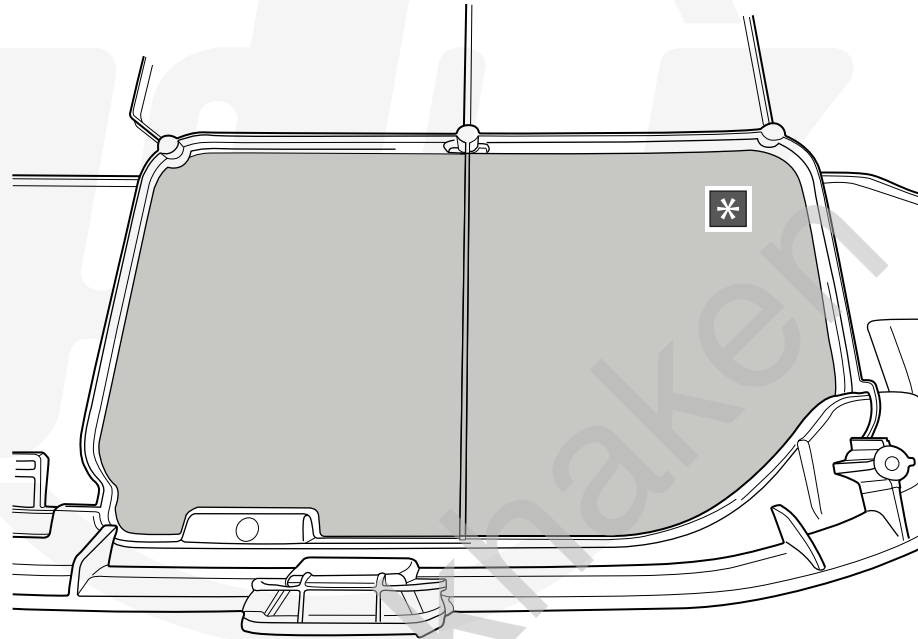
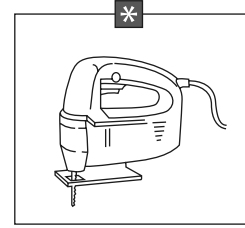
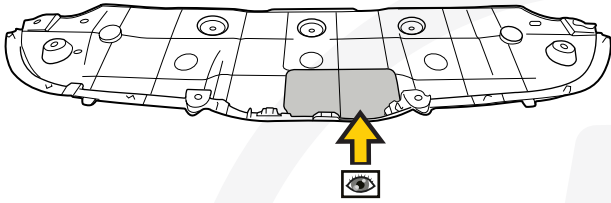

A		X1	GDW REF. 908.101
B		X1	DIN985-M6
C		X2	6,2 X 15,4 X 1,6 (NYLON)
D		X1	GDW REF. 718.16.002
E		X1	GDW REF. 718.16.003
F		X1	GDW REF. 908.094
G		X1	DIN933-M6 X 30

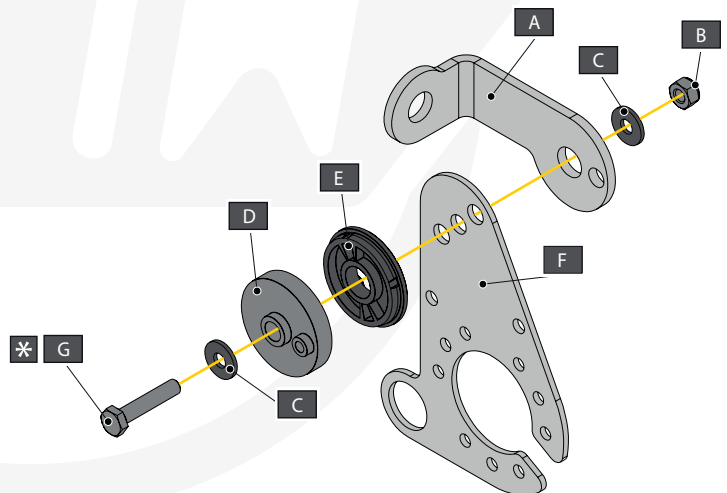

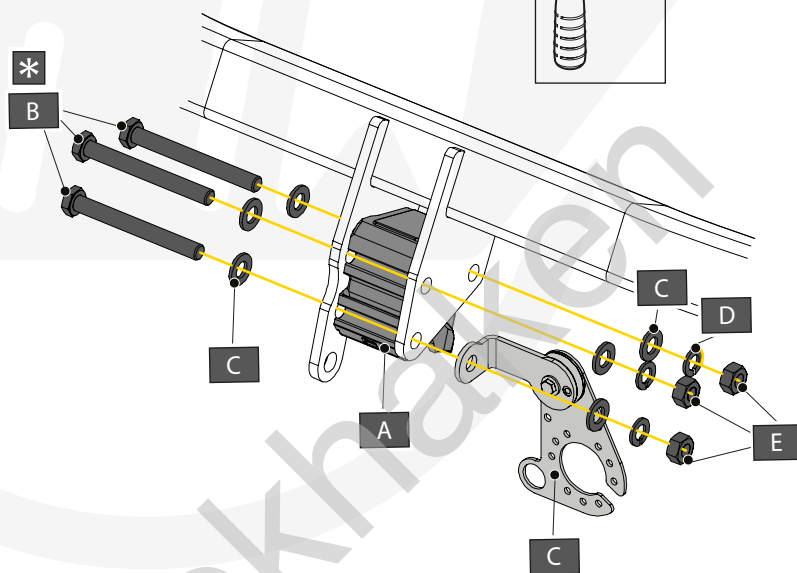
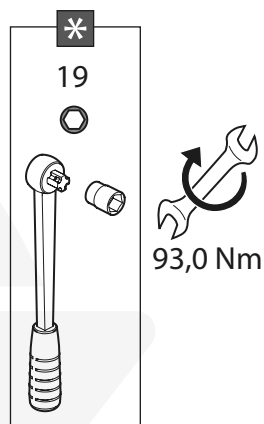
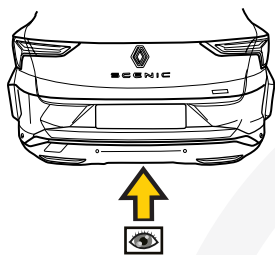

A		X1	GDW REF. 912.003
B		X3	DIN931-M12X110-8.8
C		X3	DIN125A-M12
D		X3	DIN128A-M12
E		X3	DIN934-M12

Olifant trekkers