

PPUH AUTO-HAK Sp.J.

Henryk i Zbigniew Nejman
ul. Słoneczna 16K 76-200 SŁUPSK
POLAND

tel/fax +48 59 8 414 414; +48 59 8 414 413

e-mail: office@autohak.com.pl

www.autohak.com.pl



AUTO-HAK



VOLVO C30
3D, + R-Line

Cat. no:

L22A



10.2006 → 12.2012

e20

e20*94/20*1390*00

D

8,9 kN



2h



R=1600 kg



S=100 kg



11,8 kg

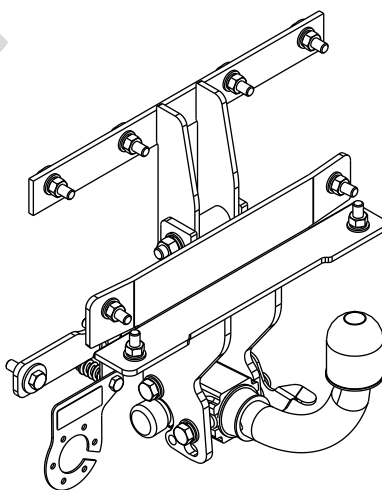

M6 - 11 Nm
M10 - 50 Nm
M14 - 138 Nm

M8 - 25 Nm
M12 - 87 Nm
M16 - 210 Nm









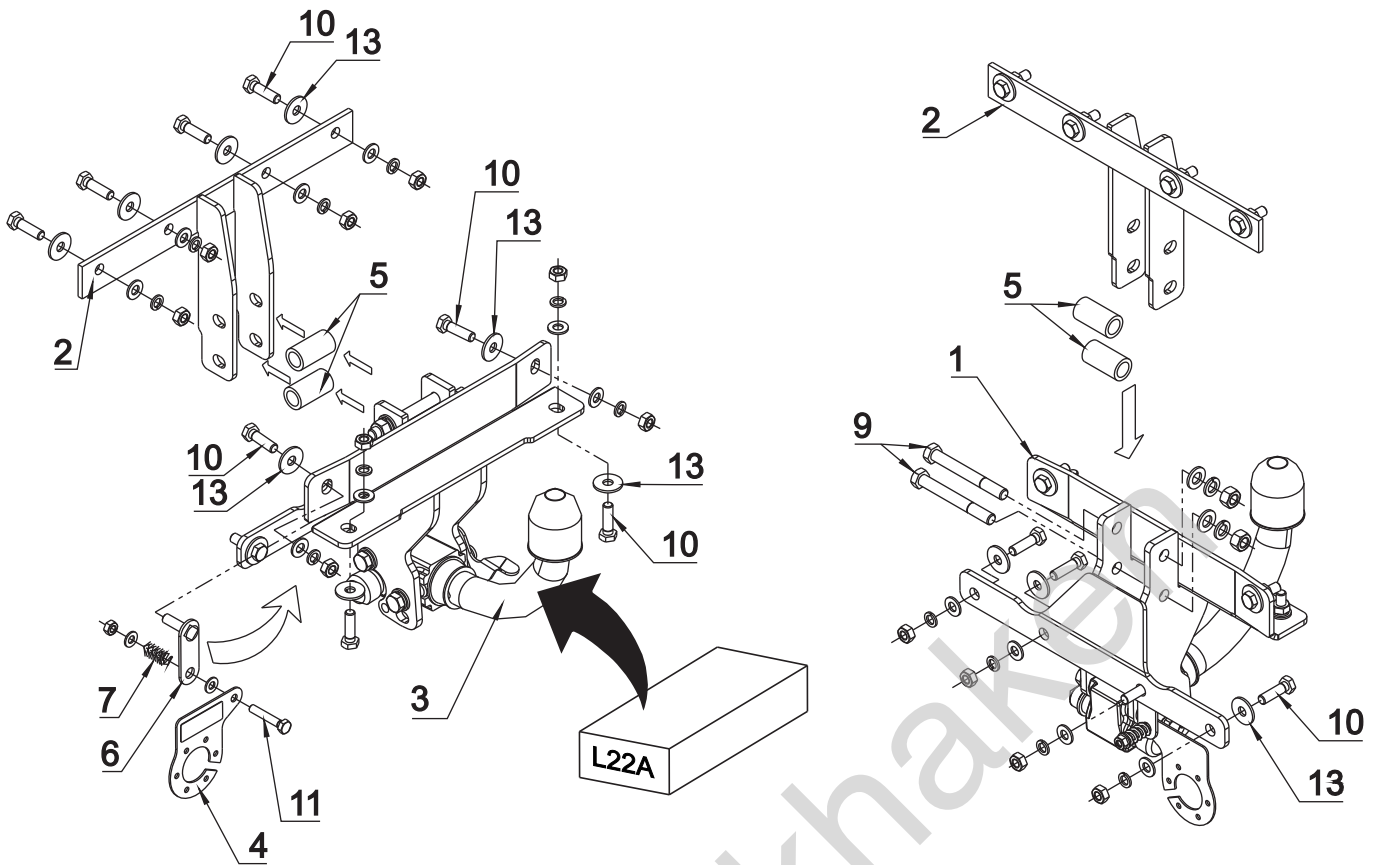

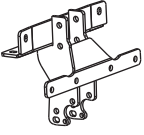

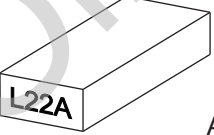

0 km →

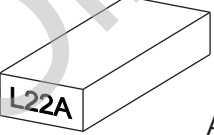

1000 km

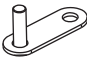

1		x 1		9 M12x100	x 2
2		x 1		10 M10x35	x 11
				11 M8x45	x 1
2		x 1		12 \varnothing 13	x 2
				13 \varnothing 30x \varnothing 10.5x2.5 10 (DIN 9021)	x 11
				14 \varnothing 10.5	x 13
				15 \varnothing 8.5	x 2
				16 \varnothing 12.2	x 2
				17 \varnothing 10.2	x 12
2		x 1		18 M12	x 2
				19 M10	x 12
				20 M8	x 1
4		x 1		Art.nr-KL1L22A	
				Art.nr-BL1L22A	
5		x 2		\varnothing 25x4mm L=46,5mm	
6		x 1			
7		x 1			
8		x 1			

