

# PPUH AUTO-HAK Sp.J.

Henryk i Zbigniew Nejman  
ul. Słoneczna 16K 76-200 SŁUPSK  
POLAND

tel/fax +48 59 8 414 414; +48 59 8 414 413

e-mail: [office@autohak.com.pl](mailto:office@autohak.com.pl)

[www.autohak.com.pl](http://www.autohak.com.pl)



# AUTO-HAK



**VOLVO XC60 (SUV)**

Cat. no:

**L21A**



10.2008 → 04.2012

05.2012 → 03.2018

**e20**

e20\*94/20\*1310\*00

**D**

11,0 kN



**2h**



R=2100 kg







S=90 kg

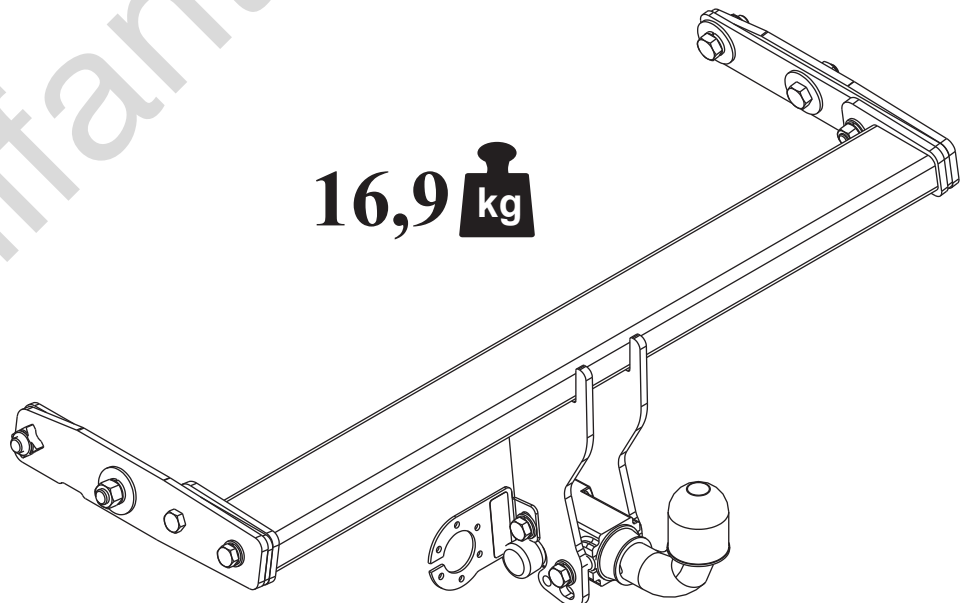

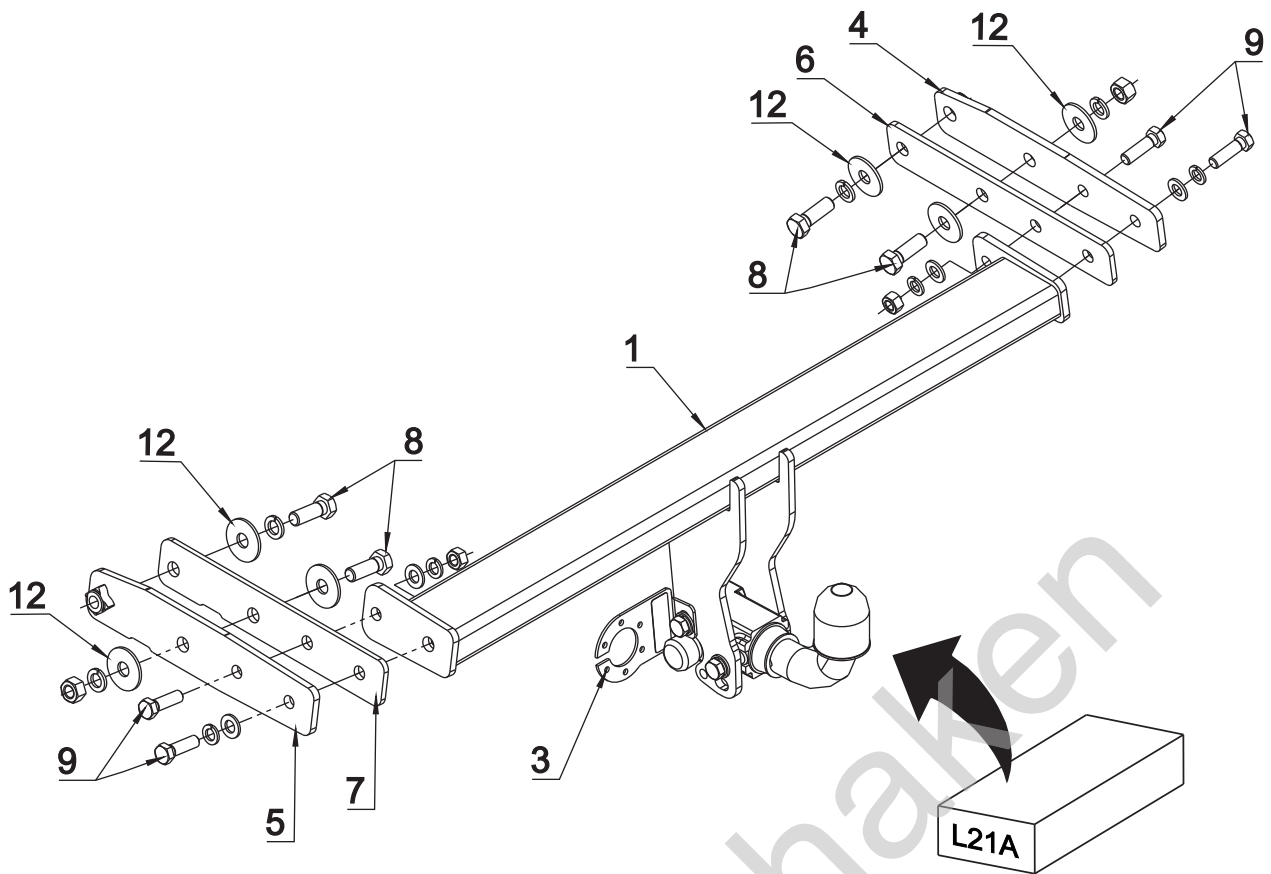
**16,9 kg**

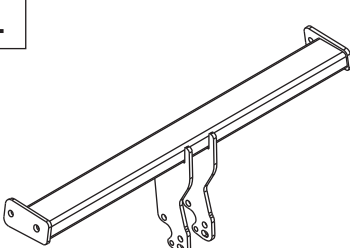

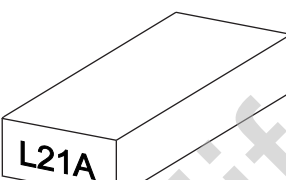
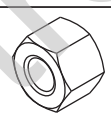
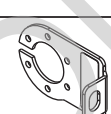

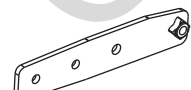
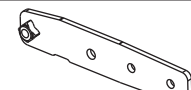
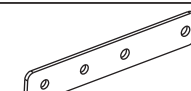
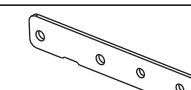
1		x1		8	M14x40	x4
				9	M12x40	x4
2	 Art.nr-KL1L21A	x1		10	M14	x2
				11	M12	x2
3	 Art.nr-BL1L21A	x1		12	$\varnothing 44 \times \varnothing 15 \times 3$ 15 – DIN 9021	x6
				13	$\varnothing 13$	x2
				14	$\varnothing 14.2$	x4
				15	$\varnothing 12.2$	x4
4		x1				
5		x1				
6		x1				
7		x1				

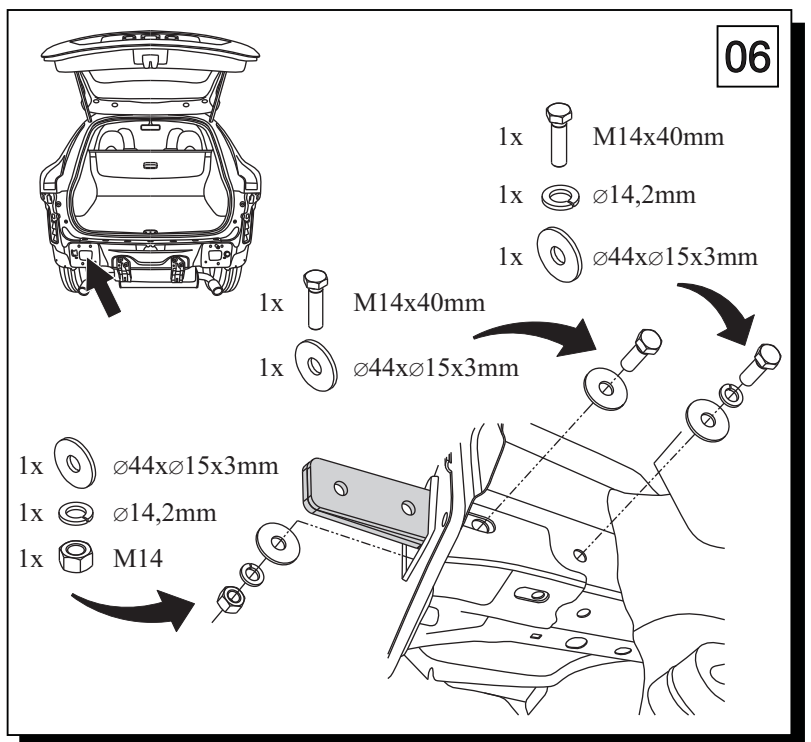
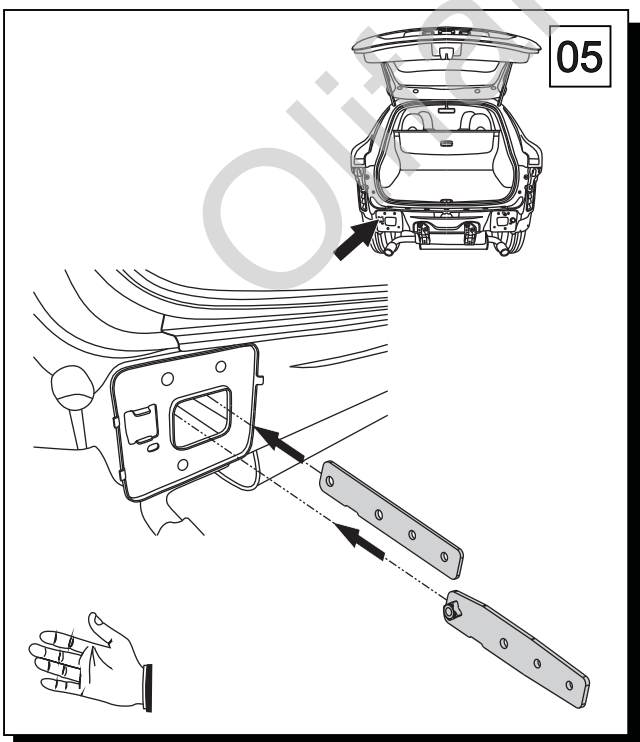
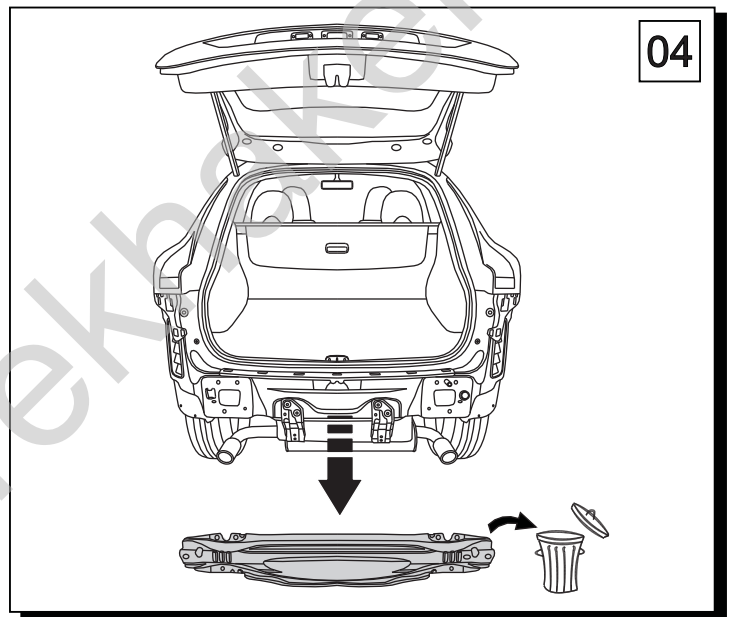
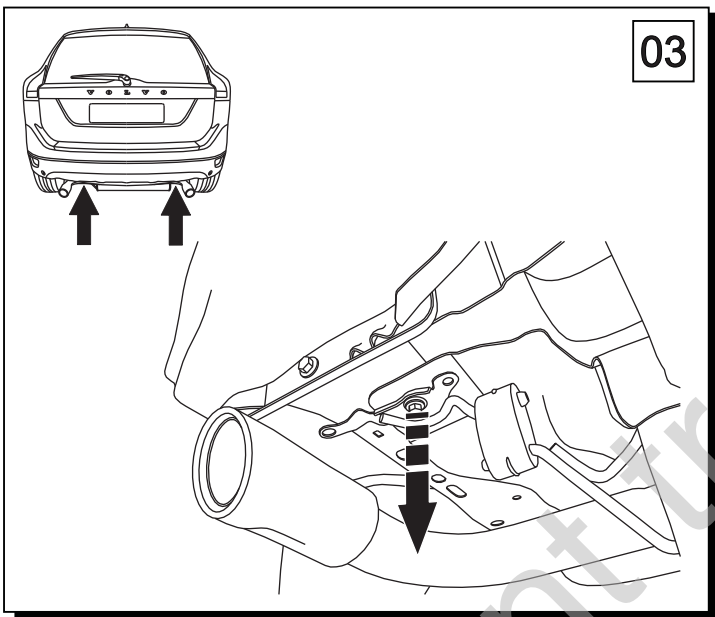
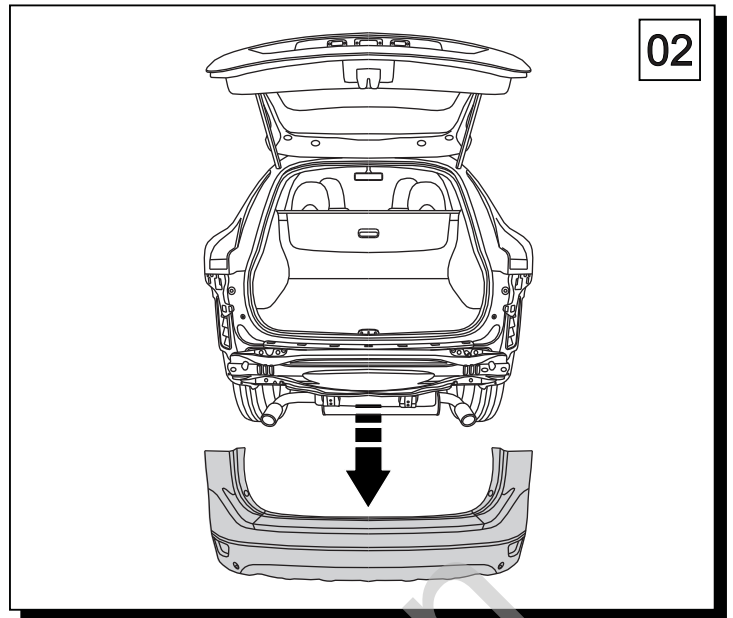
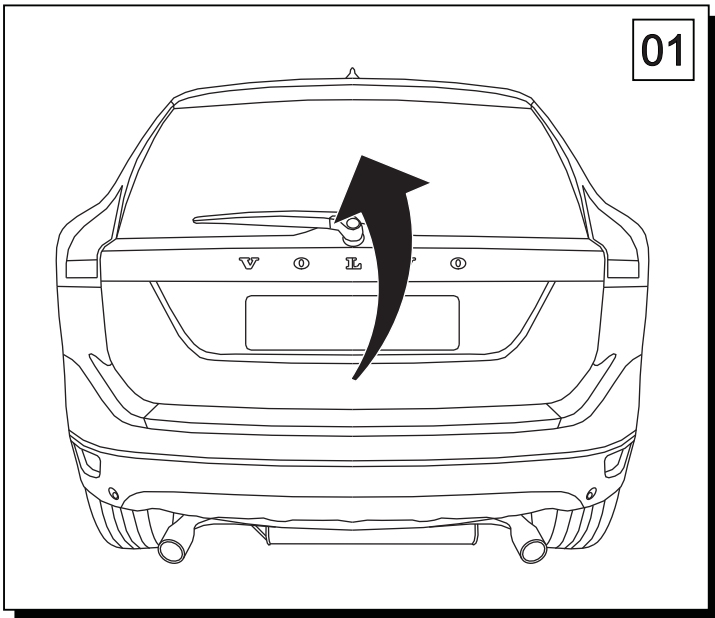

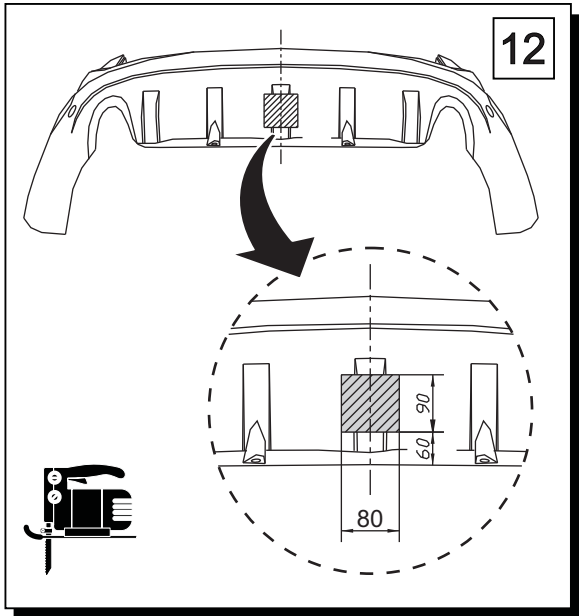
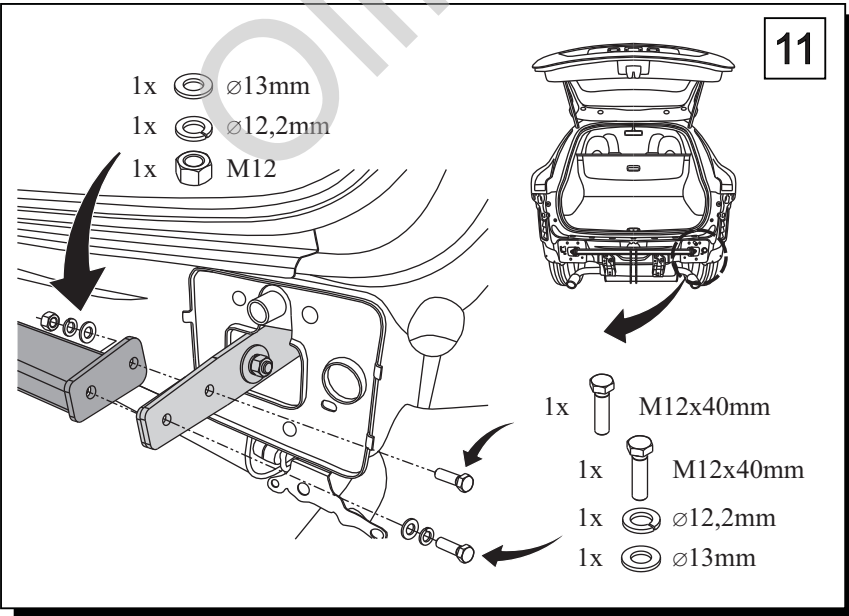
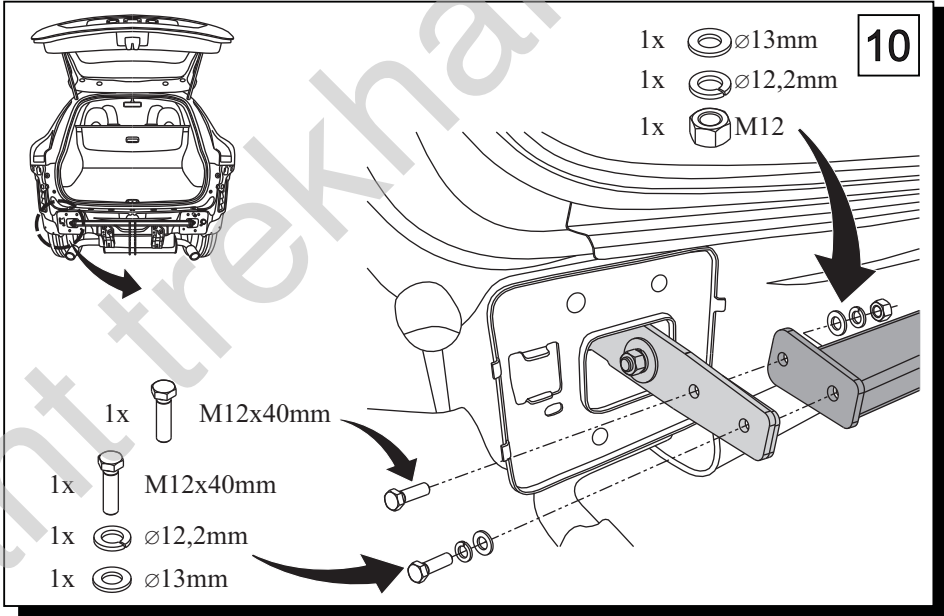
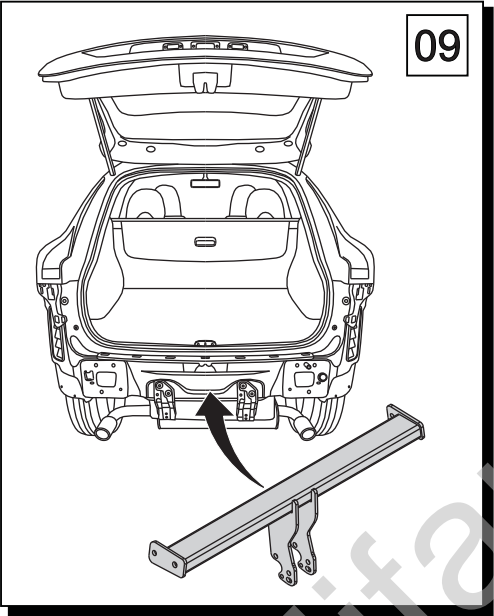
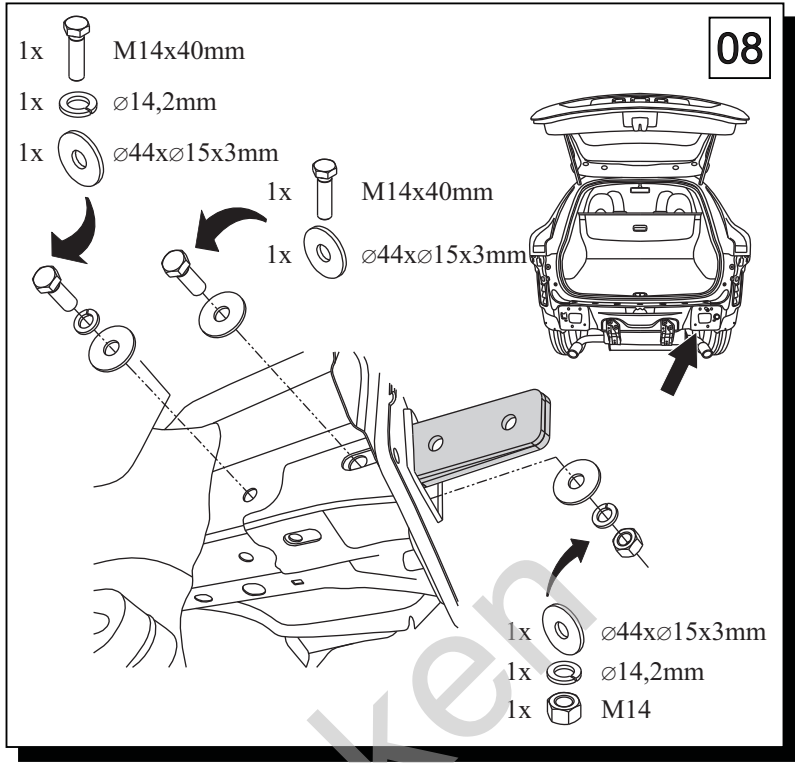
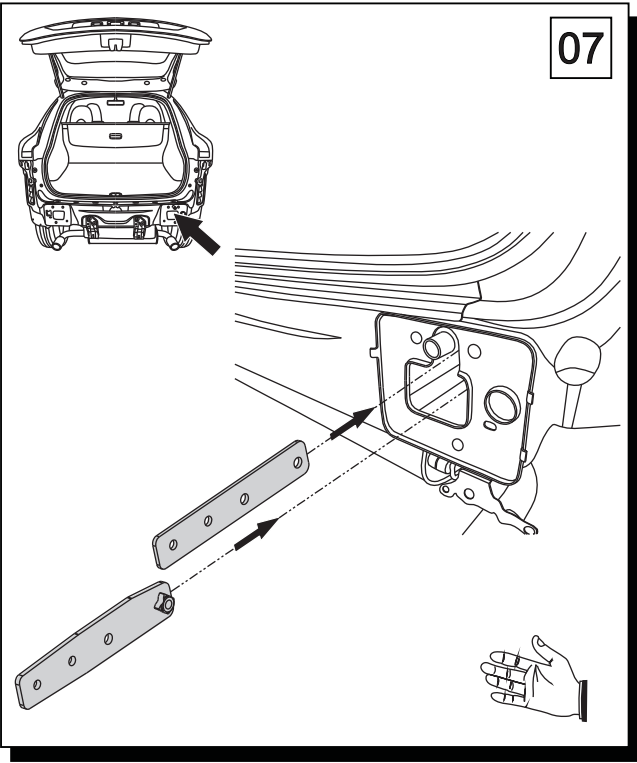

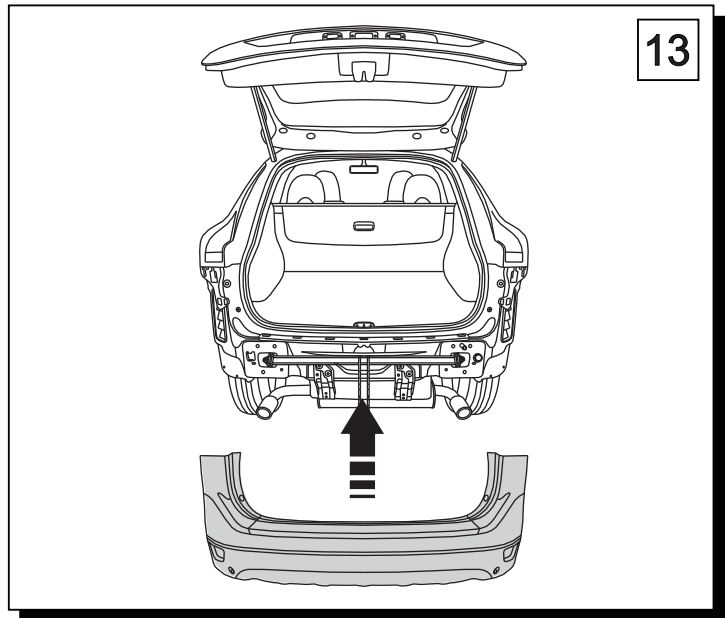

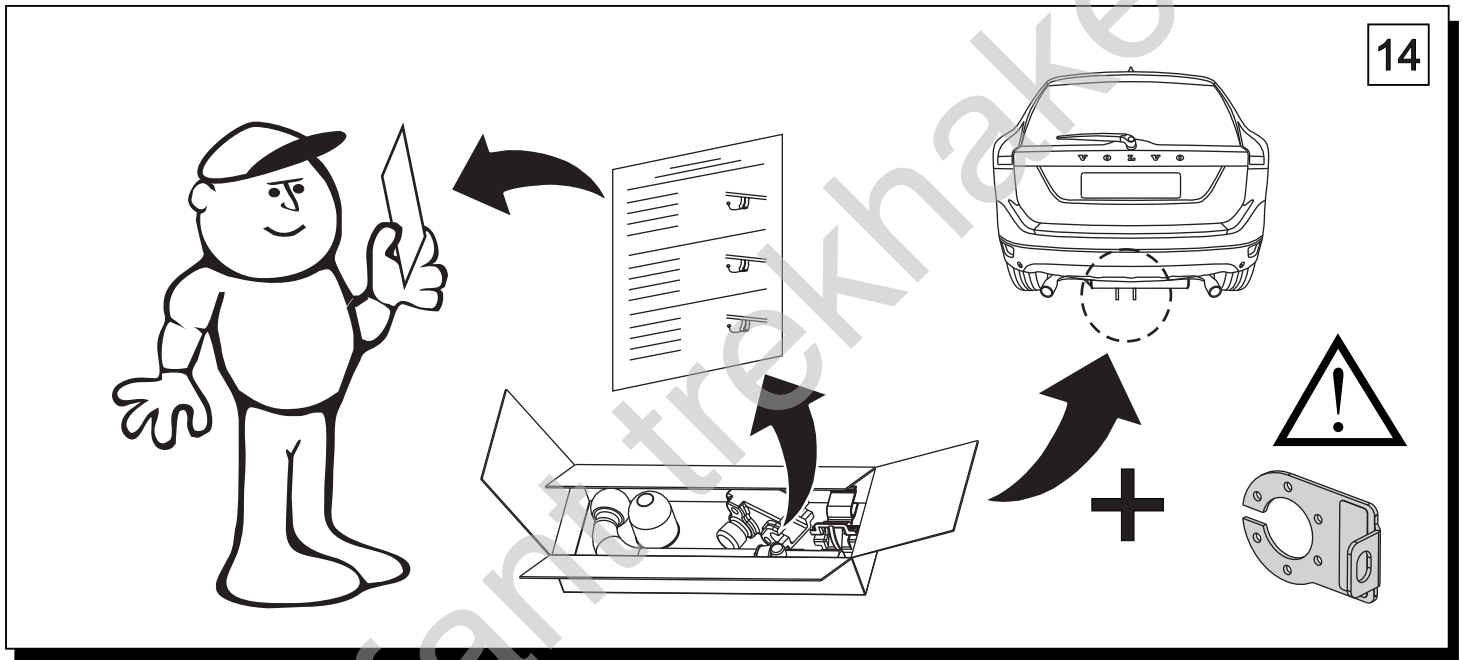

13



14

	<b>M6</b> - 11 Nm	<b>M8</b> - 25 Nm
	<b>M10</b> - 50 Nm	<b>M12</b> - 87 Nm
	<b>M14</b> - 138 Nm	<b>M16</b> - 210 Nm

 **0 km** →  **1000 km**