

# PPUH AUTO-HAK Sp.J.

Henryk i Zbigniew Nejman  
ul. Słoneczna 16K 76-200 SŁUPSK  
POLAND

tel/fax +48 59 8 414 414; +48 59 8 414 413

e-mail: [office@autohak.com.pl](mailto:office@autohak.com.pl)

[www.autohak.com.pl](http://www.autohak.com.pl)



# AUTO-HAK



## RENAULT FLUENCE + Facelift

Cat. no:

**G68A**



05.2010 →

e20

e20\*94/20\*1469\*00

D

7,5 kN



2h



R=1300 kg



S=75 kg

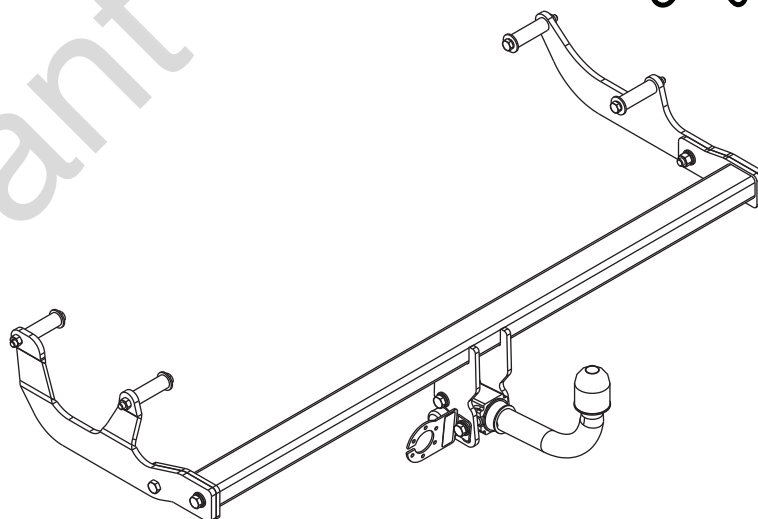

M6 - 8,5 Nm  
M10 - 41 Nm  
M14 - 112 Nm

M8 - 20 Nm  
M12 - 70 Nm  
M16 - 170 Nm



0 km →



1000 km

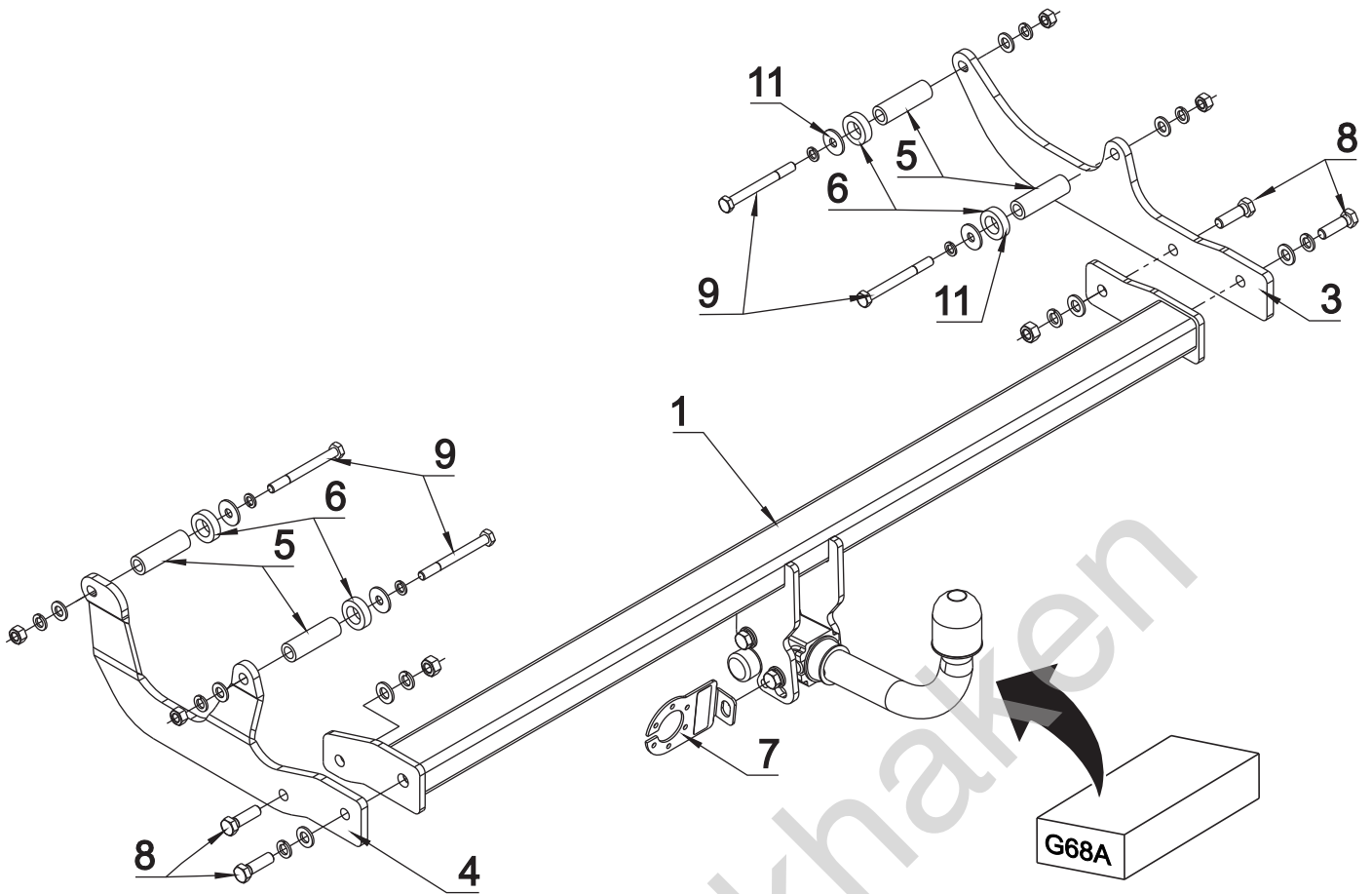

1		x1		8	M12X40	x4
				9	M10X100	x4
				10	∅ 13	x4
				11	∅ 30x∅10.5x2.5 10 (DIN 9021)	x4
				12	∅ 10.5	x4
				13	∅ 12.2	x4
				14	∅ 10.2	x8
				15	M12	x2
				16	M10	x4
2	 G68A Art.nr-KL1G68A	x1				
3		x1				
4		x1				
5	 ∅22x4mm L=70mm	x4				
6	 ∅35x21mm L=10mm	x4				
7	 Art.nr-BL1G68A	x1				

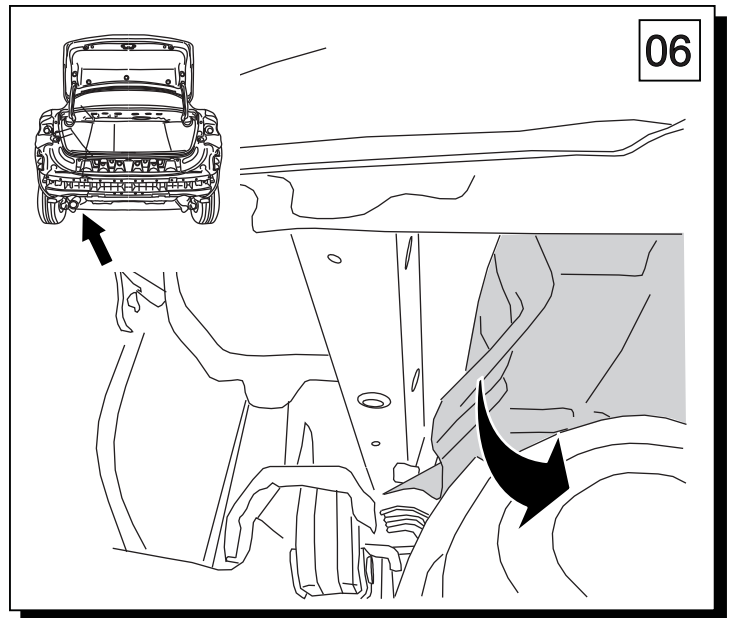
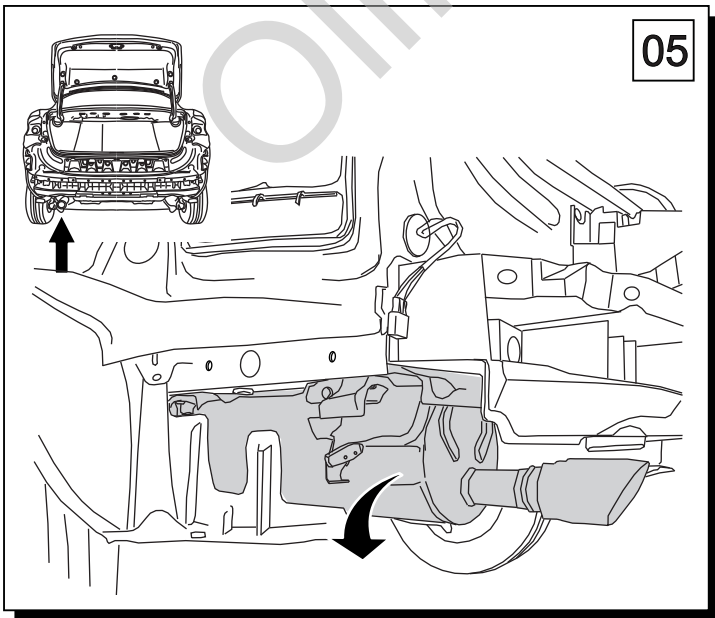
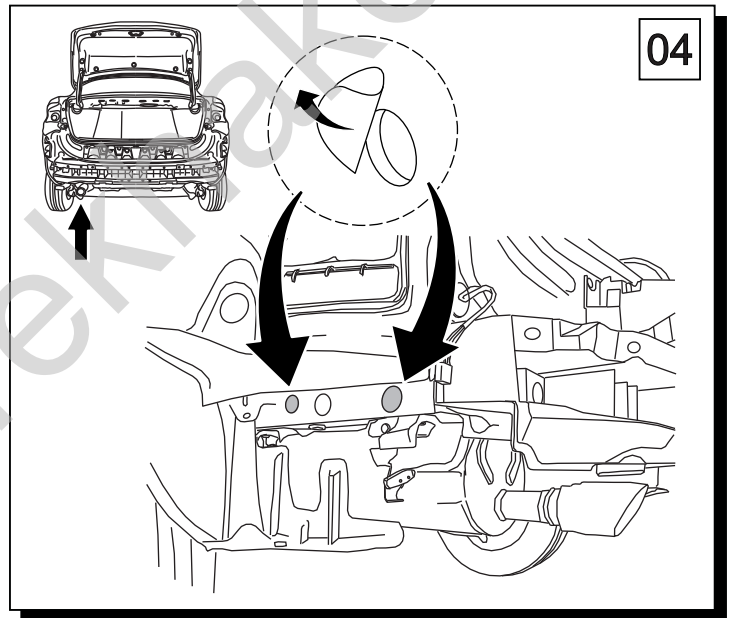
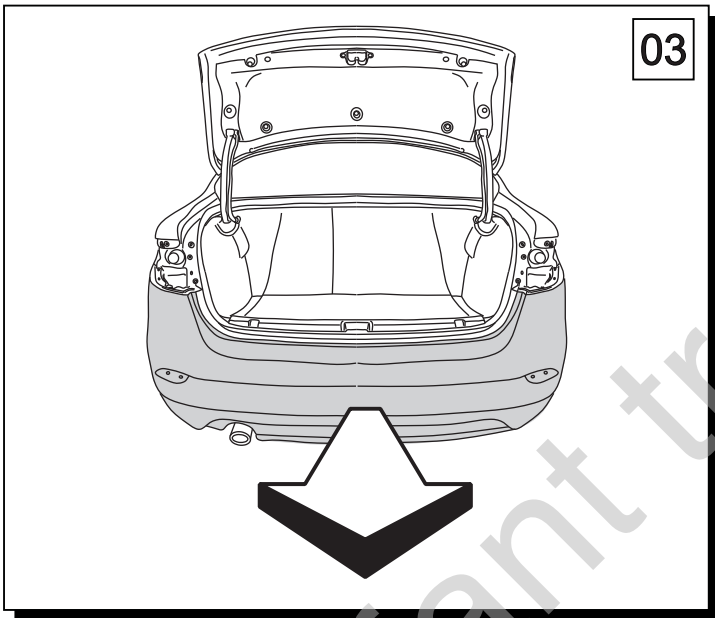
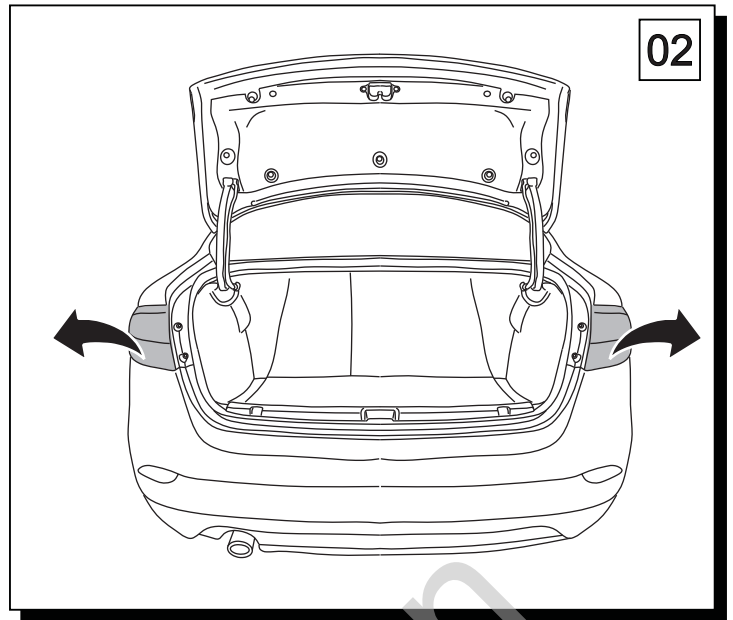
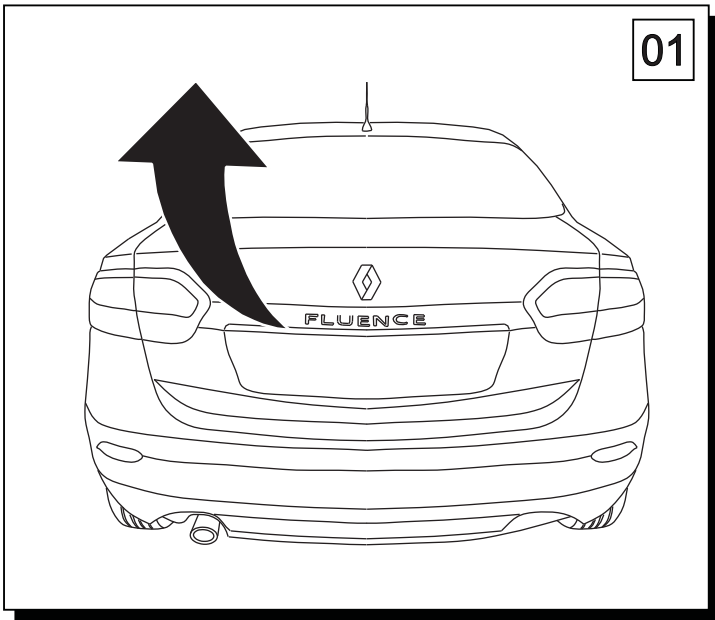

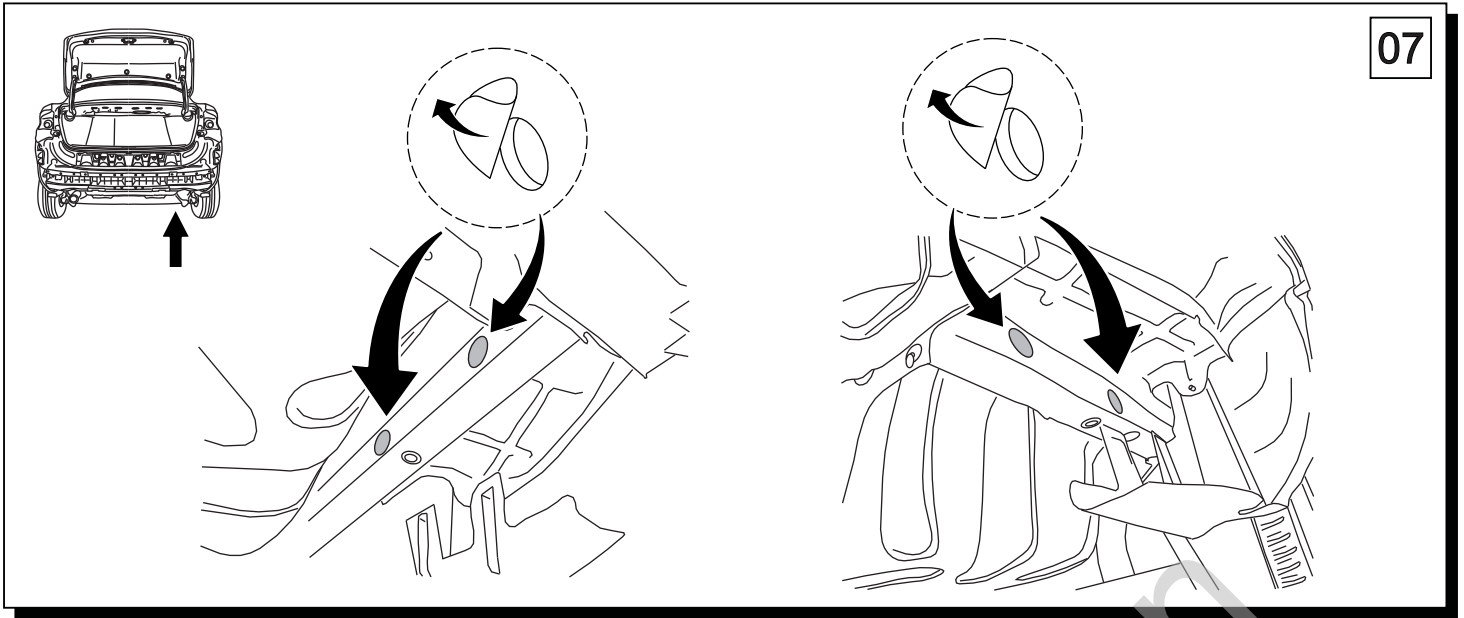

07

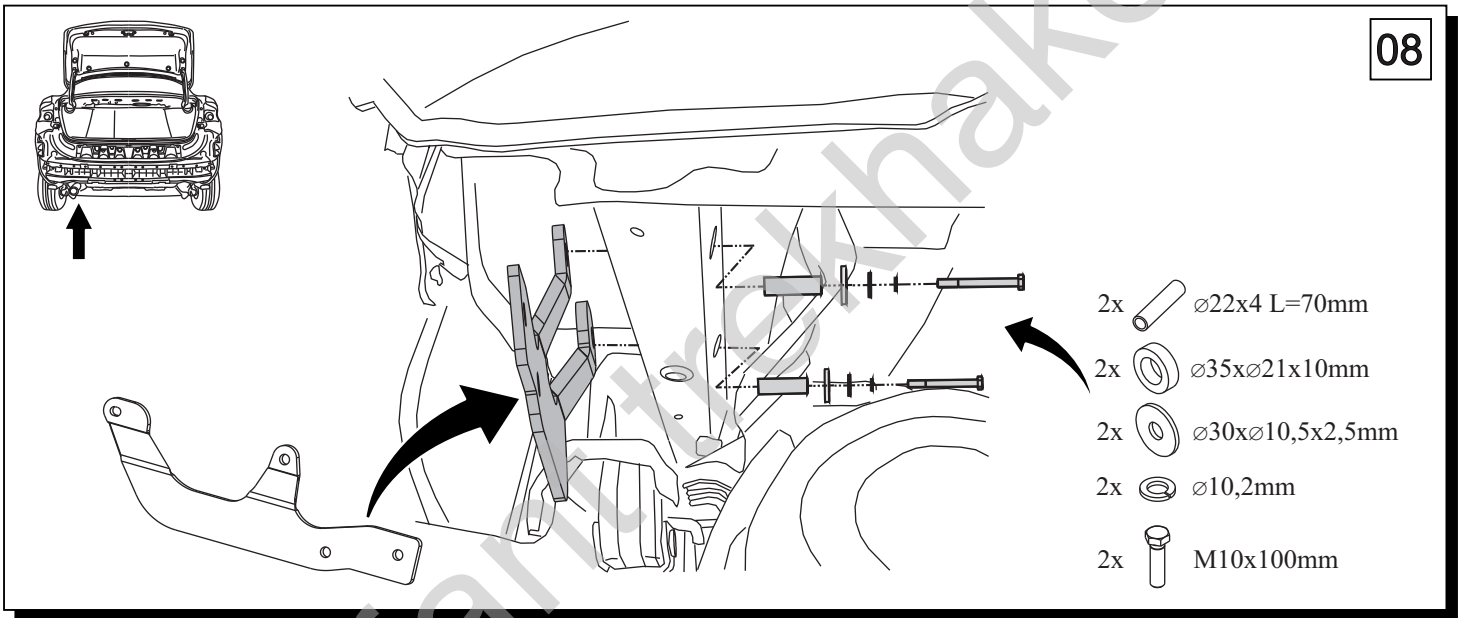

08

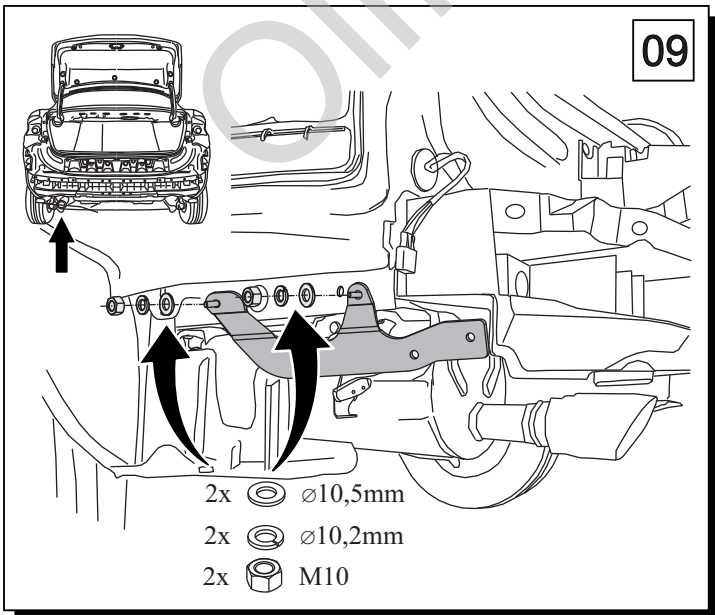

09

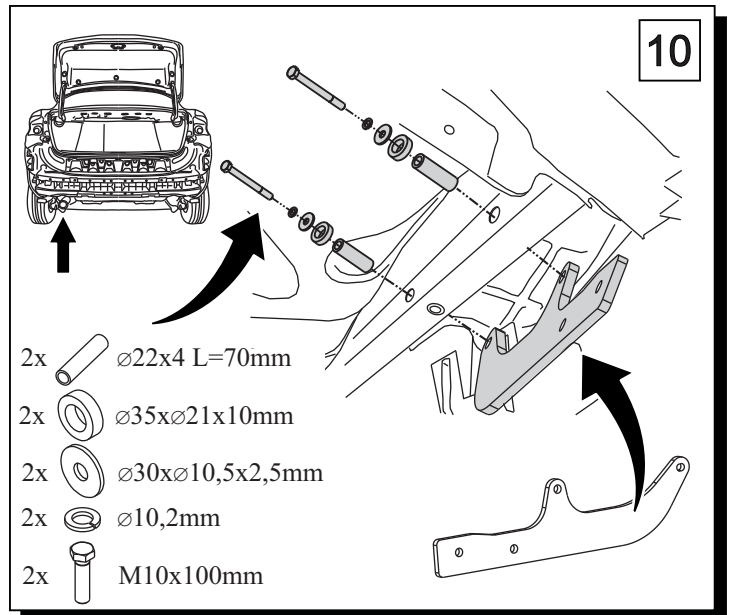

10

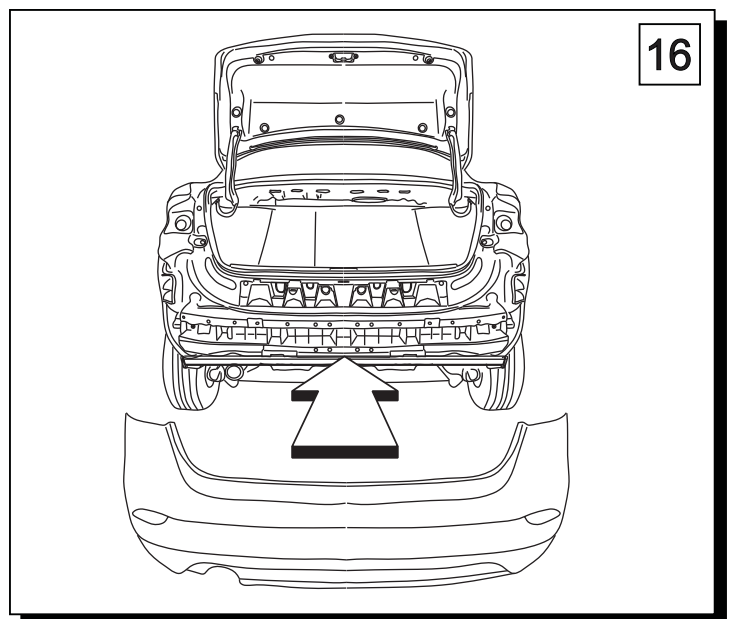
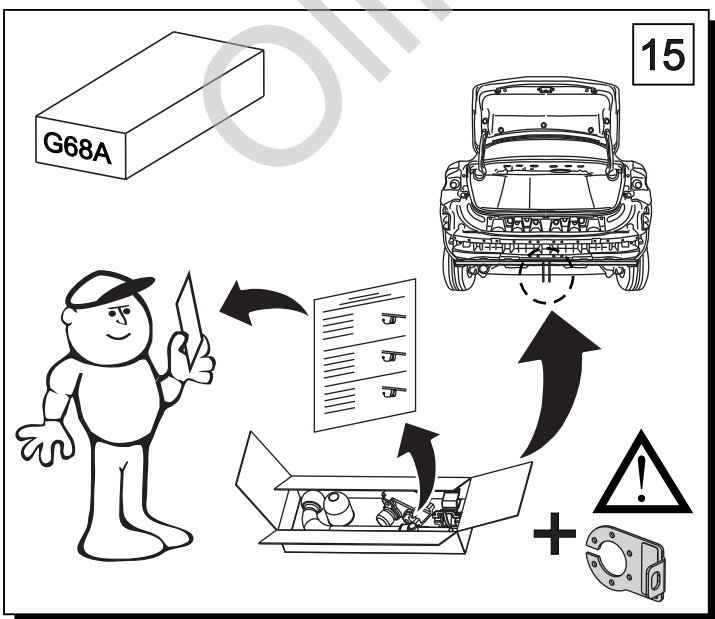
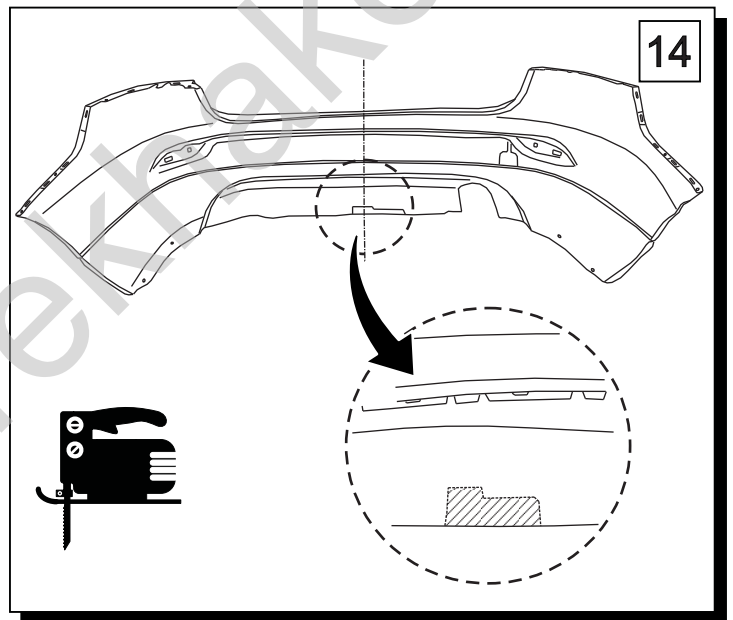
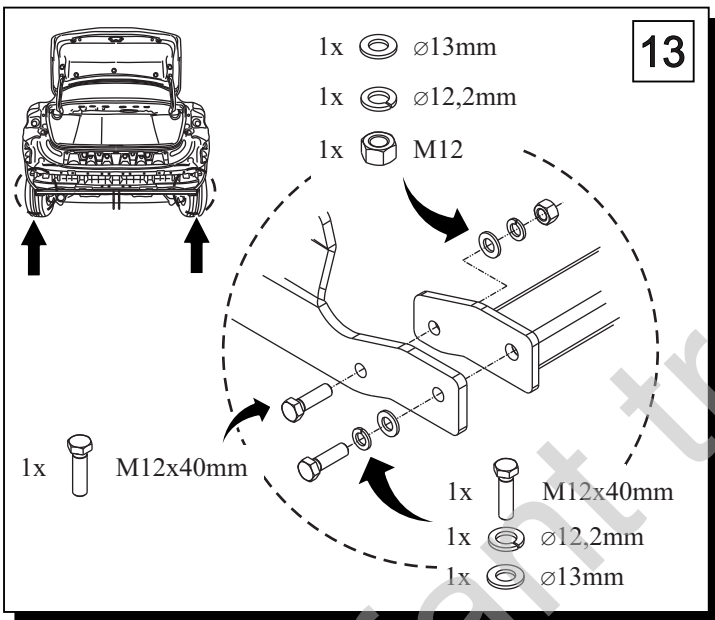
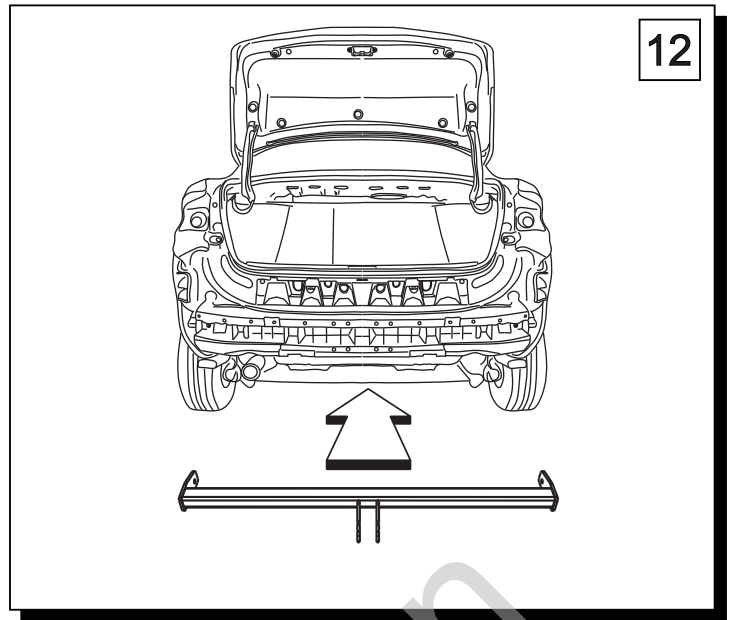
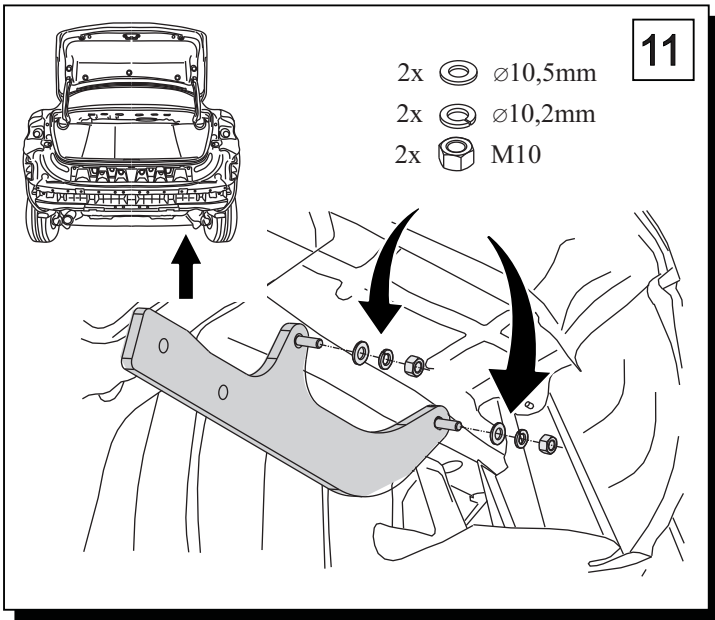

17

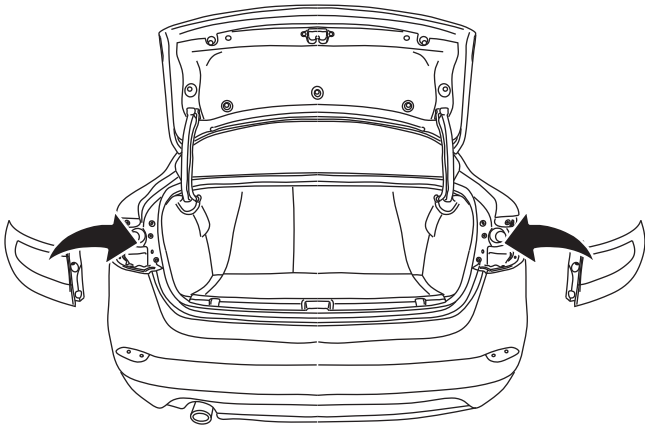

18

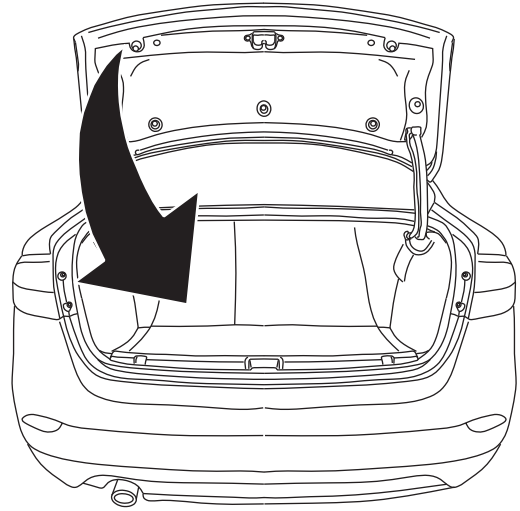

M6 - 11 Nm  
M10 - 50 Nm  
M14 - 138 Nm

M8 - 25 Nm  
M12 - 87 Nm  
M16 - 210 Nm



0 km



1000 km