

AUTO-HAK Sp. z o.o.

ul. Słoneczna 16K 76-200 SŁUPSK
POLAND









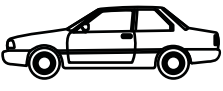

tel/fax +48 59 8 414 414; +48 59 8 414 413

e-mail: office@autohak.com.pl



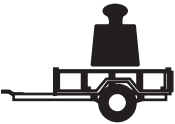



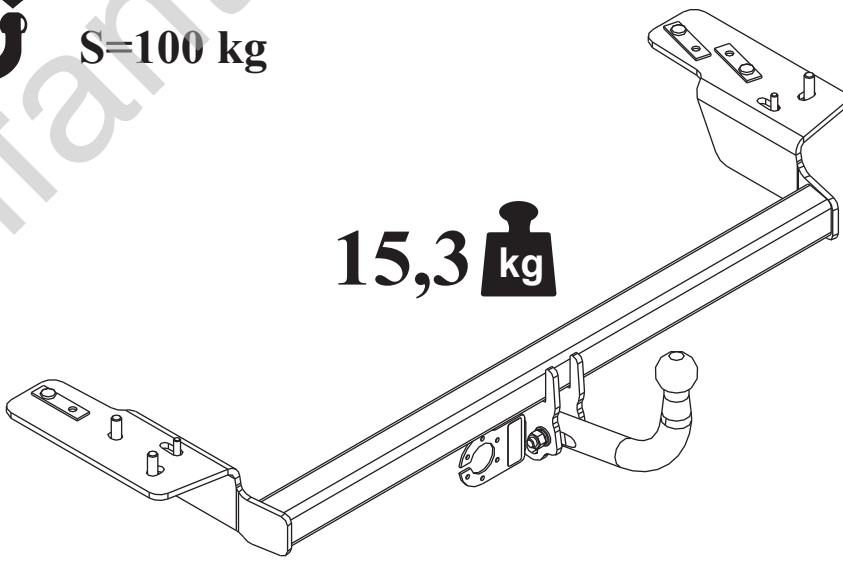

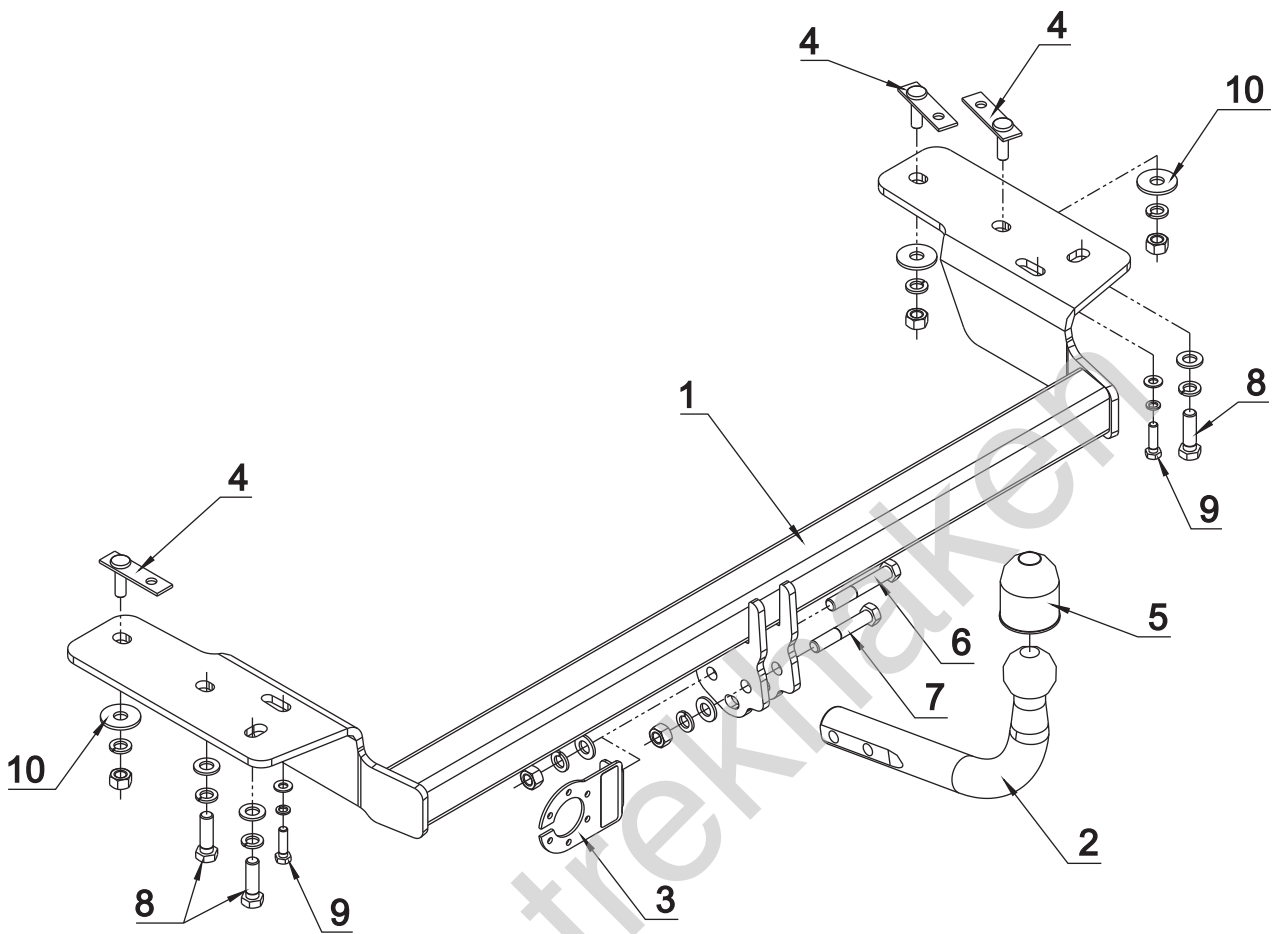
www.autohak.com.pl

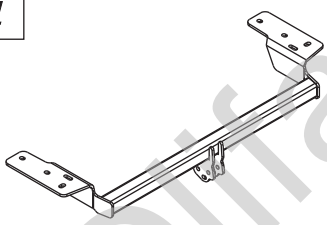

AUTO-HAK

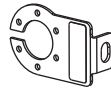
	CHRYSLER 300C 4D, 4x4 SRT	Cat. no:
	06.2004 → 10.2011	CH49
	CHRYSLER 300C TOURING KOMBI, 4x4 SRT	
	09.2004 → 01.2011	 1,5h
e20	<u>e20*94/20*0711*00</u>	 <input type="checkbox"/>
D	10,7 kN	
	R=2000 kg	 <input type="checkbox"/>
	S=100 kg	
	15,3 kg 	
		

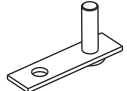

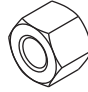
1 	x 1		6 M12x75	x 1
			7 M12x70	x 1
			8 M12x40	x 3
			9 M8x30	x 2
2 	x 1 Art.nr-KL1CH49		10 \varnothing 37x \varnothing 13x3 13 (DIN 9021)	x 3
			11 \varnothing 13	x 5
3 	x 1 Art.nr-BL1CH49		12 \varnothing 8.4	x 2
			13 \varnothing 12.2	x 8
4 	x 3		14 \varnothing 8.2	x 2
			15 M12	x 5
5 	x 1			

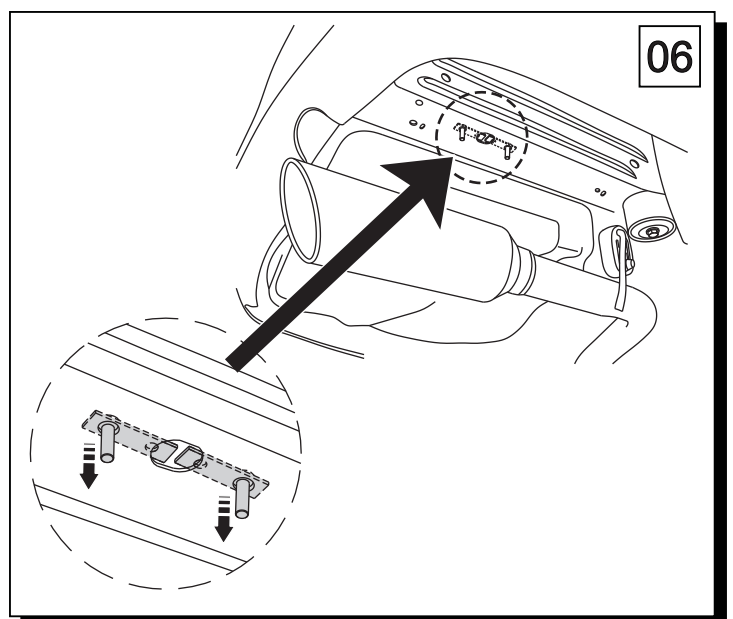
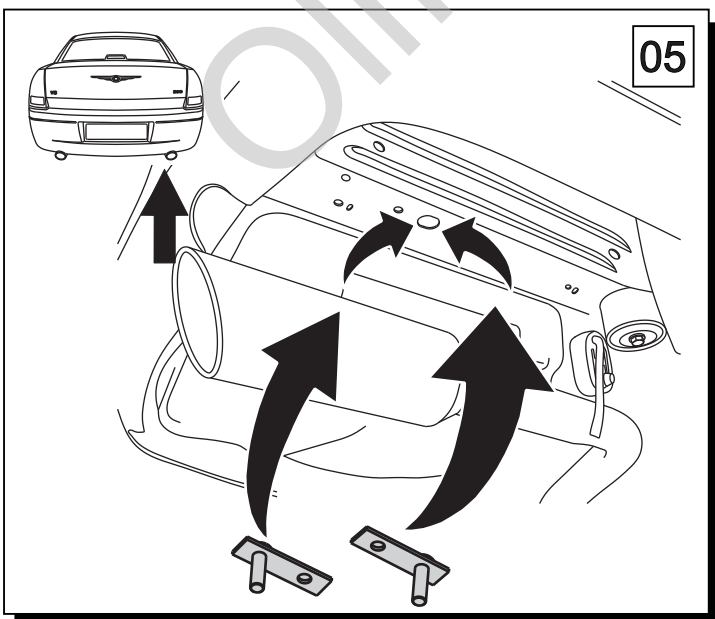
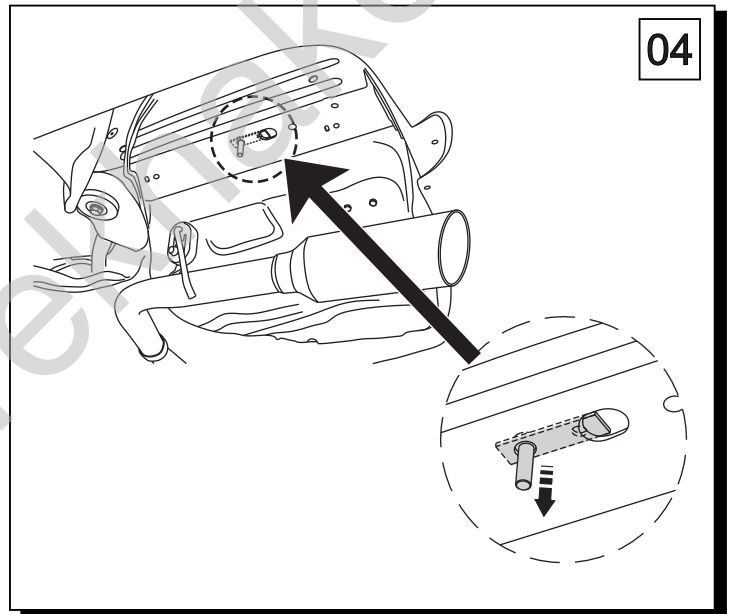
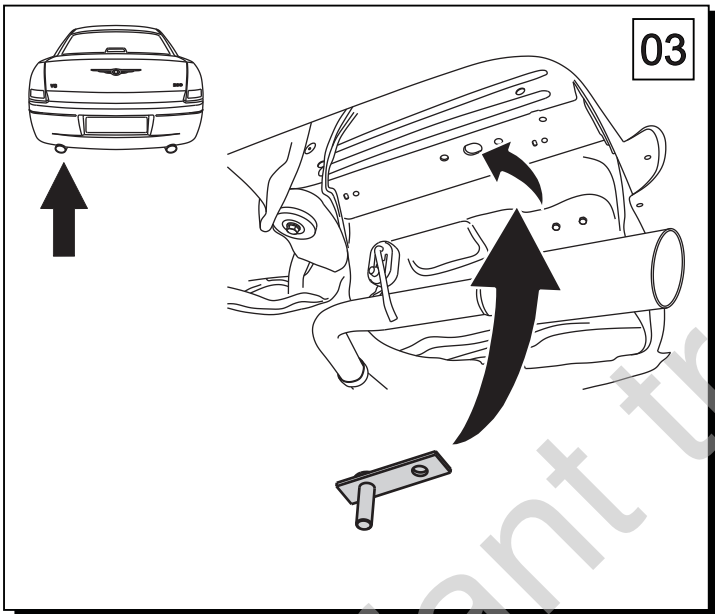
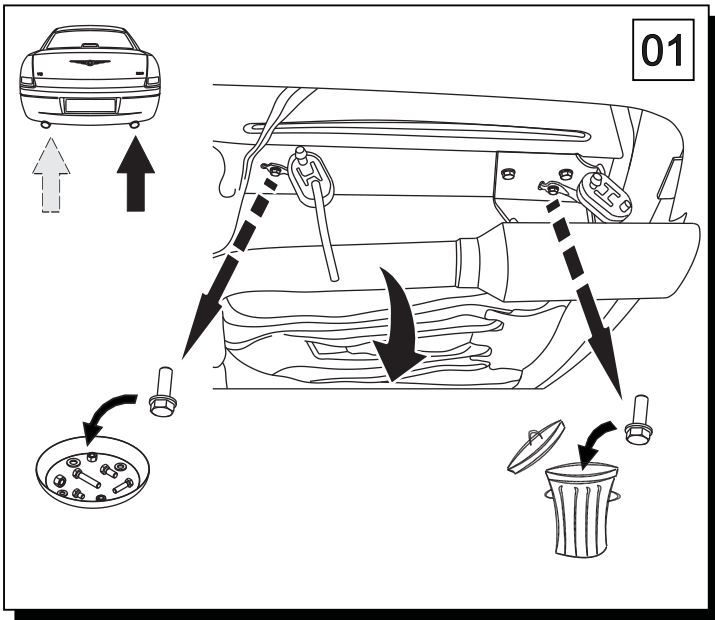

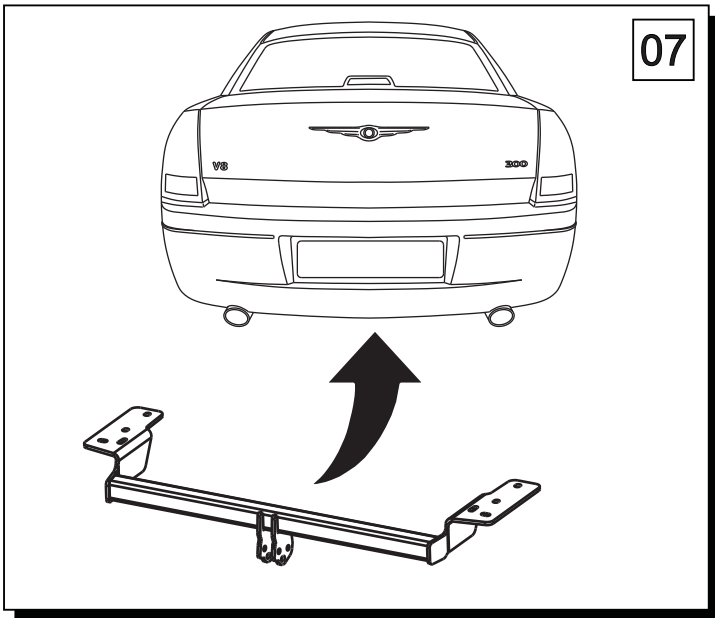

07

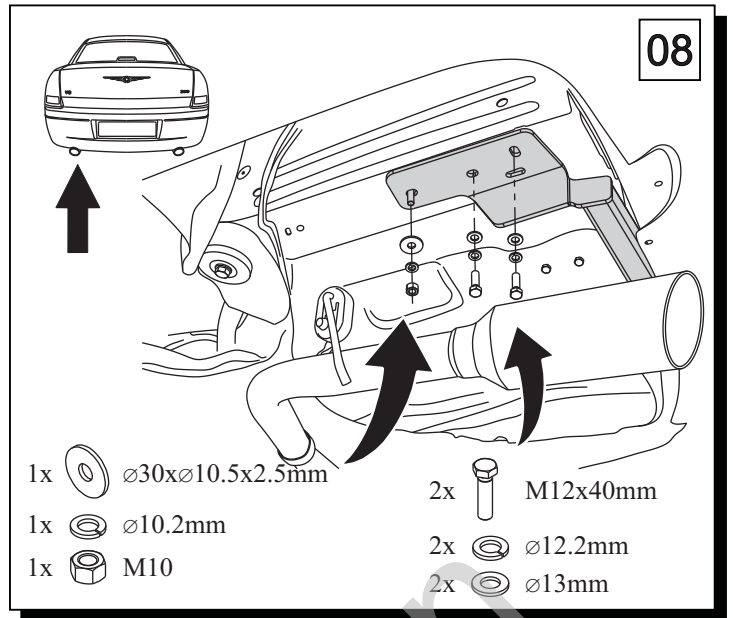

08

- 1x $\varnothing 30 \times 10.5 \times 2.5 \text{mm}$
- 1x $\varnothing 10.2 \text{mm}$
- 1x M10
- 2x M12x40mm
- 2x $\varnothing 12.2 \text{mm}$
- 2x $\varnothing 13 \text{mm}$

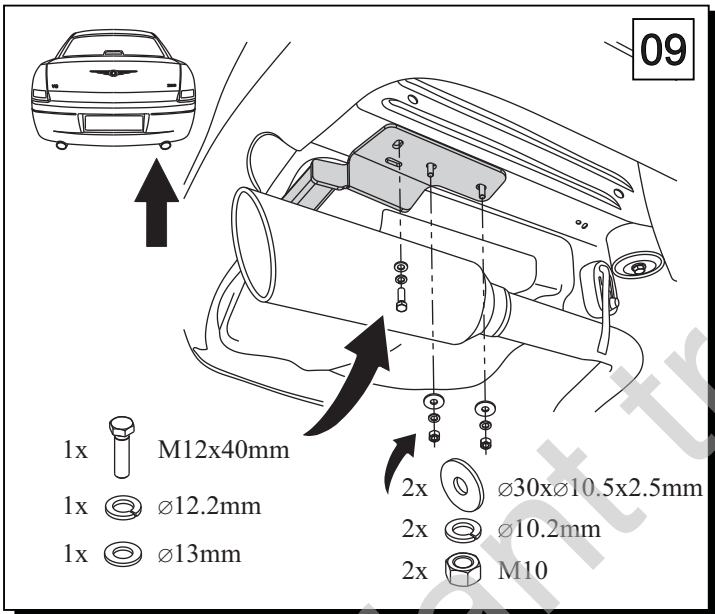

09

- 1x M12x40mm
- 1x $\varnothing 12.2 \text{mm}$
- 1x $\varnothing 13 \text{mm}$
- 2x $\varnothing 30 \times 10.5 \times 2.5 \text{mm}$
- 2x $\varnothing 10.2 \text{mm}$
- 2x M10

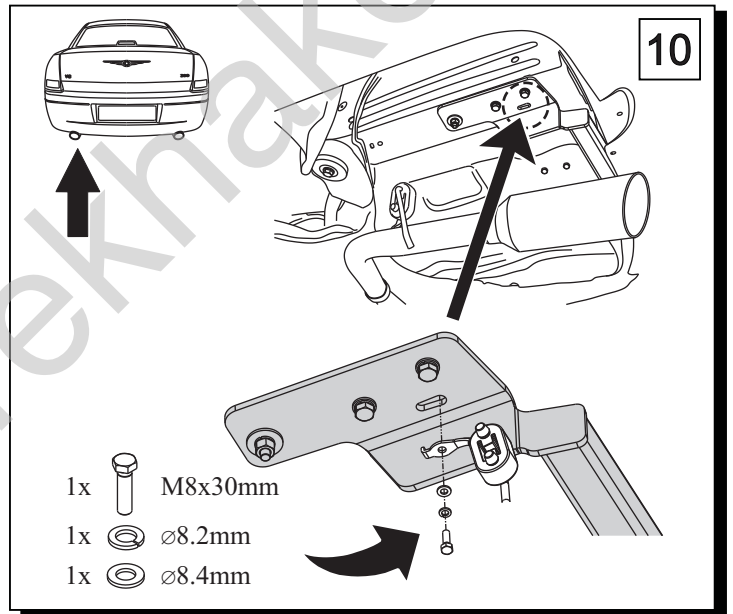

10

- 1x M8x30mm
- 1x $\varnothing 8.2 \text{mm}$
- 1x $\varnothing 8.4 \text{mm}$

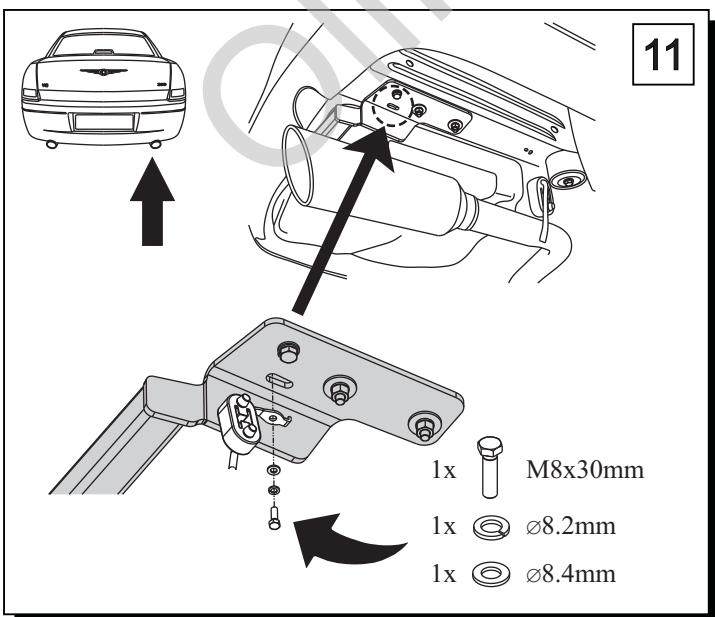



11

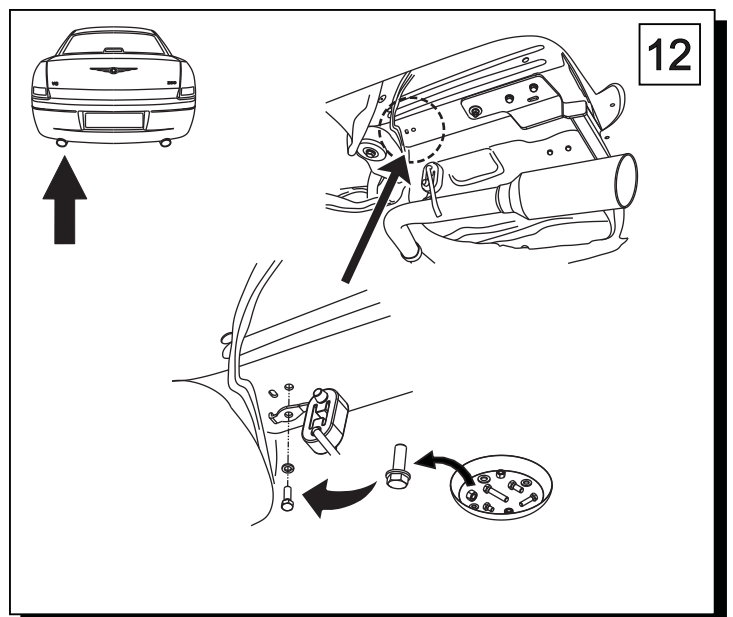

- 1x M8x30mm
- 1x $\varnothing 8.2 \text{mm}$
- 1x $\varnothing 8.4 \text{mm}$

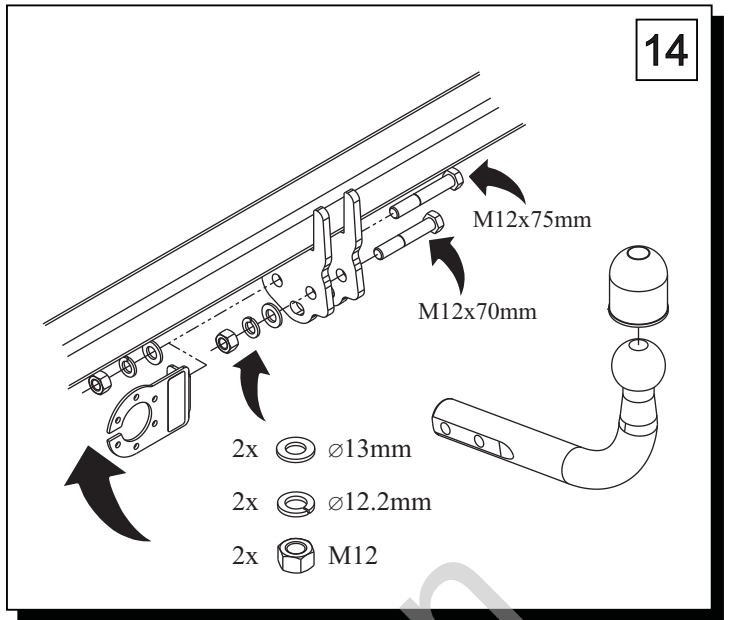
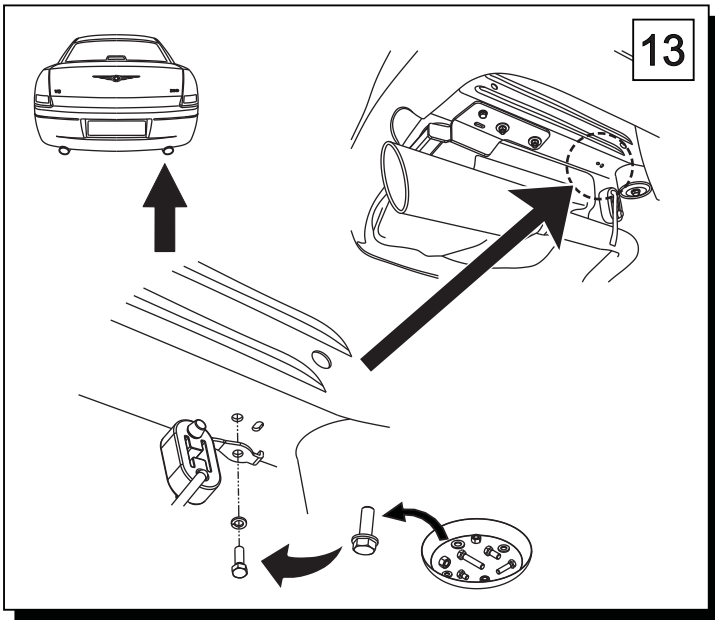

12



	M6 - 11 Nm	M8 - 25 Nm
	M10 - 50 Nm	M12 - 87 Nm
	M14 - 138 Nm	M16 - 210 Nm

 **0 km** →  **1000 km**