

PPUH AUTO-HAK Sp.J.

Henryk i Zbigniew Nejman
ul. Słoneczna 16K 76-200 SŁUPSK
POLAND

tel/fax +48 59 8 414 414; +48 59 8 414 413

e-mail: office@autohak.com.pl

www.autohak.com.pl



AUTO-HAK

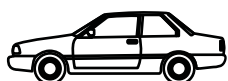

Ford Ranger zderzak ze stopniem

 01.2012 → 12.2015
01.2016 →

Cat. no:

C59

Mazda BT-50

Pick-up 4WD,

 03.2012 →

~~2WD~~



2h

E20

E20-55R-01 3166



D

17,2 kN



R=2750 kg



S=225 kg

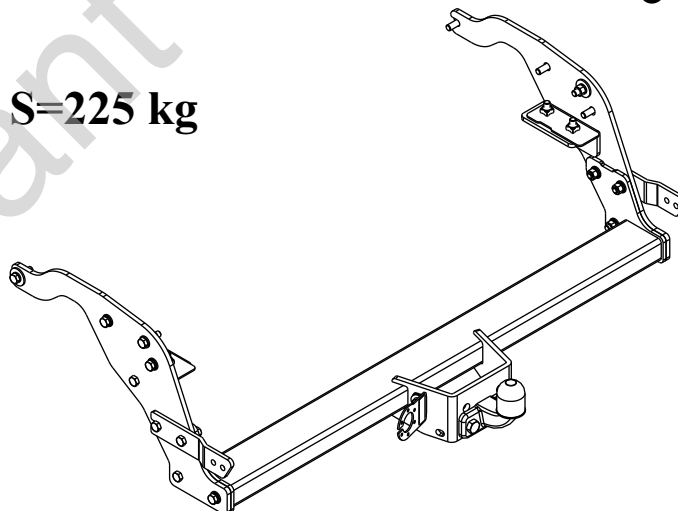

M6 - 11 Nm
M10 - 50 Nm
M14 - 138 Nm

M8 - 25 Nm
M12 - 87 Nm
M16 - 210 Nm



0 km →



1000 km

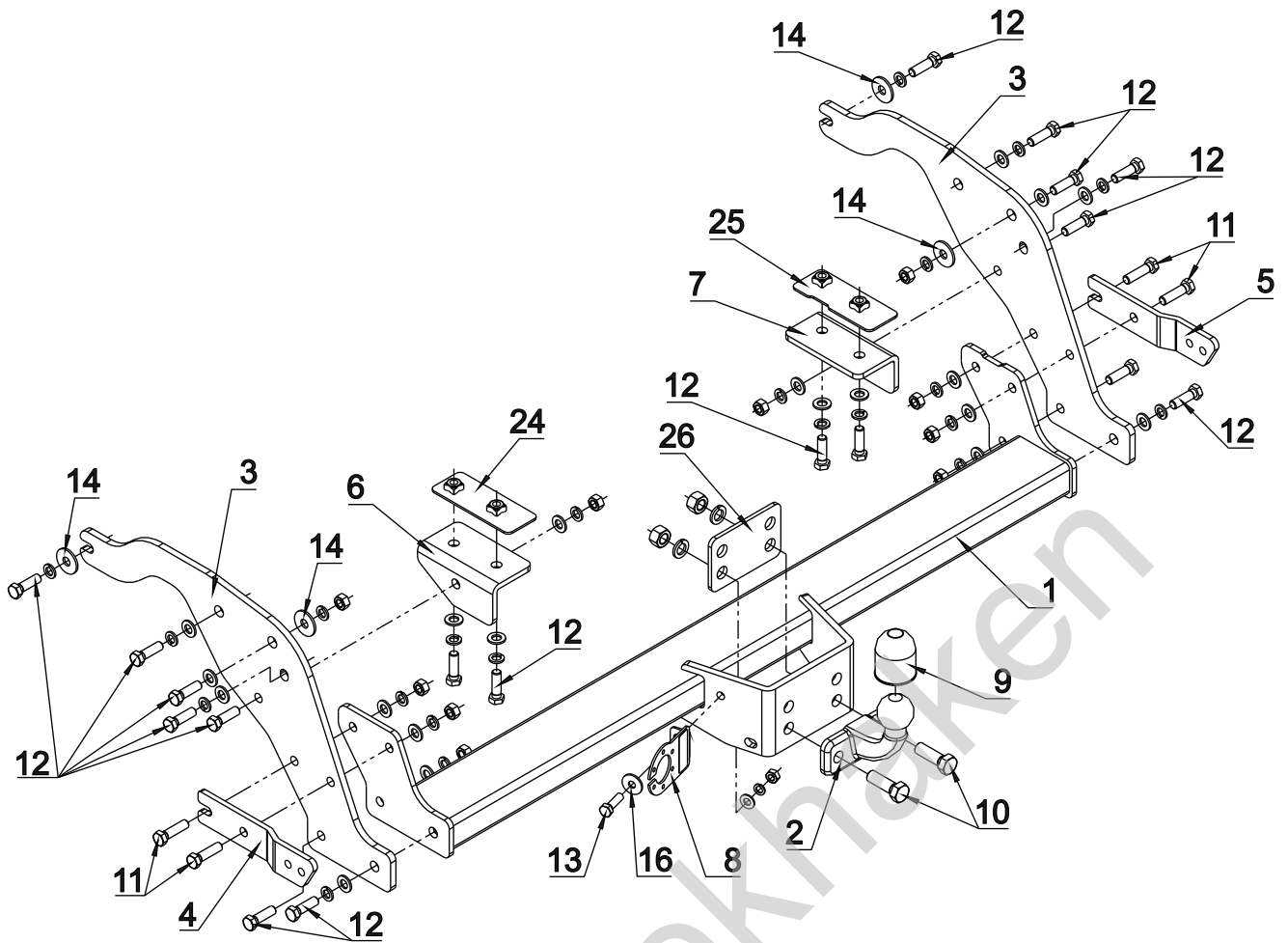

1		x1		10	M16x50	x2
				11	M12x45	x4
				12	M12x40	x18
				13	M10x35	x1
2		x1		14	∅ 37x∅13x3 13 (DIN 9021)	x4
	Art.nr-KL1C59			15	∅ 13	x20
3		x2		16	∅ 30x∅10.5x2.5 10 (DIN 9021)	x1
				17	∅ 10.5	x1
4		x1		18	∅ 16.3	x2
				19	∅ 12.2	x22
5		x1		20	∅ 10.2	x1
				21	M16	x2
6		x1		22	M12	x10
				23	M10	x1
7		x1		24		x1
8		x1		25		x1
	Art.nr-BL1C59			26		x1
9		x1				

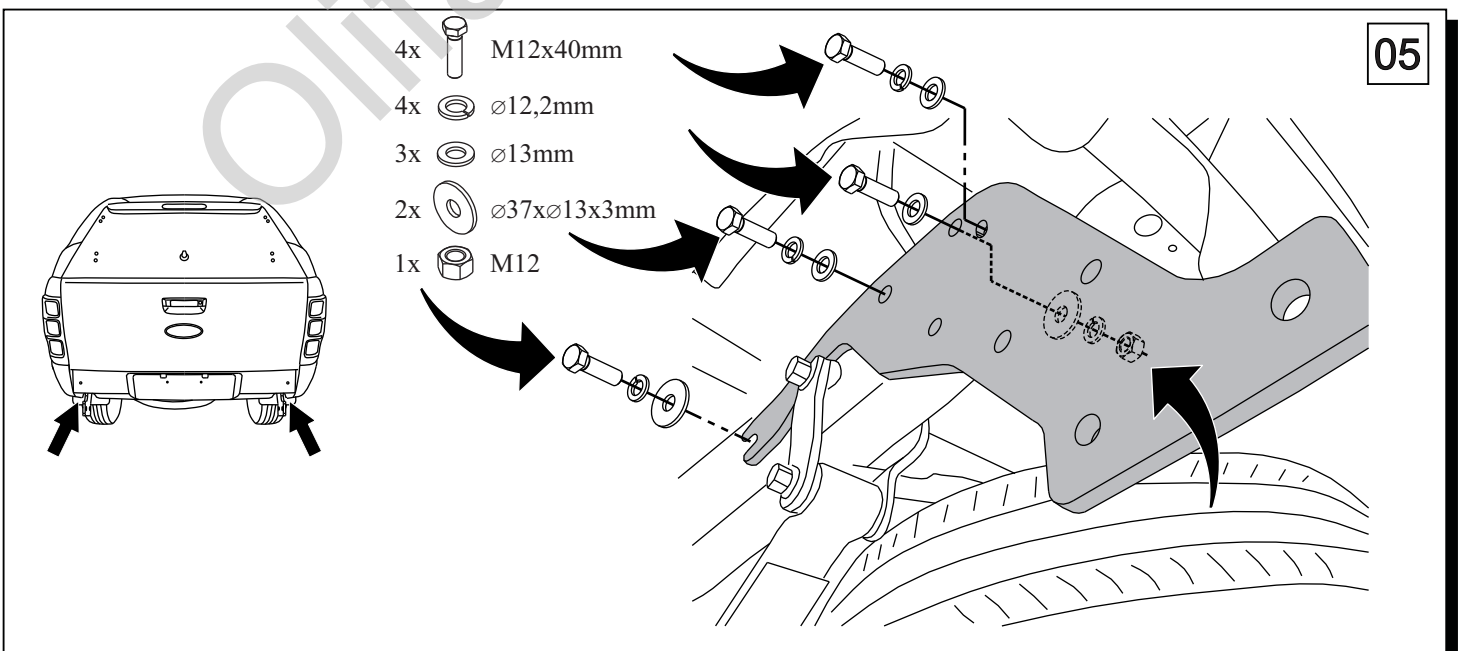
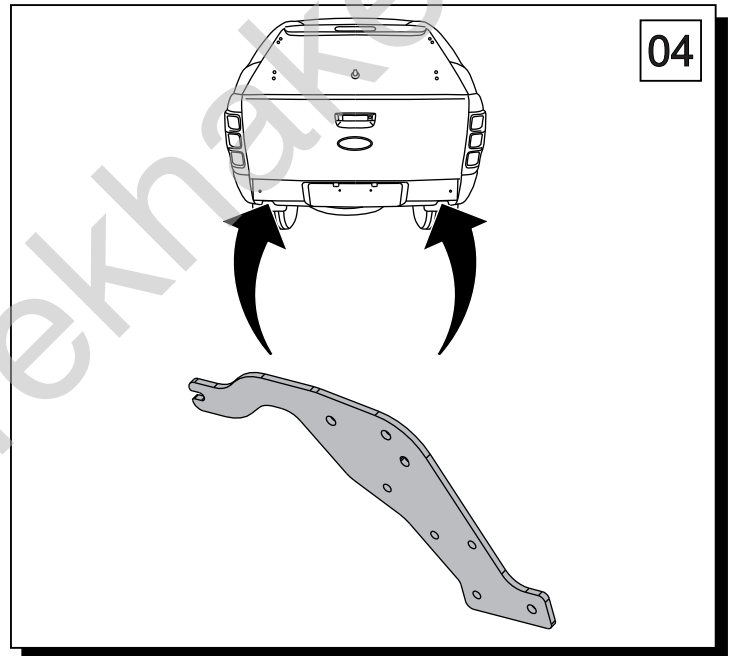
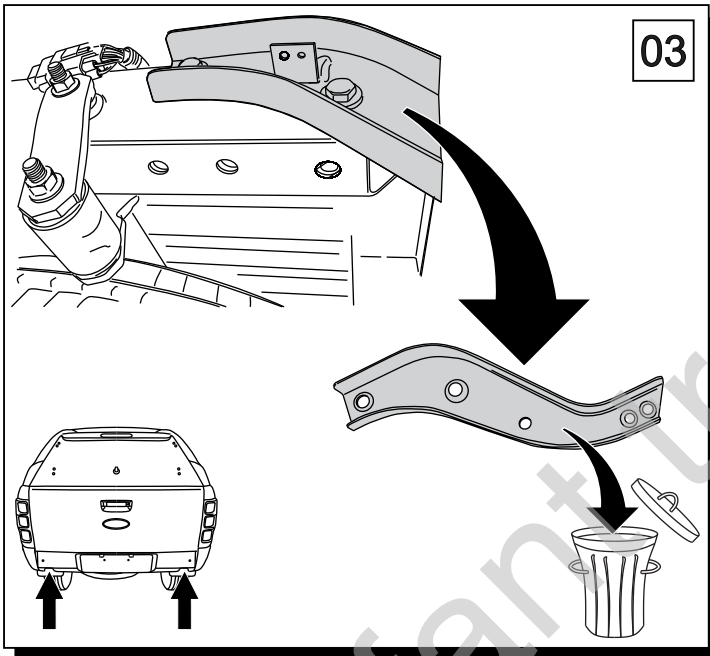
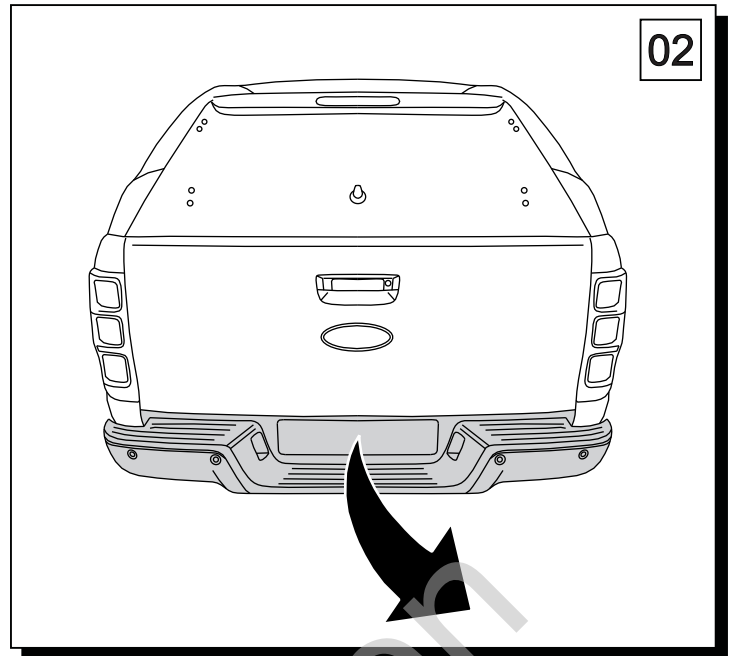
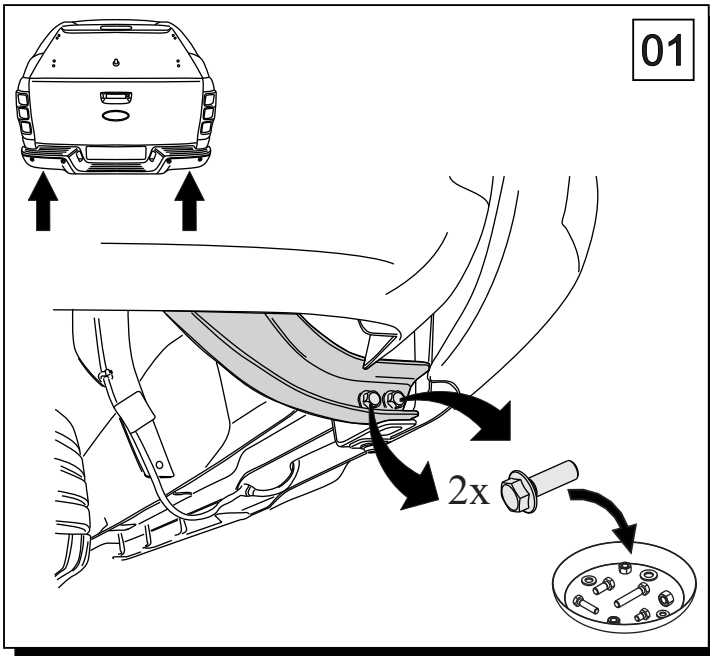

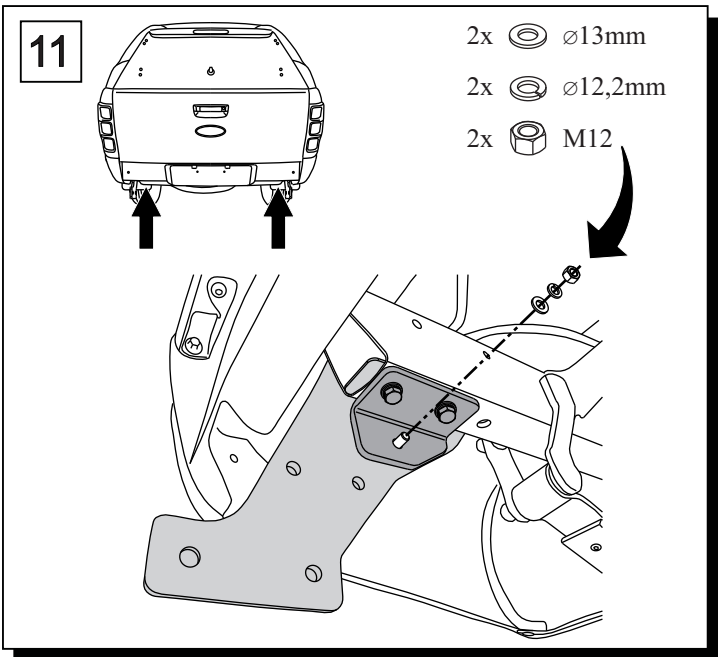
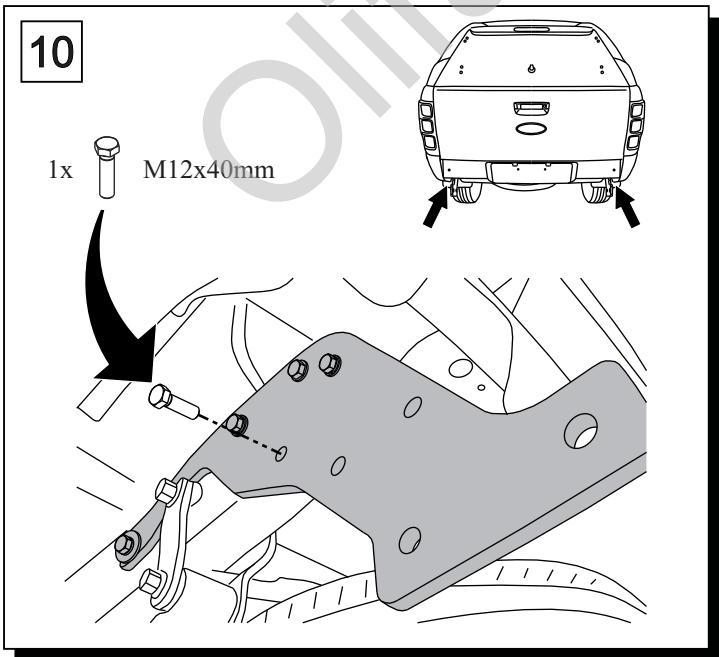
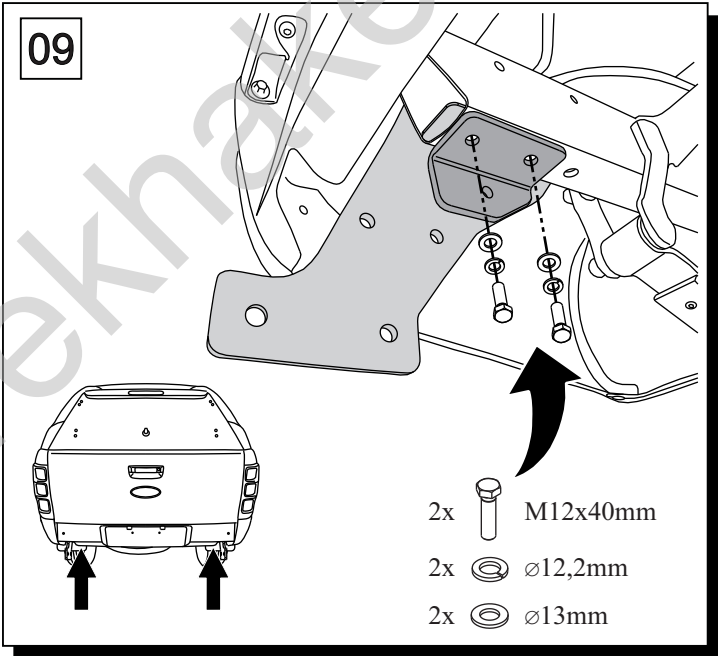
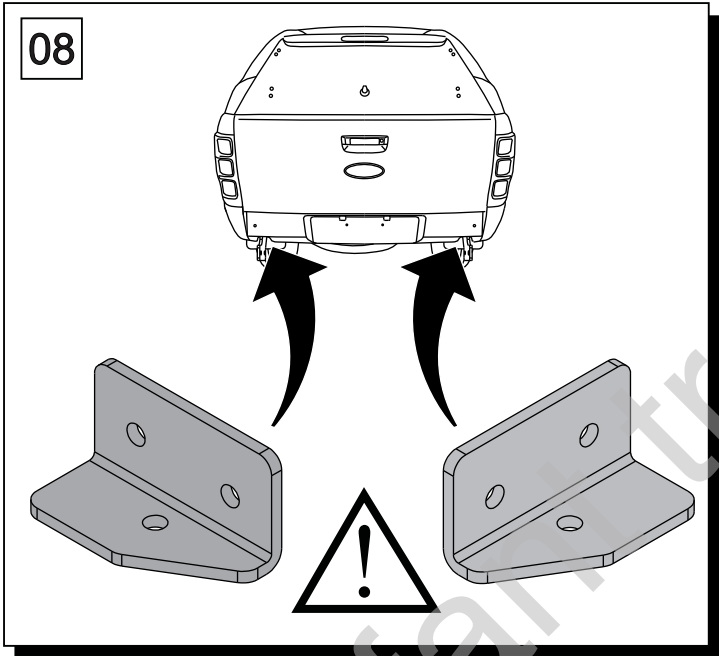
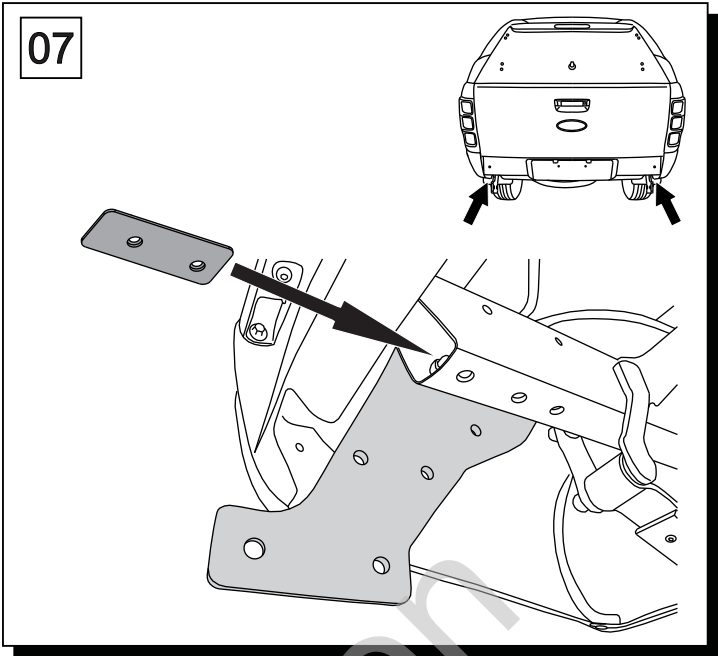
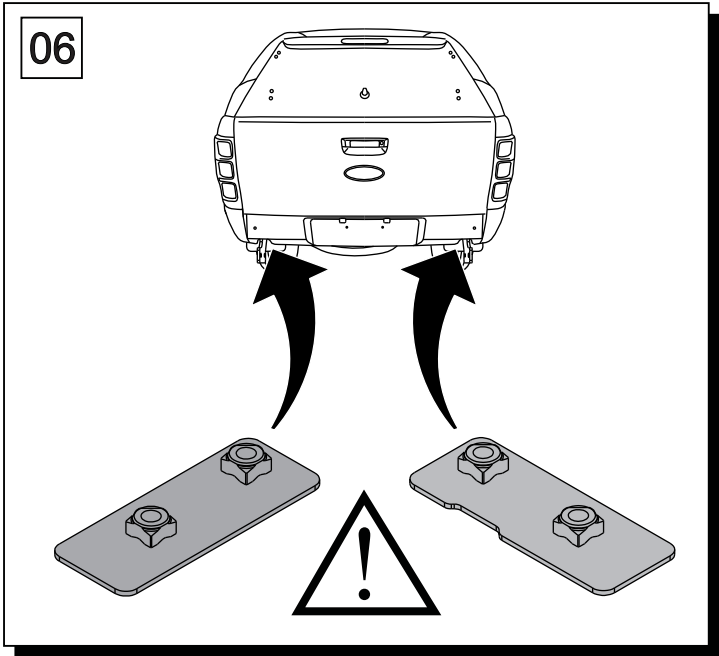

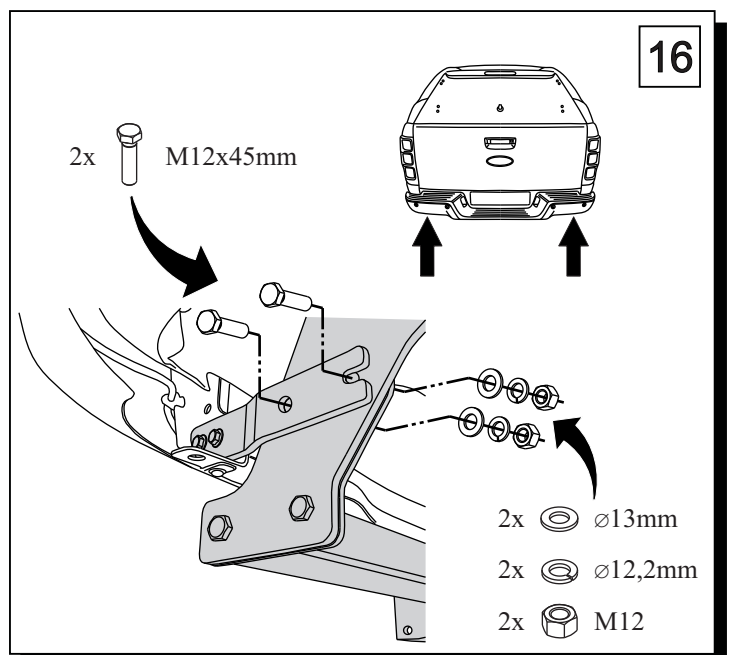
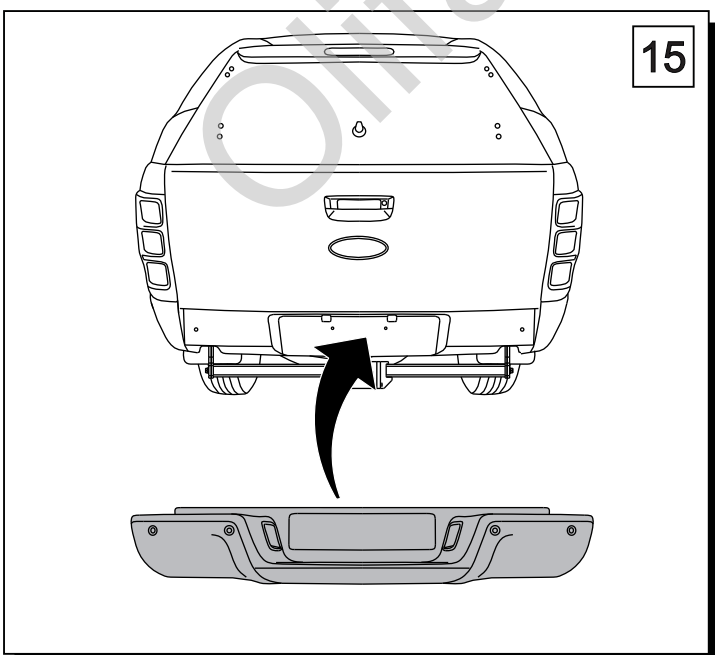
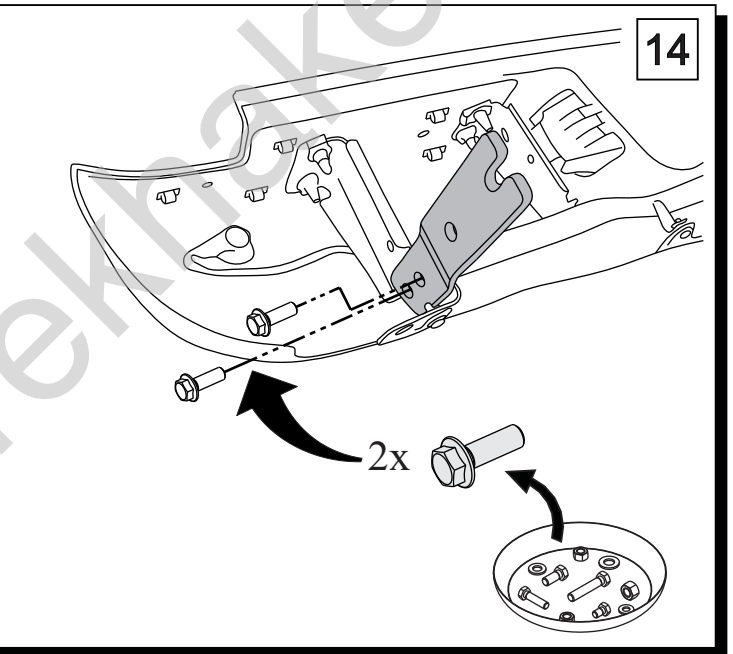
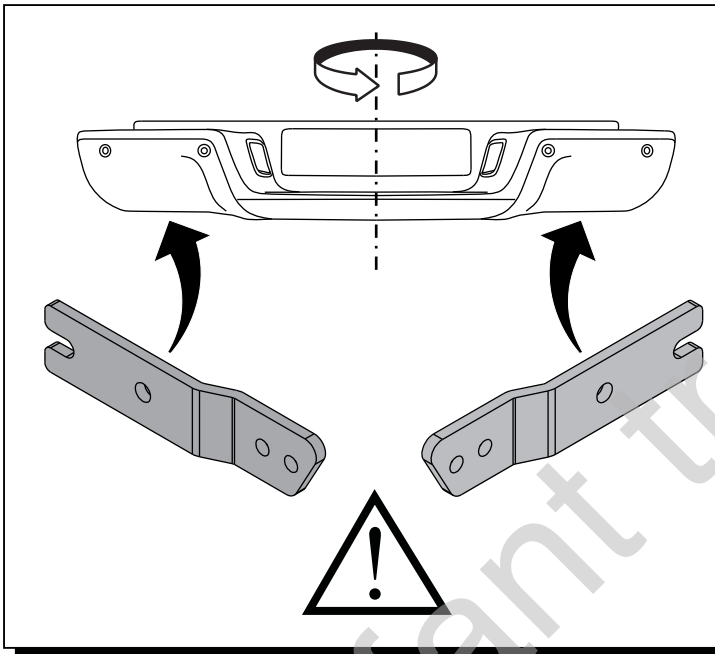
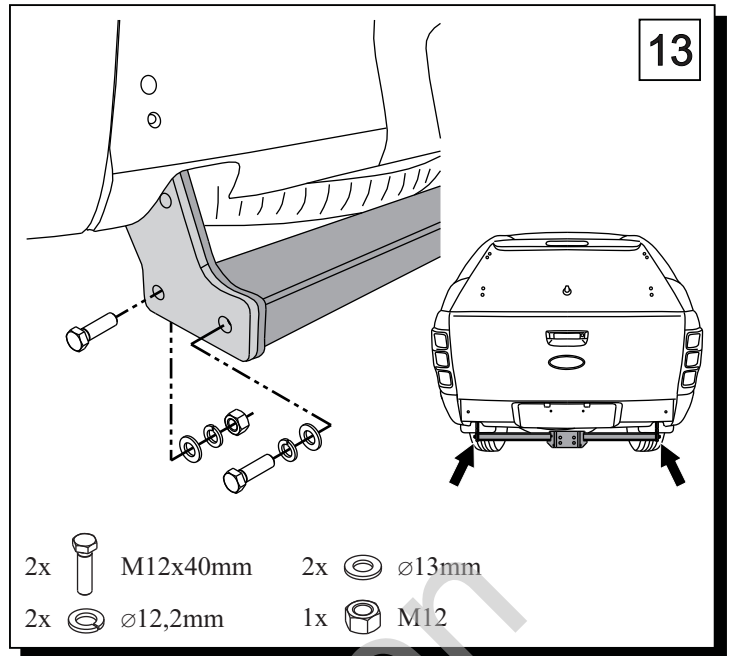
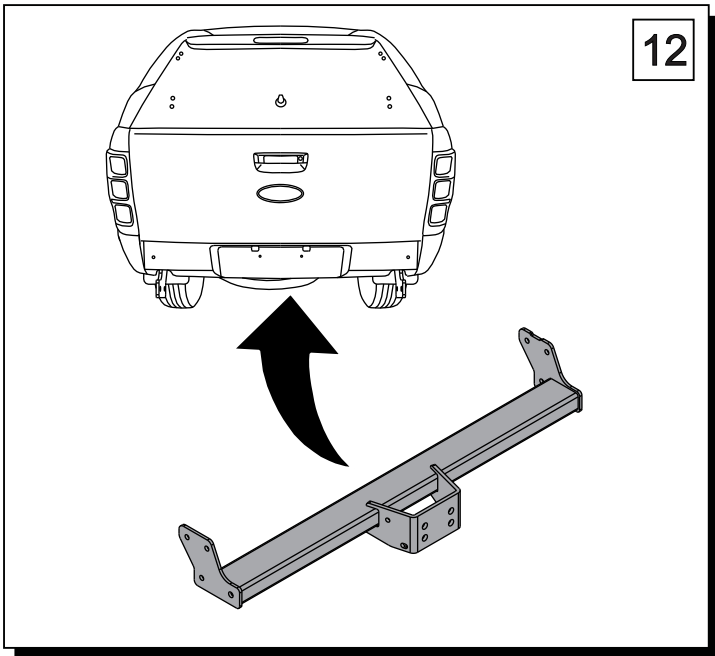



2x  $\varnothing 16,3\text{mm}$

2x  M16

1x  M10x35mm

1x  $\varnothing 30 \times \varnothing 10,5 \times 2,5\text{mm}$

1x  $\varnothing 10,5\text{mm}$

1x  $\varnothing 10,2\text{mm}$

1x  M10

2x  M16x50mm

