

# AUTO-HAK Sp. z o.o.

ul. Słoneczna 16K 76-200 SŁUPSK  
POLAND

tel/fax +48 59 8 414 414; +48 59 8 414 413

e-mail: [office@autohak.com.pl](mailto:office@autohak.com.pl)

[www.autohak.com.pl](http://www.autohak.com.pl)



# AUTO-HAK

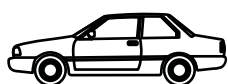

**BMW 5 (F10)**

4D, ~~M Pakiet/M5 i Active Hybrid~~



03.2010 → 02.2014

03.2014 →

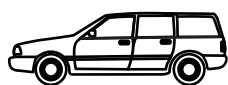

**BMW 5 (F11) Touring**

KOMBI, ~~M Pakiet/M5~~



09.2010 → 02.2014

03.2014 →

Nr kat.

**B18A**

**E20**

**E20-55R-01 3817**

**D**

**11,8 kN**

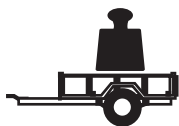

**R=2200 kg**



**S=100 kg**



**2h**



**18,2 kg**

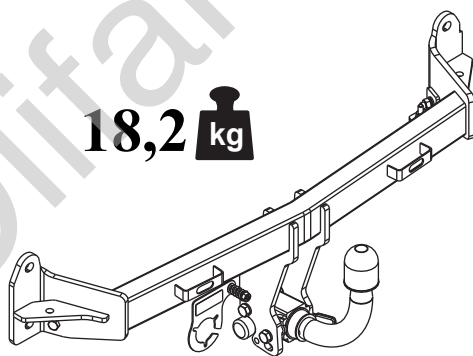

FULL VERSION INSTRUCTION



| śruba      | Nm | M6  | M8 | M10 | M12 | M14 | M16 |
|------------|----|-----|----|-----|-----|-----|-----|
| klasa 8.8  |    | 9,9 | 24 | 48  | 83  | 132 | 200 |
| klasa 10.9 |    | 14  | 34 | 67  | 117 | 185 | 285 |









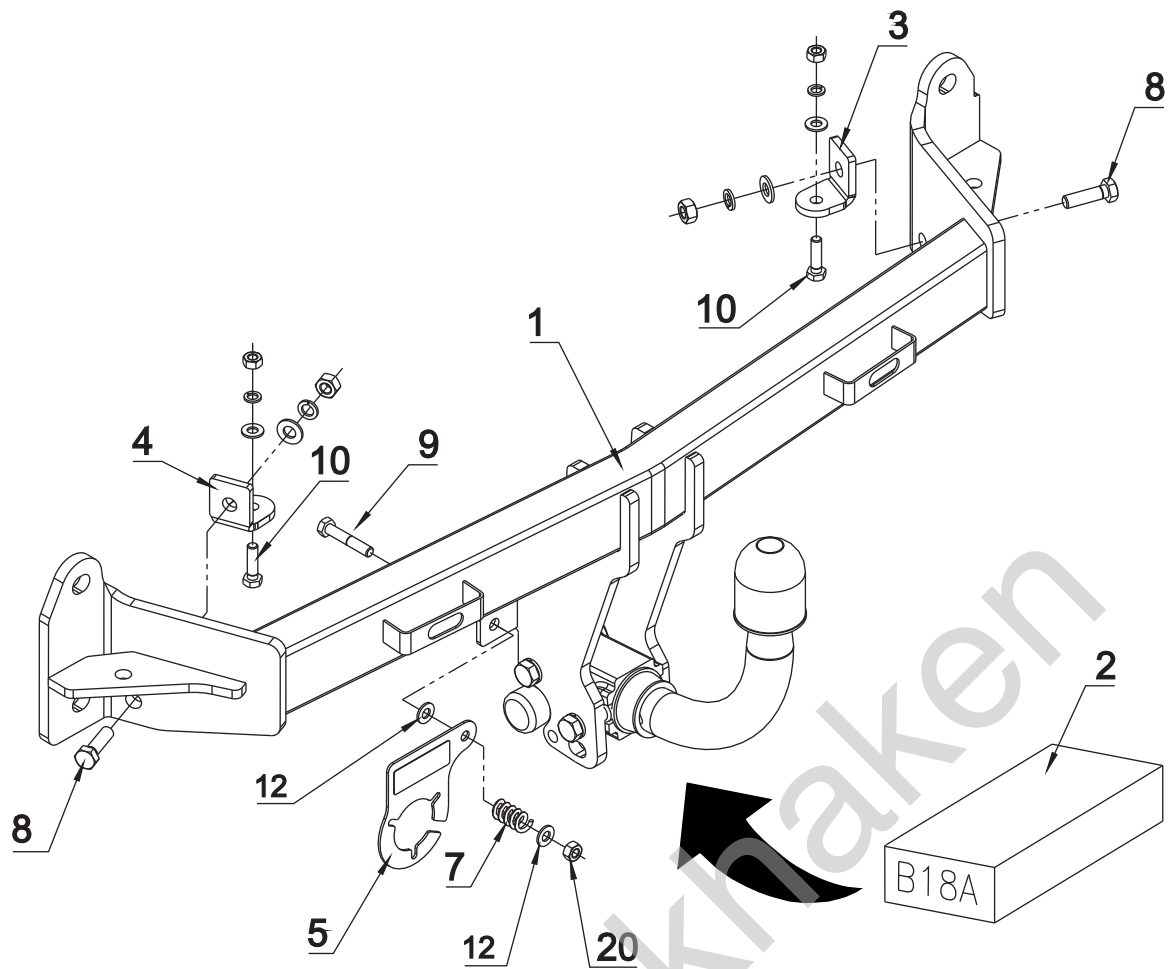

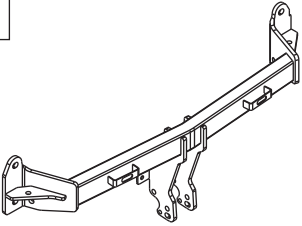

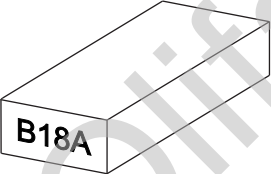
**0 km**



**1000 km**



|   |     |   |     |                |     |
|---|-----|---|-----|----------------|-----|
|                    | x 1 |  | 8   | M10x35         | x 2 |
|   |     |   | 9   | M 8x45         | x 1 |
|   |     |   | 10  | M 8x20         | x 2 |
|   |     |   | 11  | ∅ 10.5         | x 2 |
| <br>Art.nr-KL1B18A | x 1 |  | 12  | ∅ 8.4          | x 4 |
|   |     |   | 13  | ∅ 10.2         | x 2 |
|   |     |   | 14  | ∅ 8.2          | x 2 |
|   |     |   | 15  | M10            | x 2 |
|                    | x 3 | 16  | M 8 |                |     |
|   |     |   |     |                |     |
|                    | x 1 |   |     |                |     |
|                    | x 1 |   |     |                |     |
|                    | x 1 |   |     |                |     |
|   |     |   |     | Art.nr-BL1B18A |     |
|                    | x 1 |   |     |                |     |
|                    | x 1 |   |     |                |     |

⚠ Limousine ⚠

01

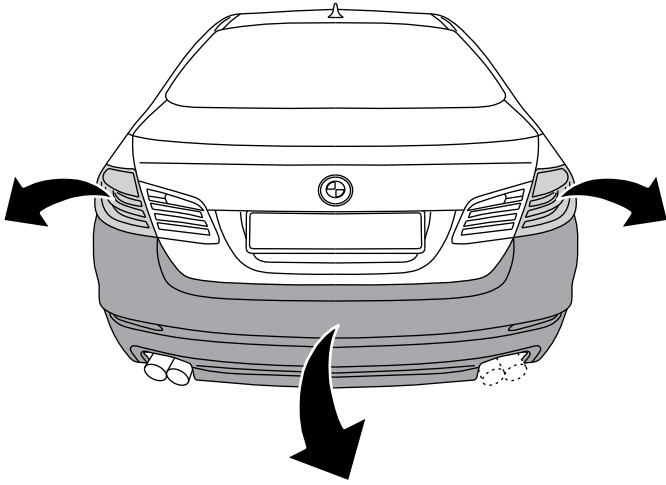

⚠ Touring ⚠

02

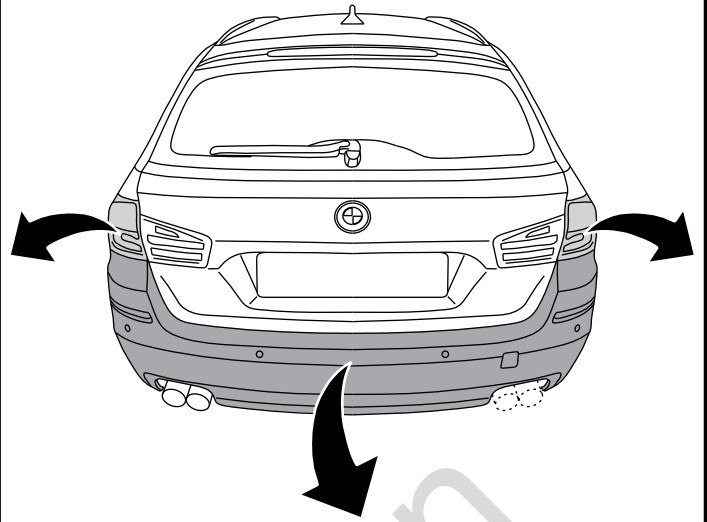

⚠ Limousine ⚠

03

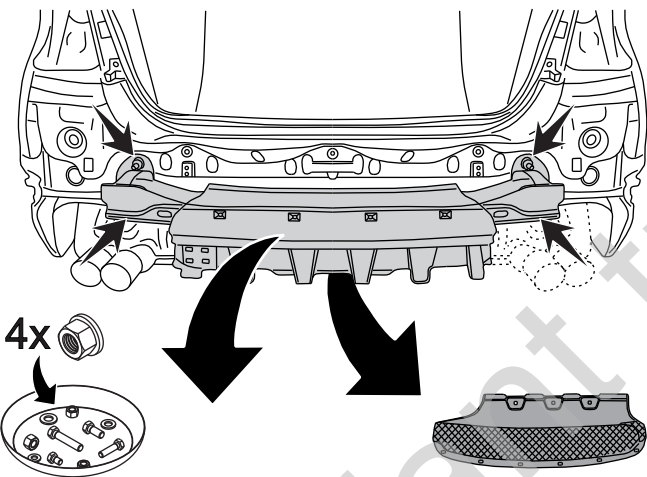

⚠ Limousine ⚠

04

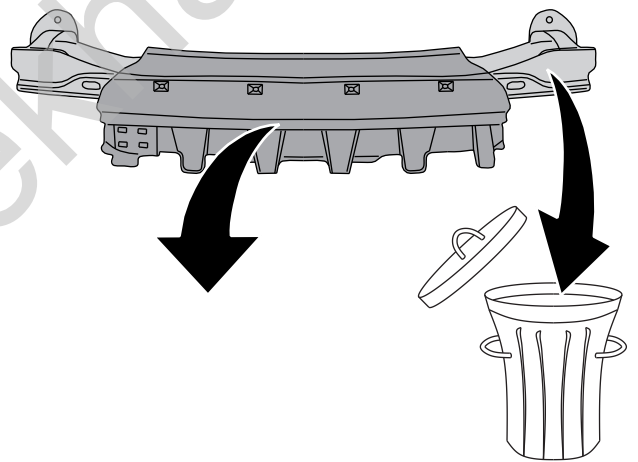

⚠ Touring ⚠

05

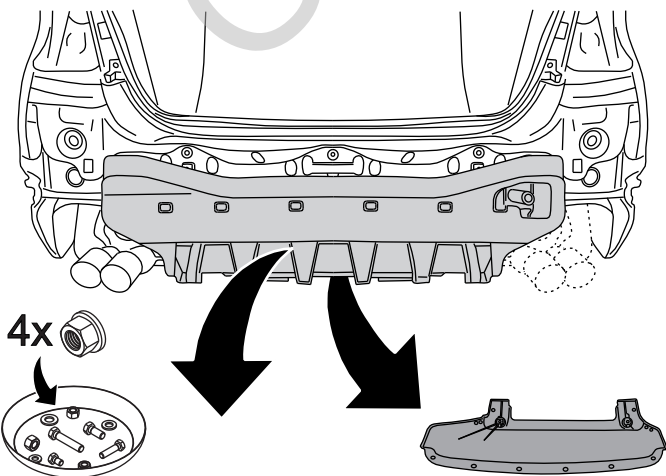

⚠ Touring ⚠

06

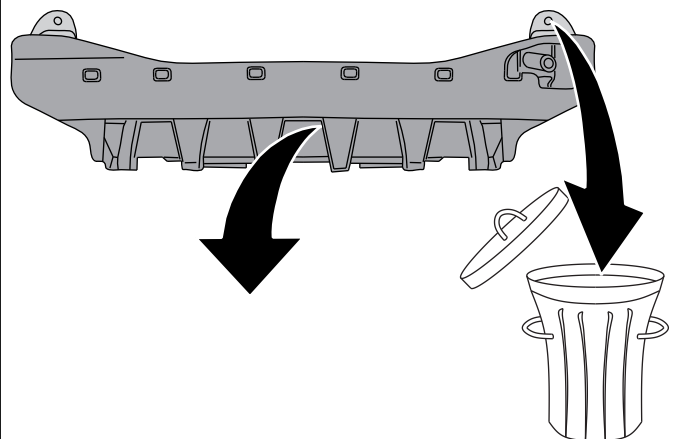

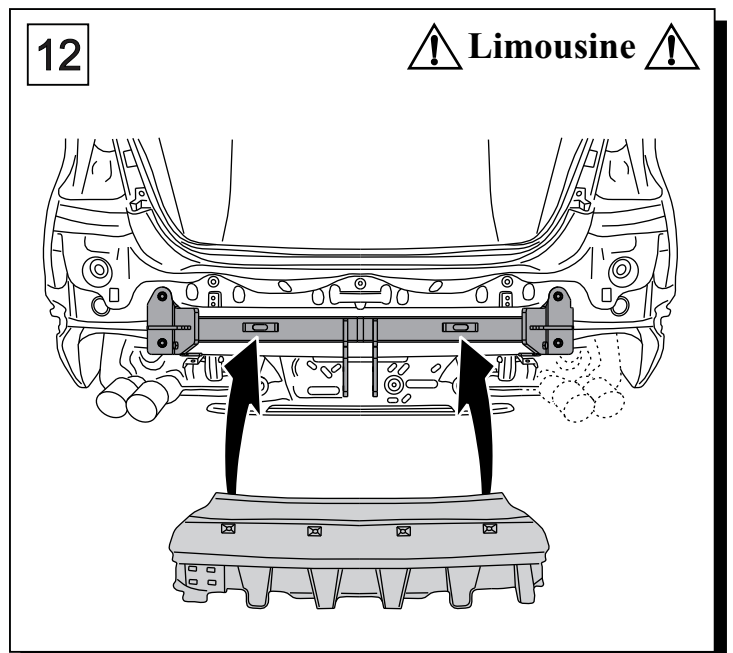
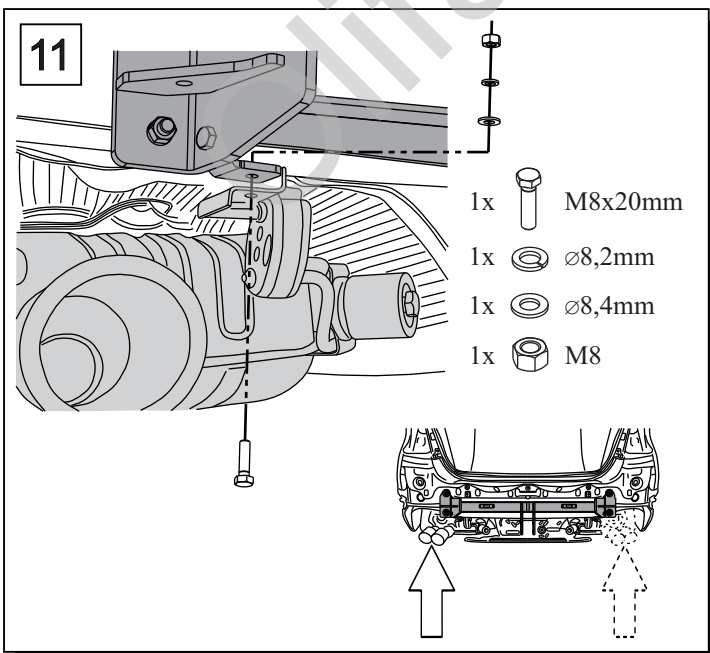
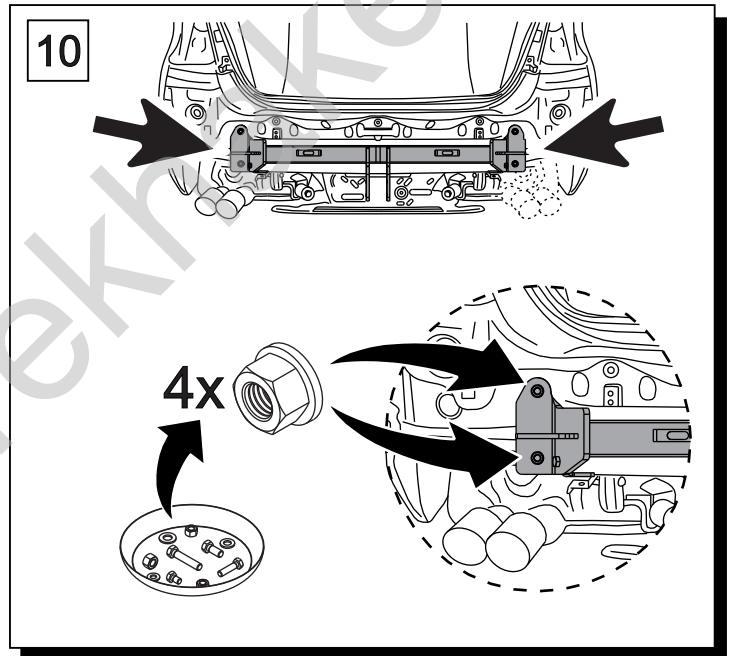
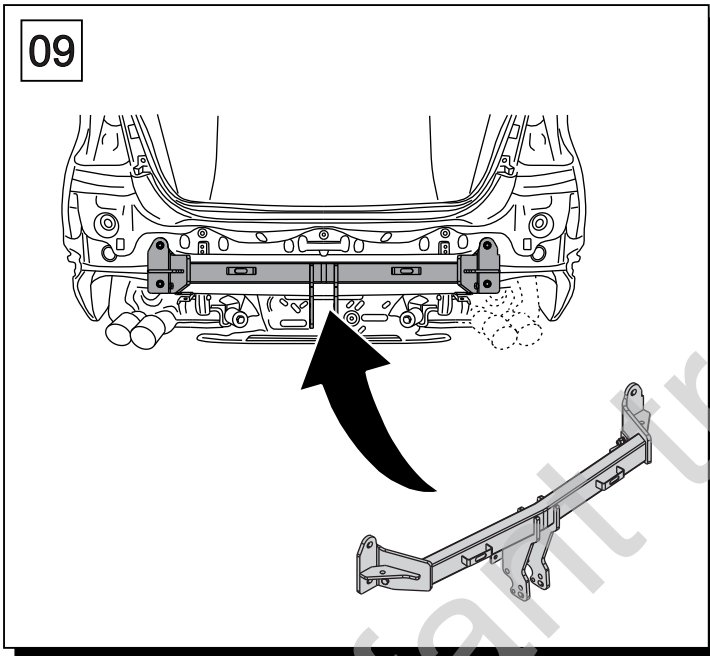
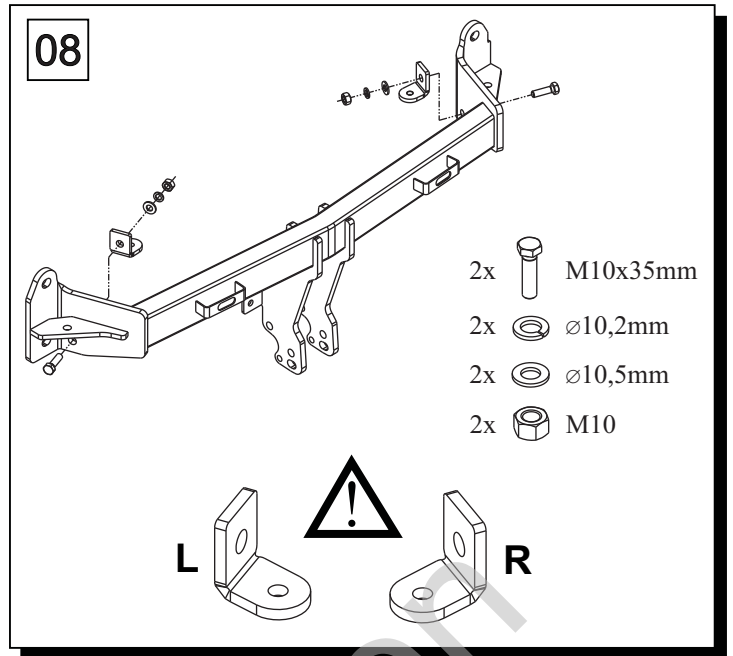
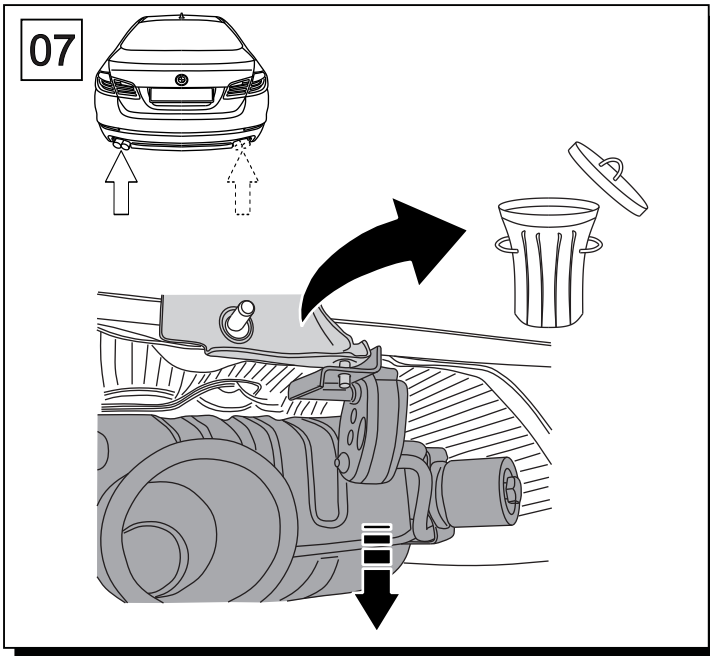

! Touring !

13

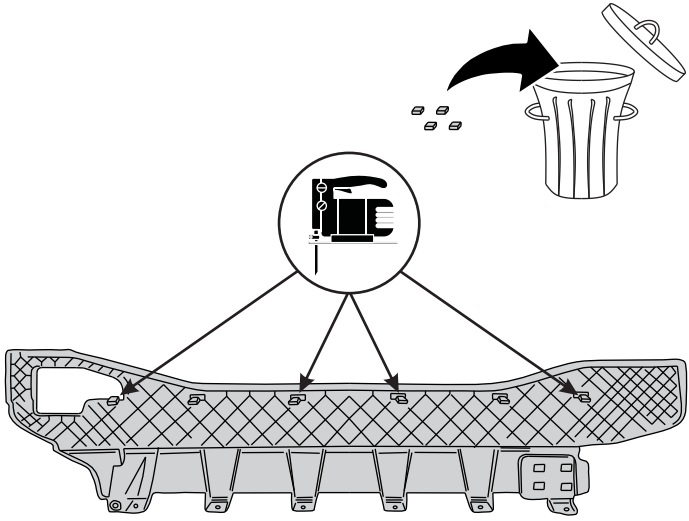

! Touring !

14

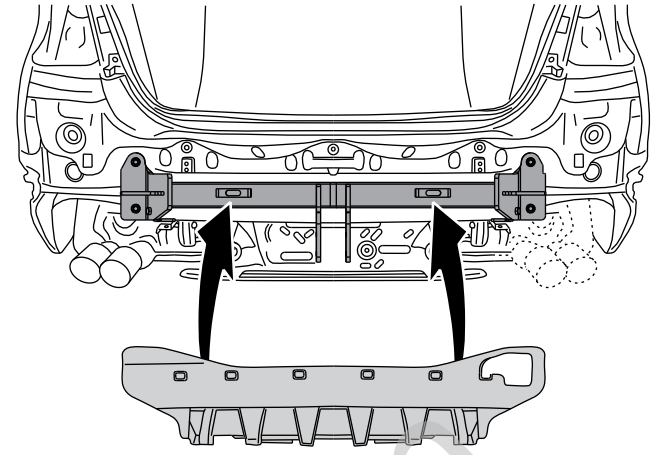

! Limousine !

15

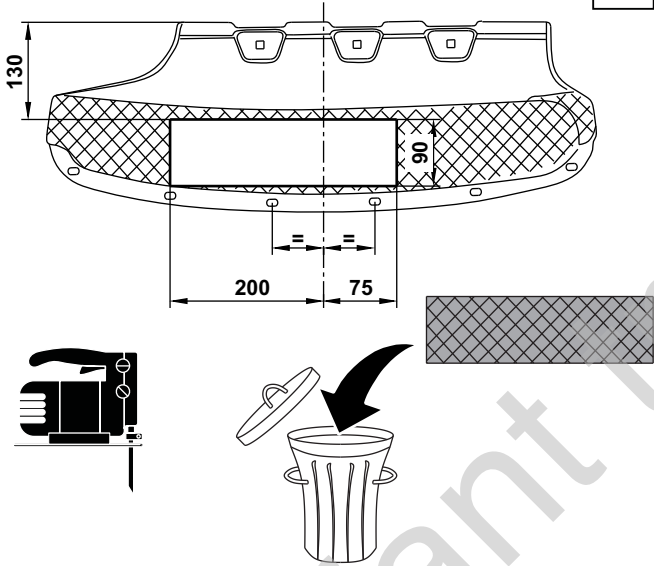

! Limousine !

16

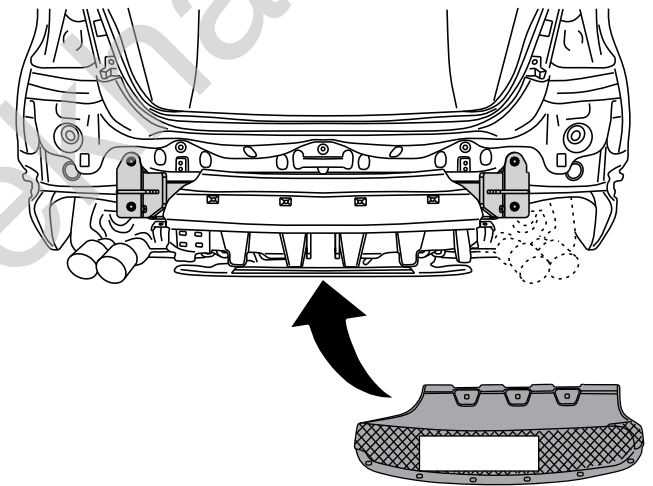

! Touring !

17

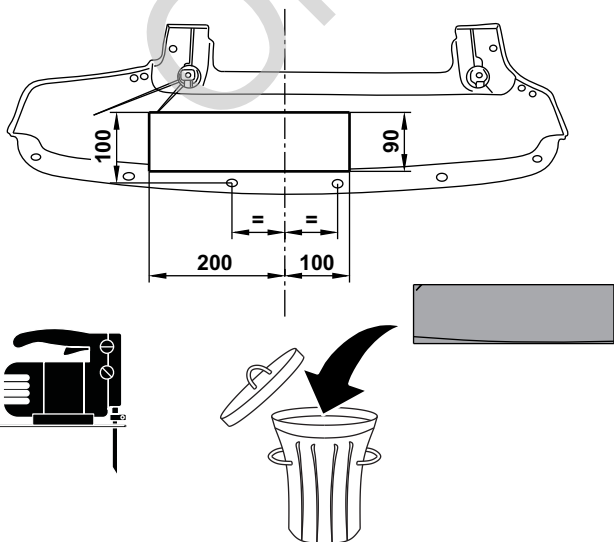

! Touring !

18

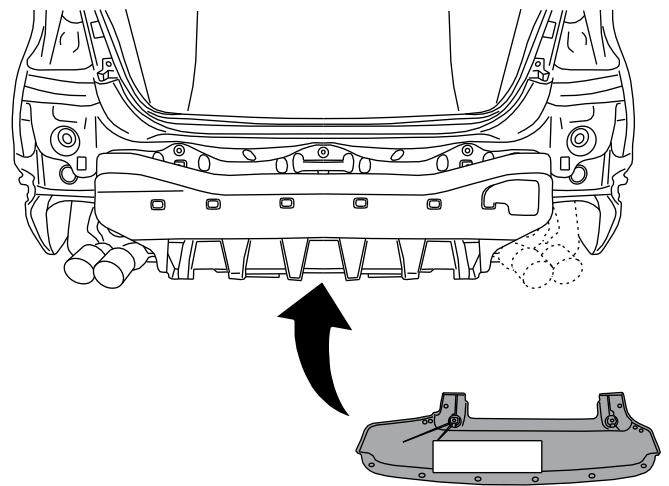

19

! Limousine !

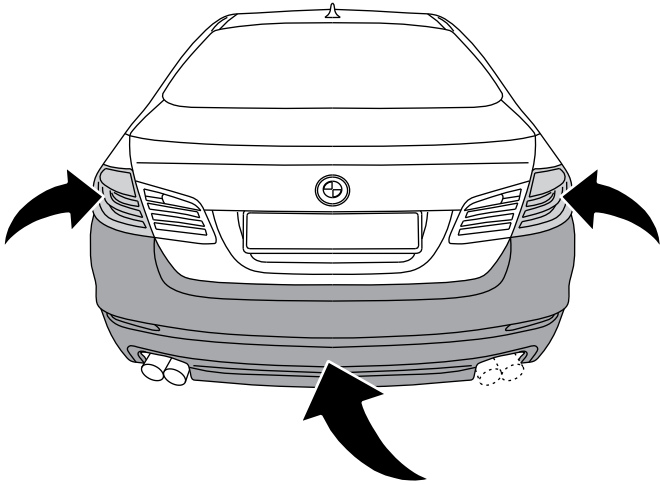

20

! Touring !

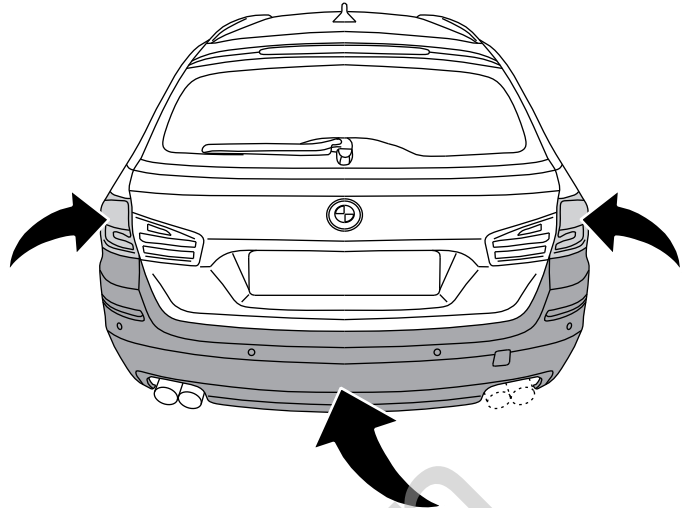

21

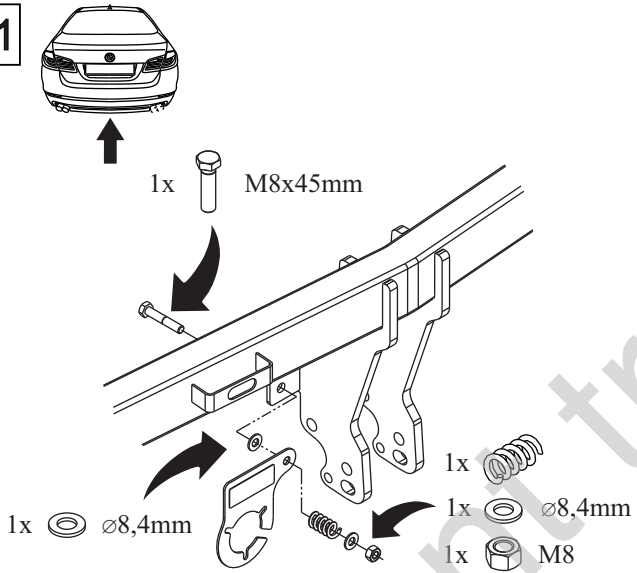

22

