

# PPUH AUTO-HAK Sp.J.

Henryk & Zbigniew Nejman  
ul. Słoneczna 16K 76-200 SŁUPSK  
POLAND

tel/fax +48 059 8-414-414; 8-414-413

e-mail: [office@autohak.com.pl](mailto:office@autohak.com.pl)

[www.autohak.com.pl](http://www.autohak.com.pl)



# AUTO-HAK



**TOYOTA URBAN  
CRUISER 4WD (P115)**

Cat. no:

**O78A**



04.2009 →

e20

e20\*94/20\*1274\*00



1,5h

D

6,1 kN

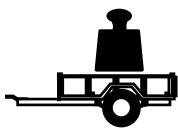

R=980 kg



S=50 kg



15,3 kg

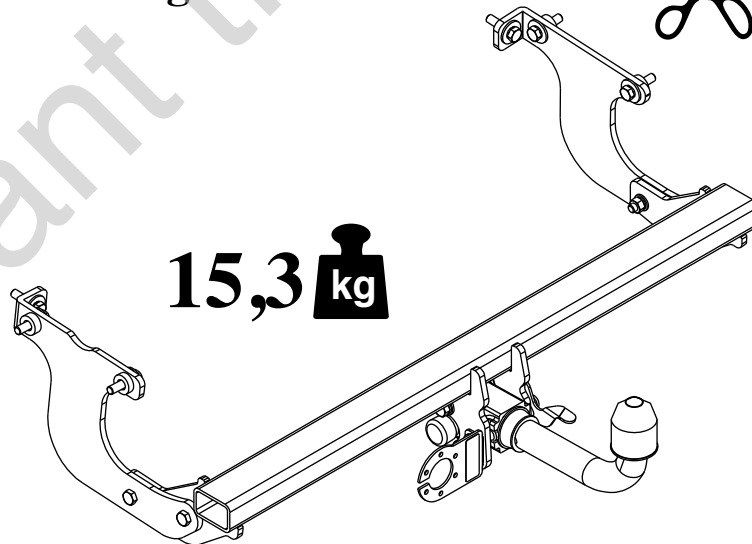

M6 - 11 Nm  
M10 - 50 Nm  
M14 - 138 Nm

M8 - 25 Nm  
M12 - 87 Nm  
M16 - 210 Nm









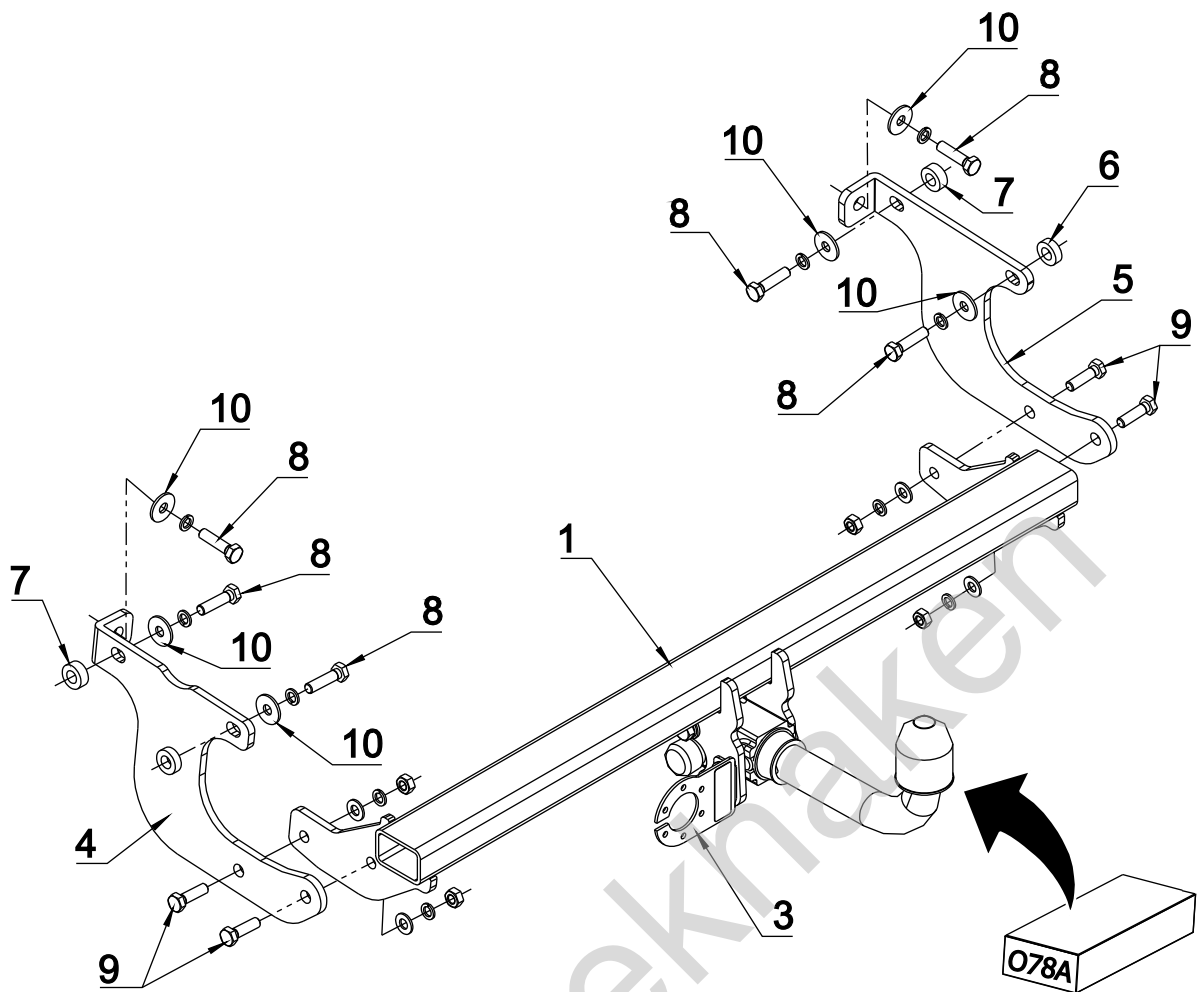

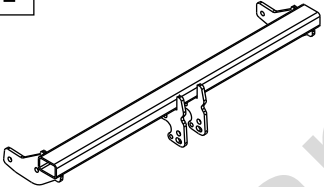

0 km →

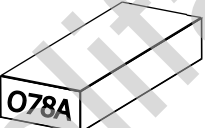

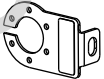
1000 km

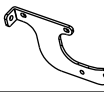

1		x 1		8 M10x1.25x40	x 6
				9 M10x35	x 4
				10 $\varnothing$ 30x $\varnothing$ 10.5x2.5 10 (DIN 9021)	x 6
2		x 1		11 $\varnothing$ 10.5	x 4
	Art.nr-KL1078A Art.nr-Z100			12 $\varnothing$ 10.2	x 10
3		x 1		13 M10	x 4
	Art.nr-BL1078A				
4		x 1			
5		x 1			
6		x 2		O25xO15mm, L=8mm	
7		x 2		O25xO15mm, L=10mm	

01

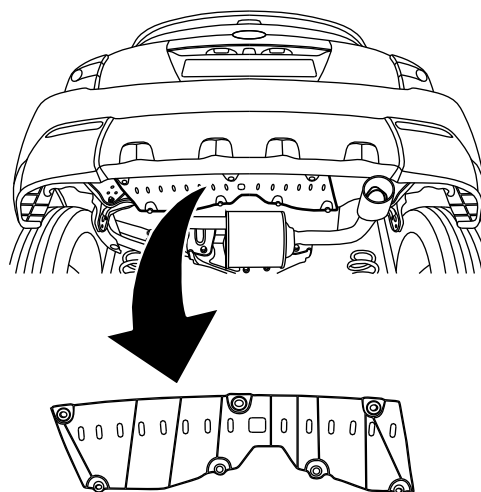
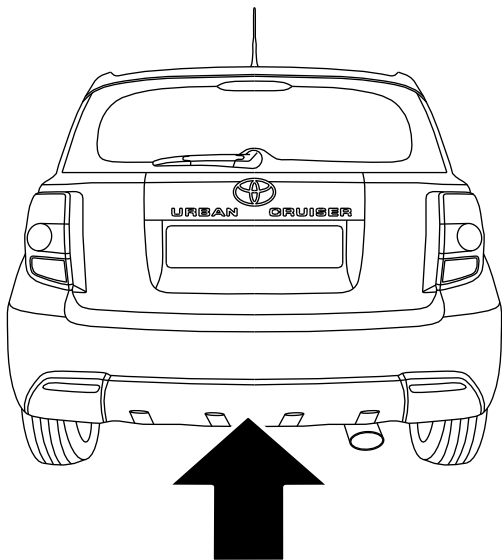

02

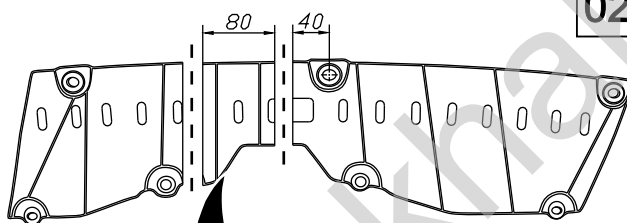





03

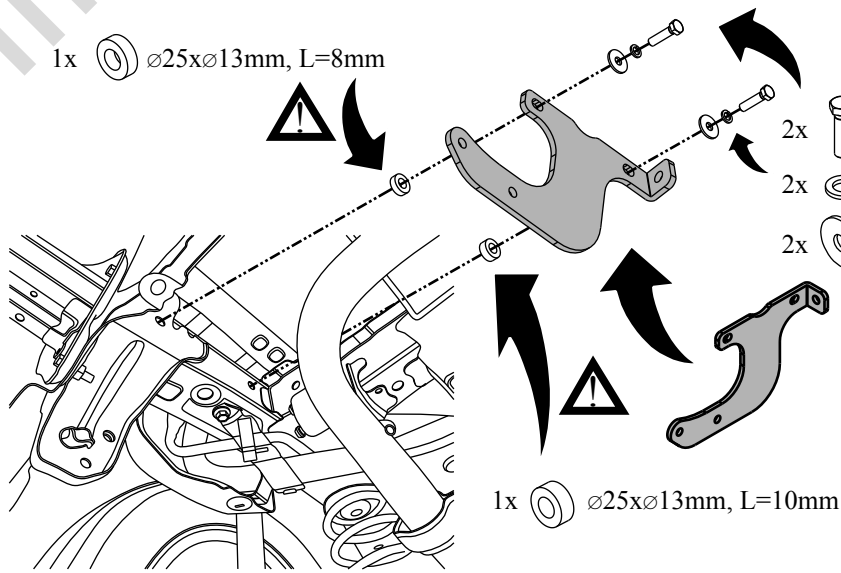

1x   $\varnothing 25 \times \varnothing 13 \text{mm}$ , L=8mm



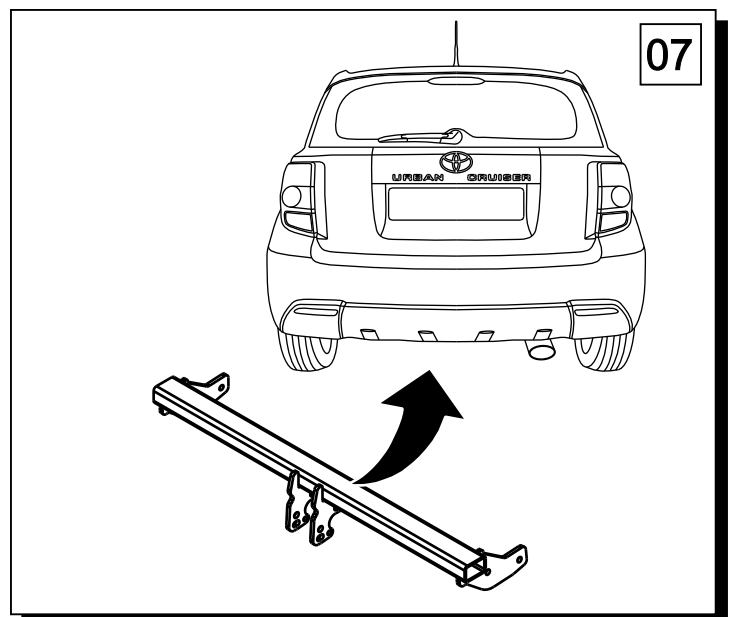
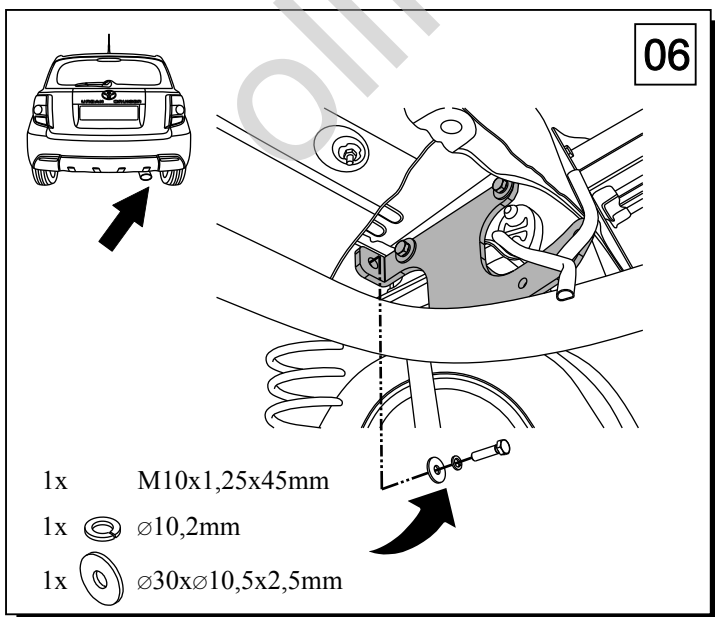
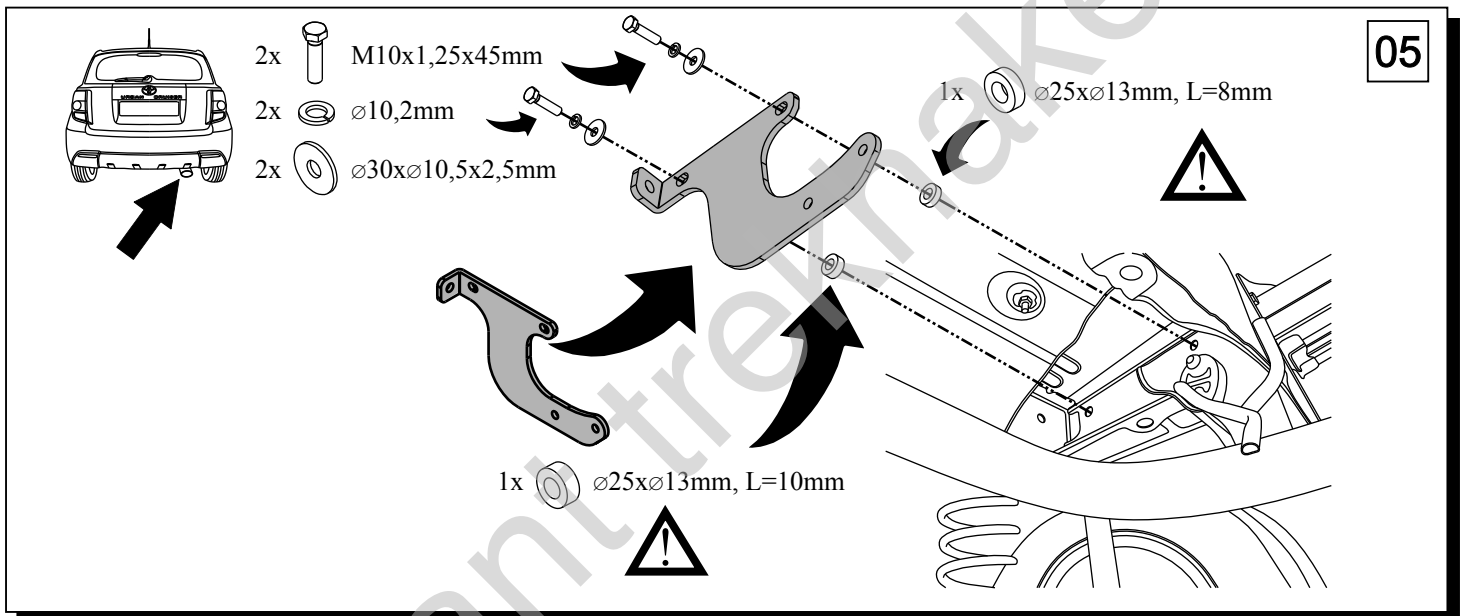
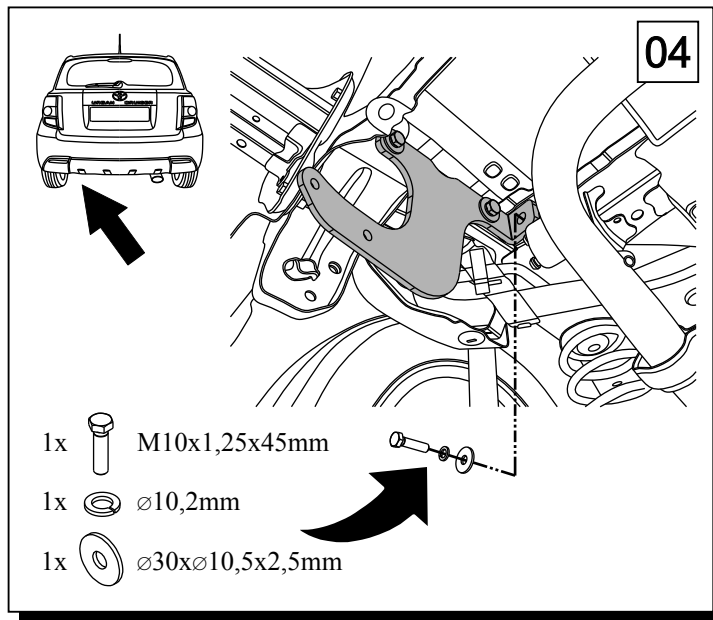

- 2x  M10x1,25x45mm
- 2x   $\varnothing 10,2 \text{mm}$
- 2x   $\varnothing 30 \times \varnothing 10,5 \times 2,5 \text{mm}$

1x   $\varnothing 25 \times \varnothing 13 \text{mm}$ , L=10mm

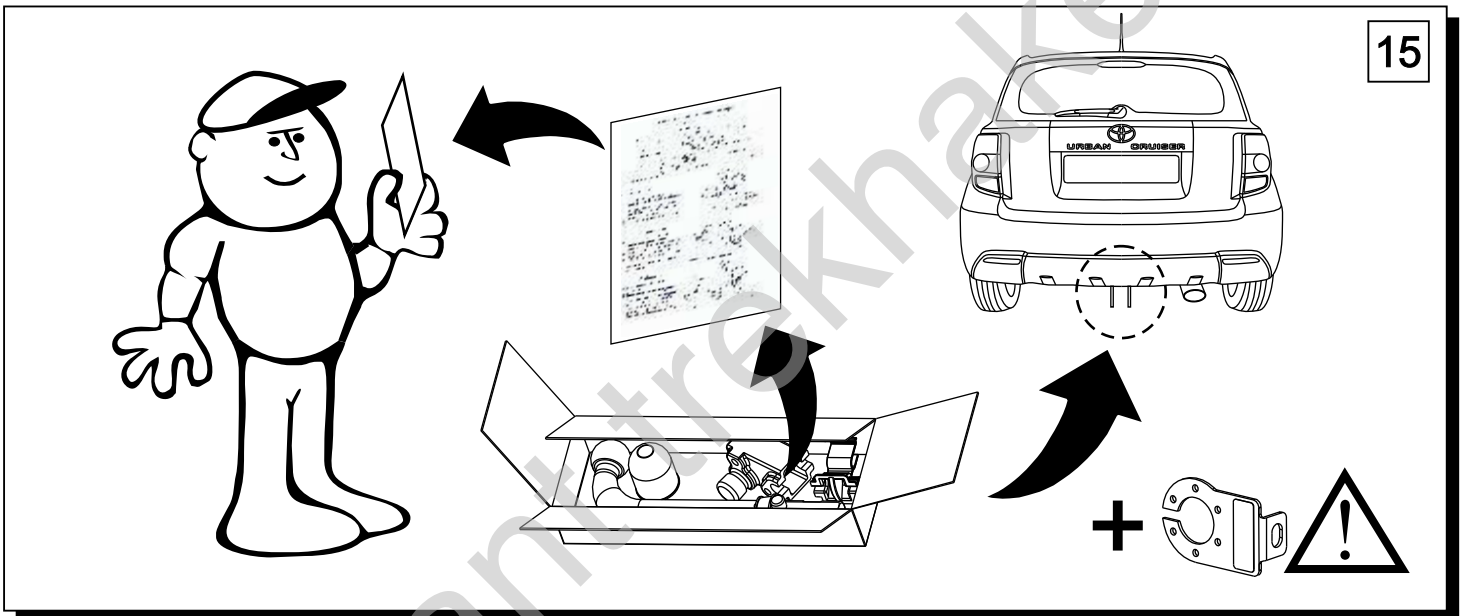
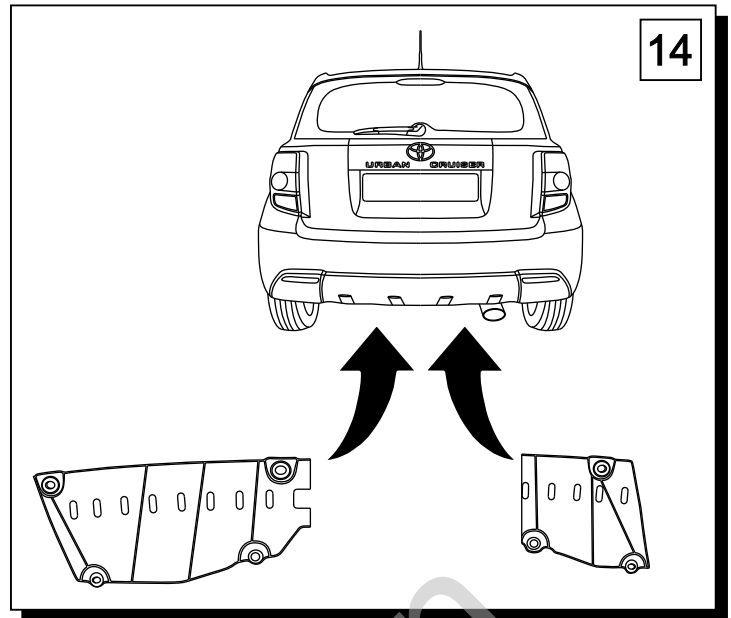
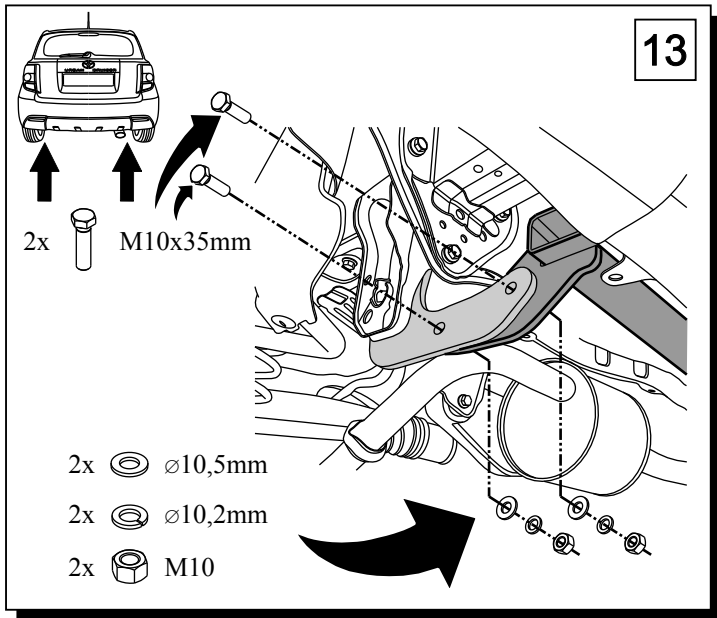



	<b>M6</b> - 11 Nm	<b>M8</b> - 25 Nm
	<b>M10</b> - 50 Nm	<b>M12</b> - 87 Nm
	<b>M14</b> - 138 Nm	<b>M16</b> - 210 Nm

 **0 km** → **1000 km**