

33-100 Tarnów ul.Przemysłowa 27a
www.steinhof.pl

Skoda Octavia IV (5D)
Skoda Octavia IV (Kombi/Estate),
(+Smart opener system)

(01/2020 - →)

(11/2019 - →)

S-351

- PL** **Urządzenie sprzęgające** Instrukcja montażu i eksploatacji
- GB** **Coupling device** Installation and operating instructions
- D** **Kupplungsvorrichtung** Montage- und Gebrauchsanleitung
- ES** **Del dispositivo de acoplamiento** Las instrucciones de instalación y de operación
- RU** **Тягово-сцепное устройство** Инструкция по установке и эксплуатации
- FR** **Dispositif d'accouplement** Notice de montage et d'utilisation
- IT** **Dispositivo accoppiamento** Istruzioni di montaggio
- CZ** **Spojovacího zařízení Tažné** Návod na montáž a použití
- RO** **Dispozitiv de cuplare** Instrucția de montaj și exploatare
- SE** **Kopplingsanordningens** Monterings- och bruksanvisningar.



YES

NO



YES

NO

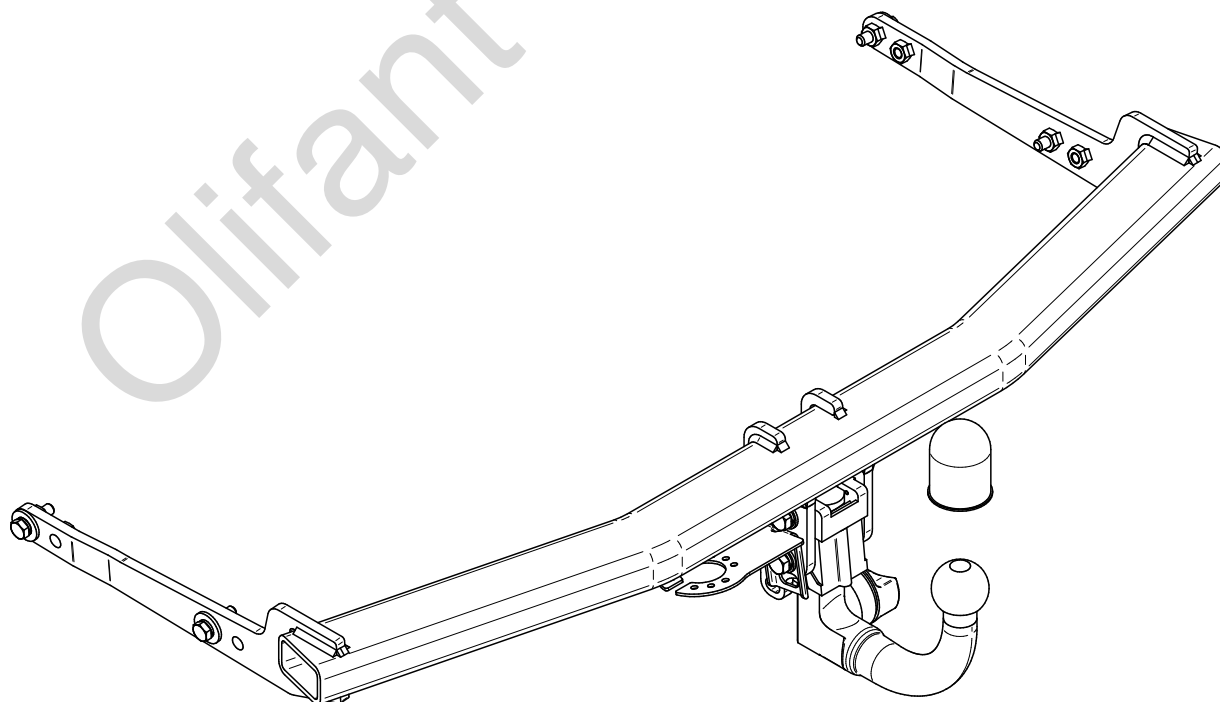

Typ: S-351

F

(E20) 55R-01 6038



D = 10,3kN

S = 100kg

A:
Skoda Octavia IV (Kombi/Estate) 

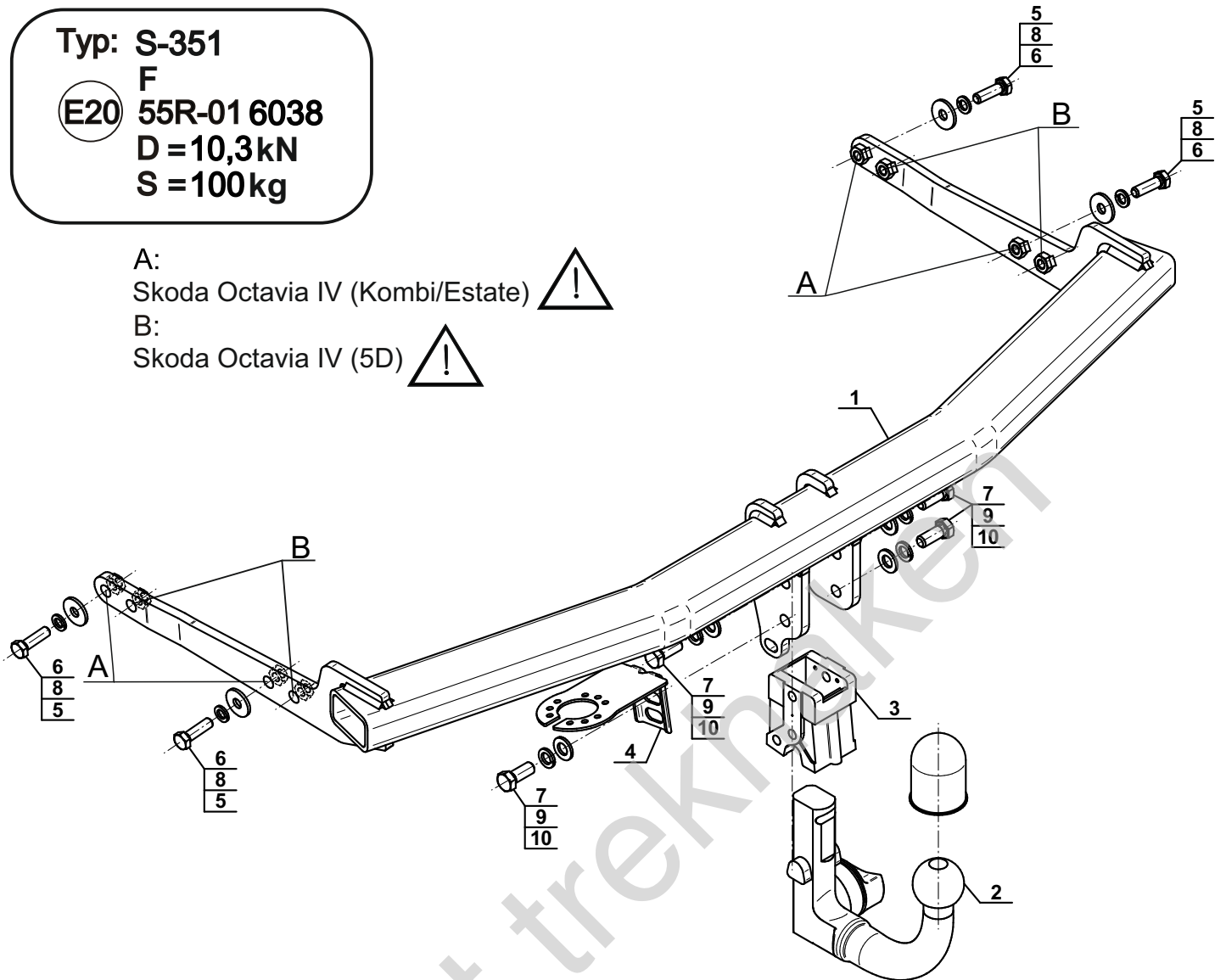
B:
Skoda Octavia IV (5D) 

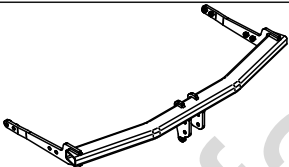
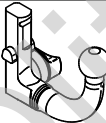
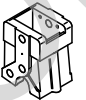

1		x1
2		x1
3		x1
4		x1

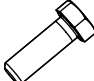
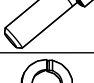
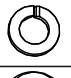
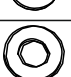
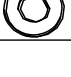
5		Ø30/Ø10,5x3	x4
6		M10x35 (PN/M-82105) (8.8)	x4
7		M12x30 (PN/M-82105) (8.8)	x4
8		Ø10,2	x4
9		Ø12,2	x4
10		Ø13,0	x4



8.8	
M6 - 10 (Nm)	M12 - 85 (Nm)
M8 - 25 (Nm)	M14 - 135 (Nm)
M10 - 50 (Nm)	M16 - 200 (Nm)

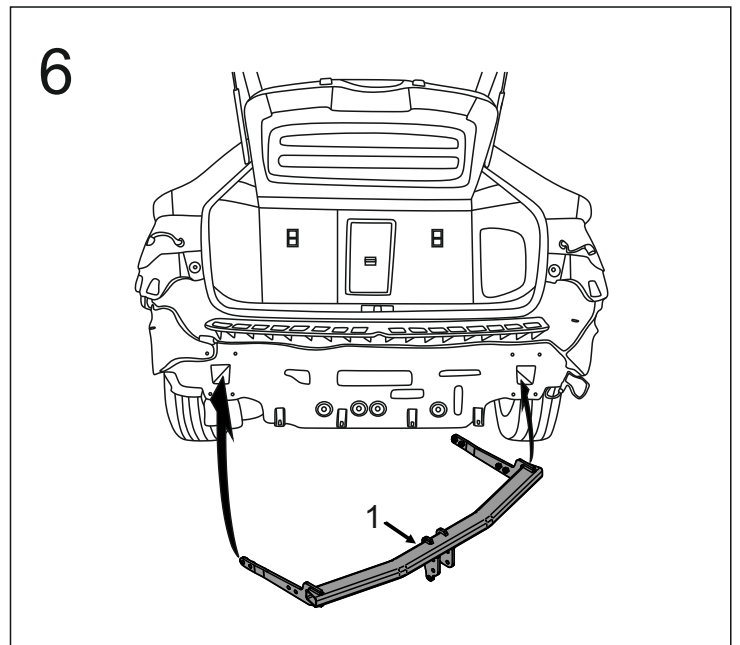
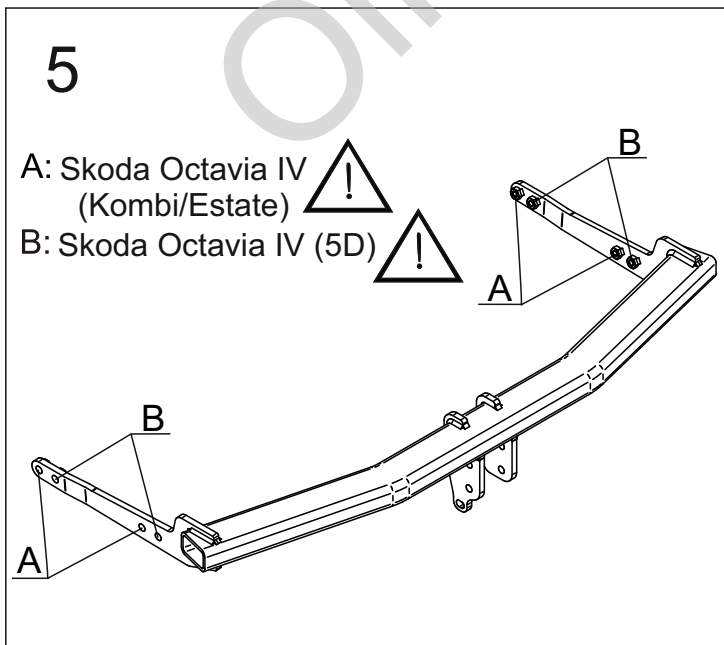
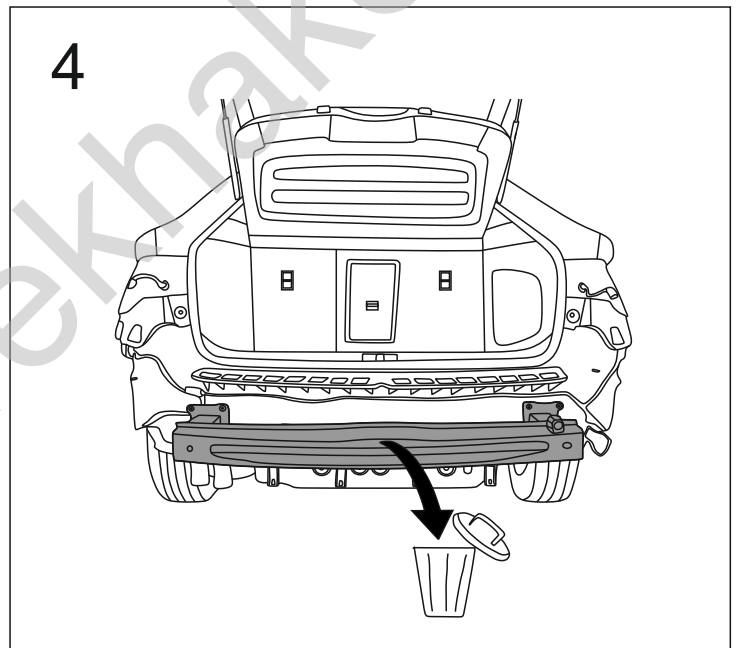
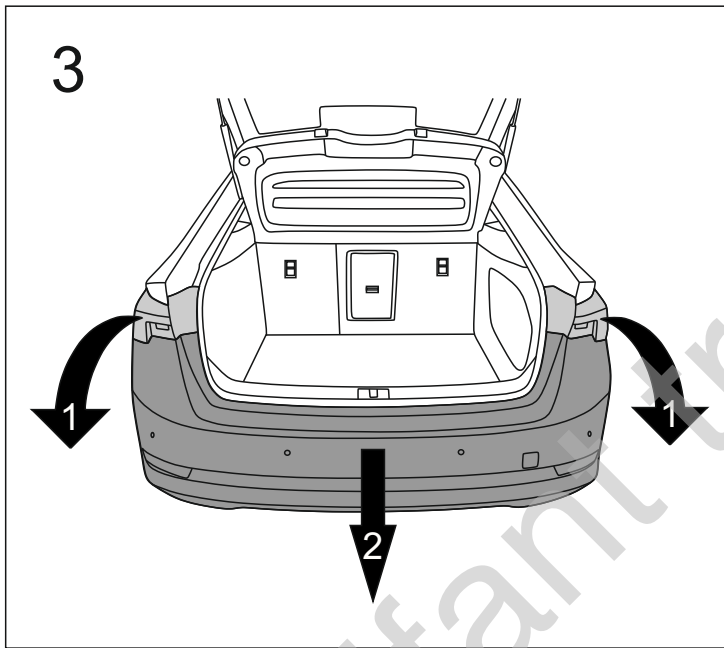
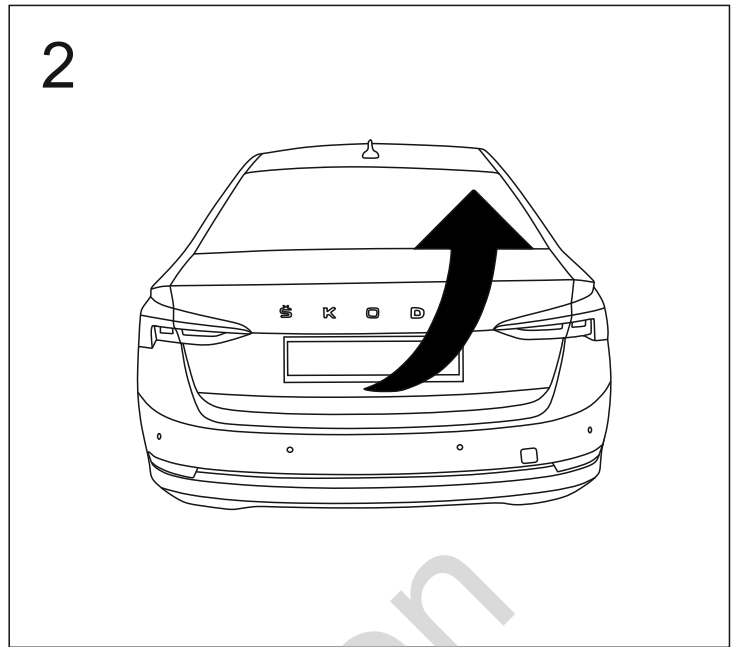
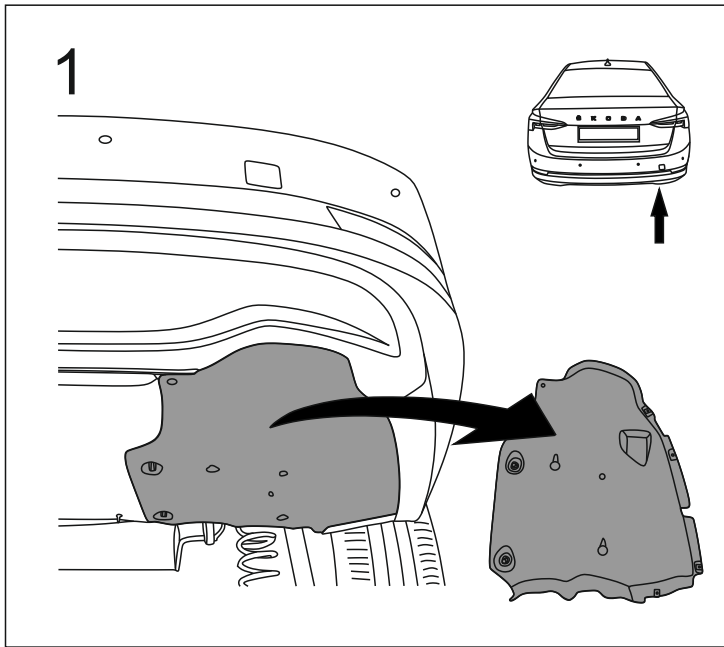

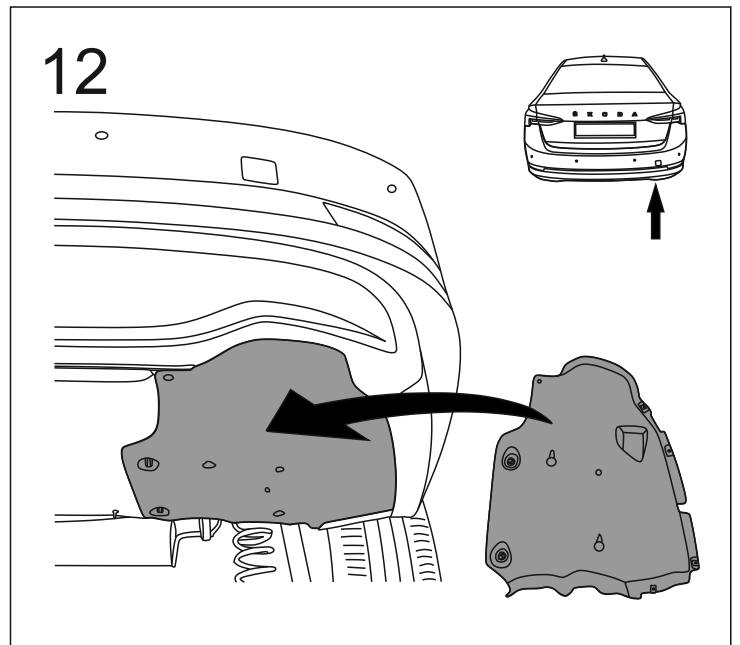
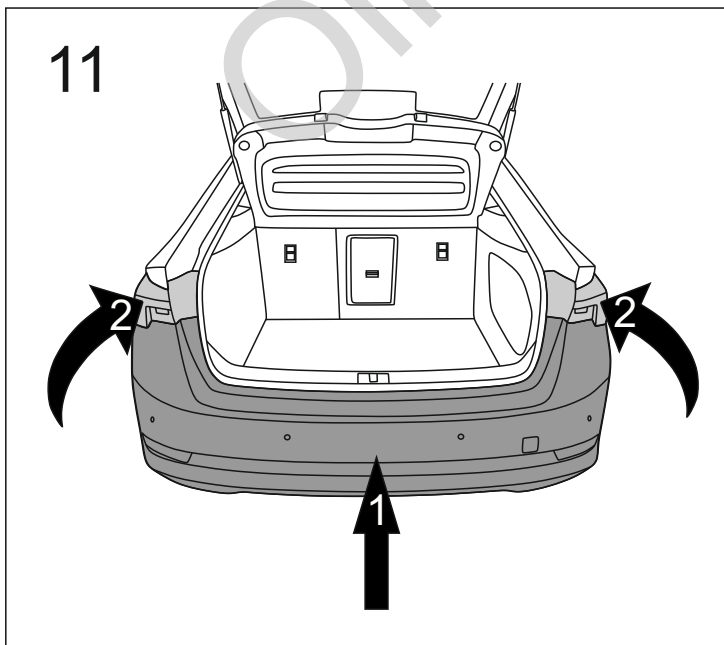
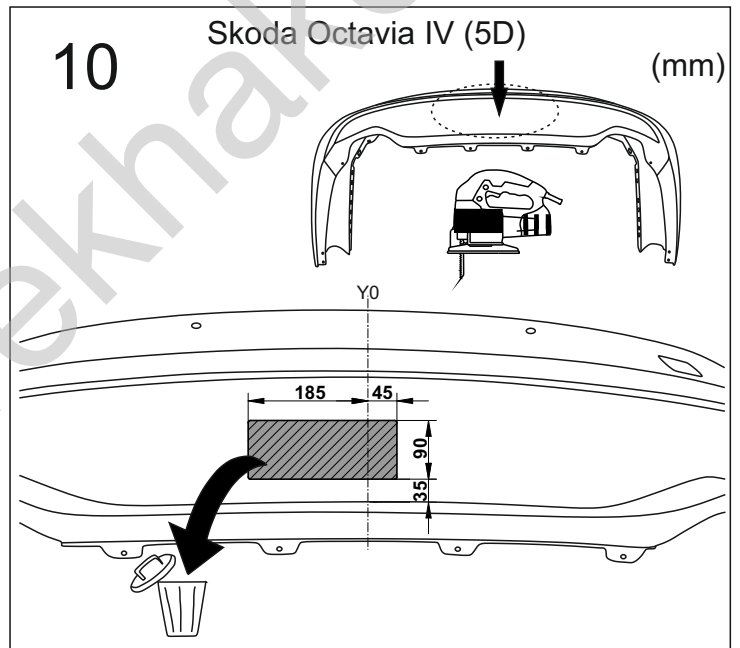
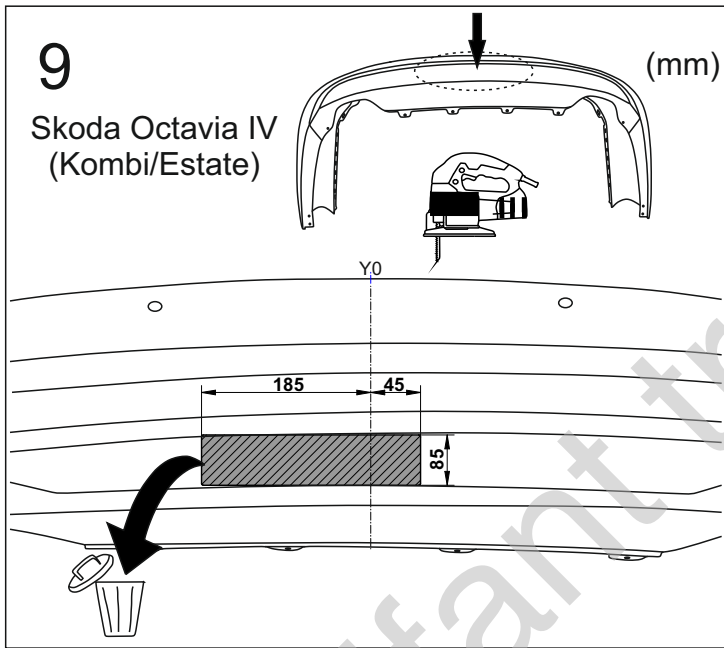
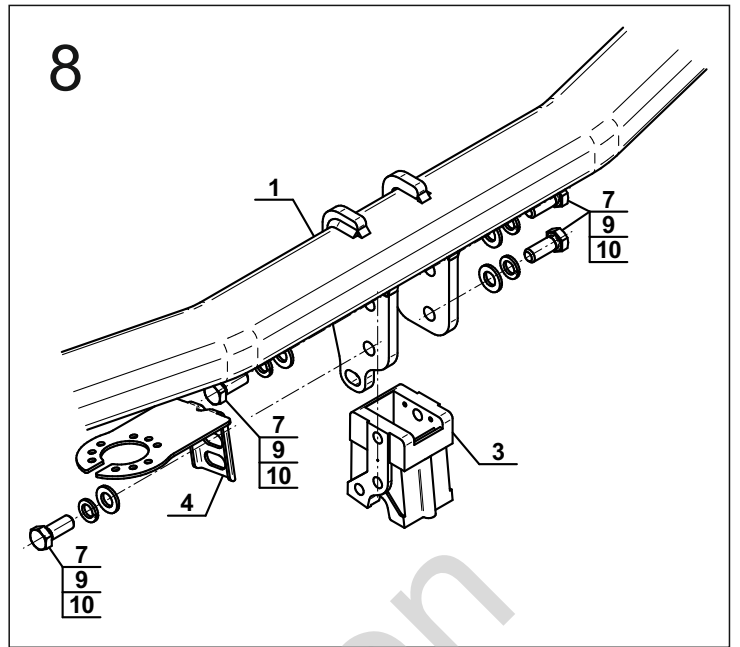
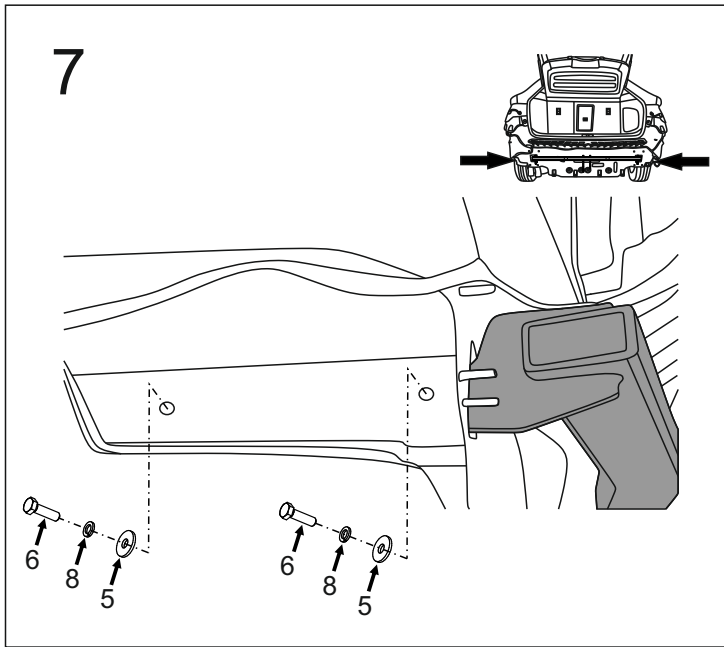

13

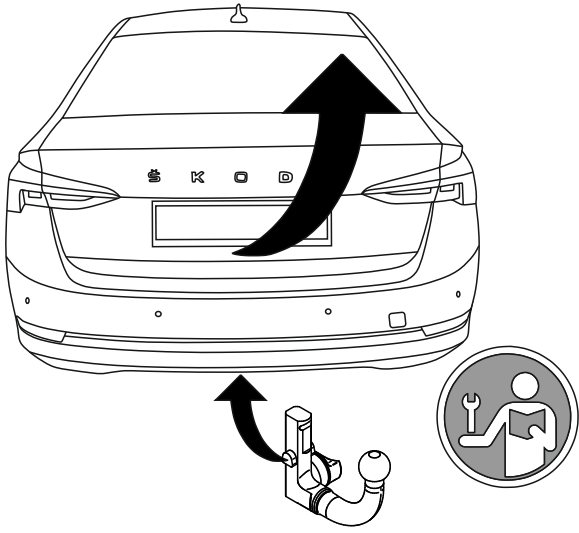

Olifant trekhaken