

# PPUH AUTO-HAK Sp.J.

Henryk i Zbigniew Nejman  
ul. Słoneczna 16K 76-200 SŁUPSK  
POLAND

tel/fax +48 59 8 414 414; +48 59 8 414 413

e-mail: [office@autohak.com.pl](mailto:office@autohak.com.pl)

[www.autohak.com.pl](http://www.autohak.com.pl)



# AUTO-HAK



**HONDA CIVIC 5D**

Cat. no:

**Y37A**



01.2012 → 12.2014

**e20**

**e20\*94/20\*1682\*00**

**D**

8,32 kN



**2h**



R=1500 kg



S=75 kg

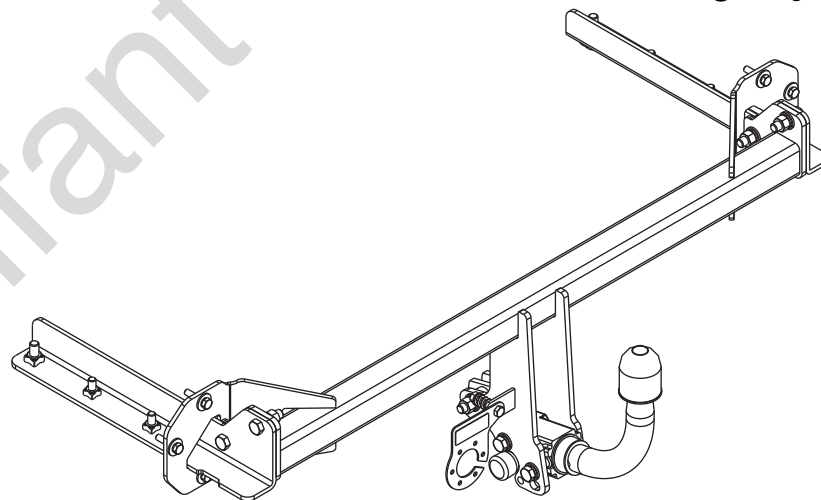

M6 - 8,5 Nm  
M10 - 41 Nm  
M14 - 112 Nm

M8 - 20 Nm  
M12 - 70 Nm  
M16 - 170 Nm



0 km →



1000 km

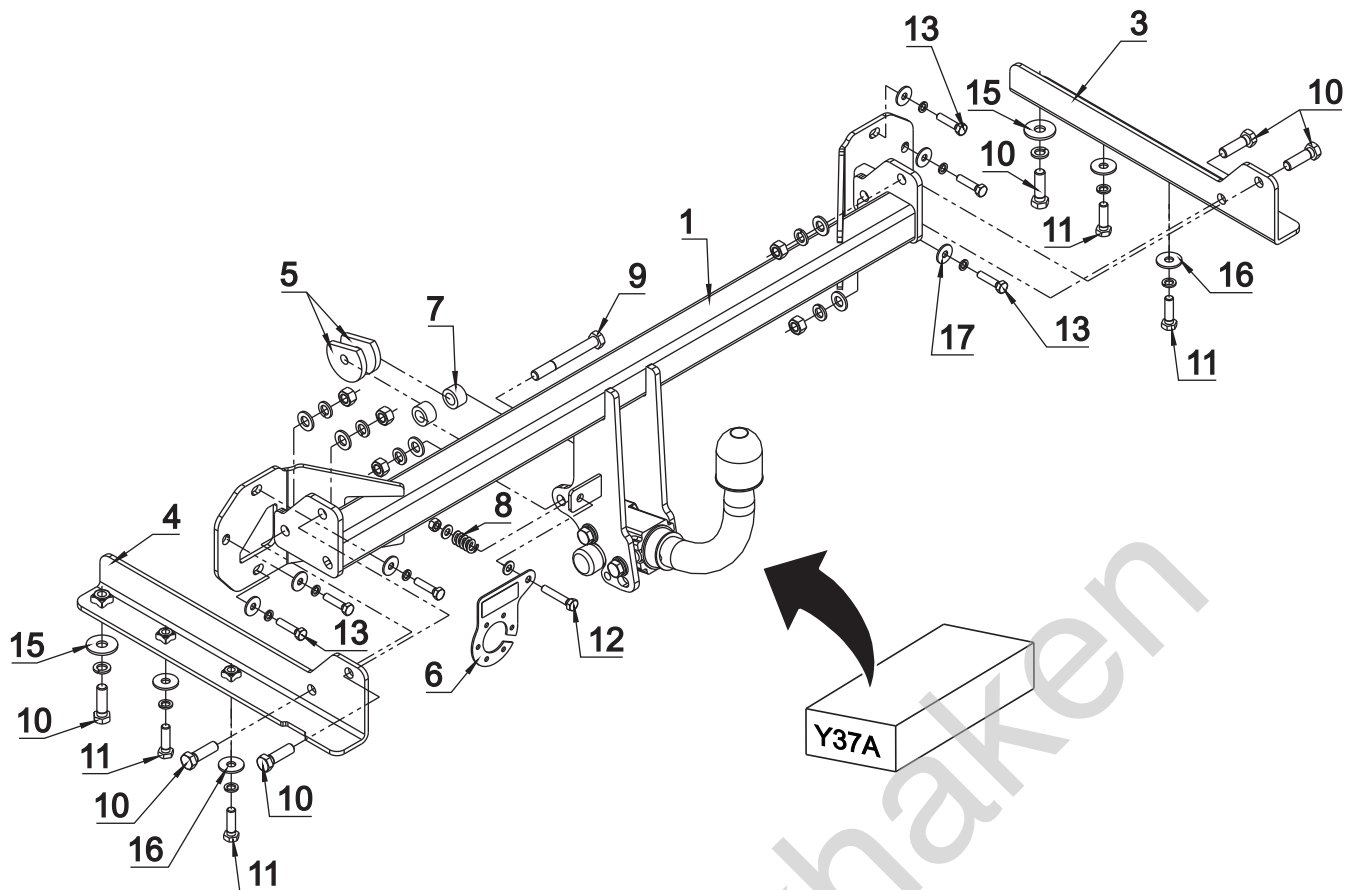

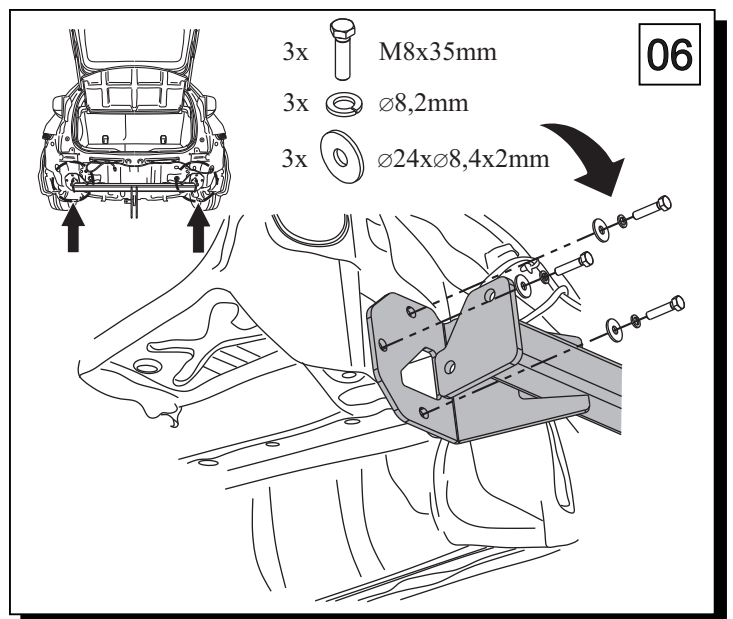
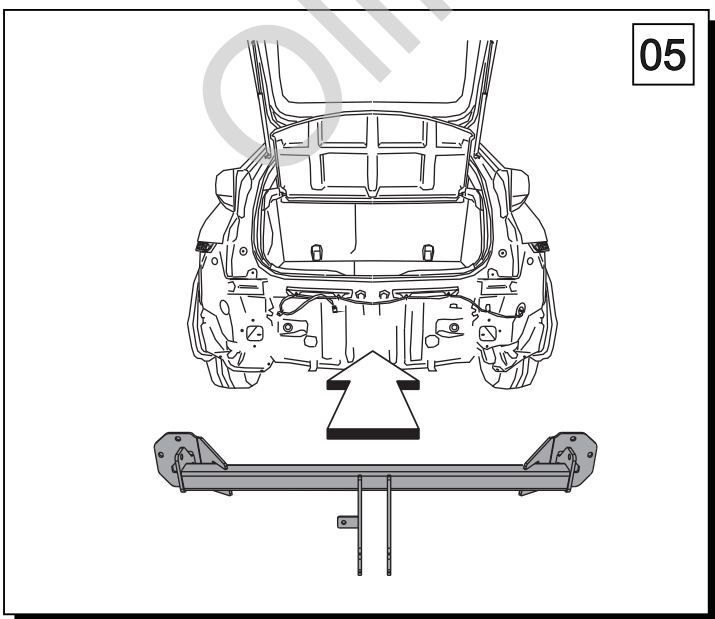
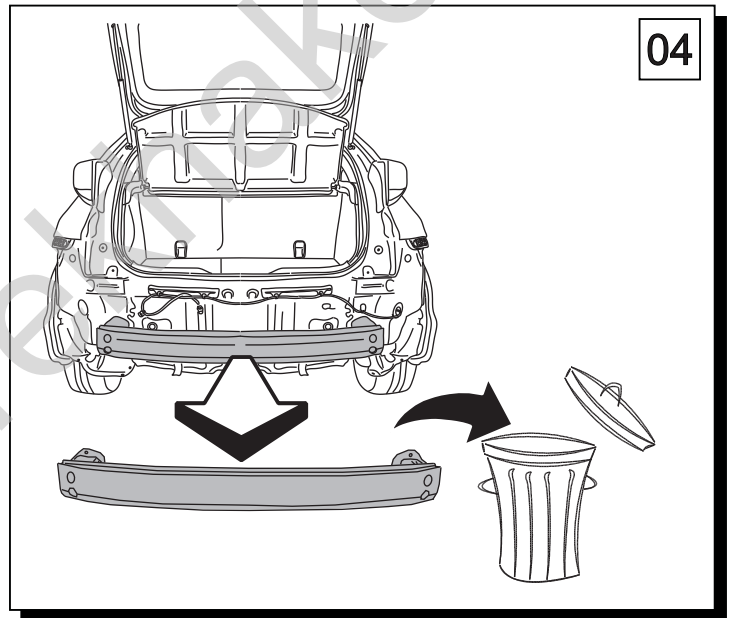
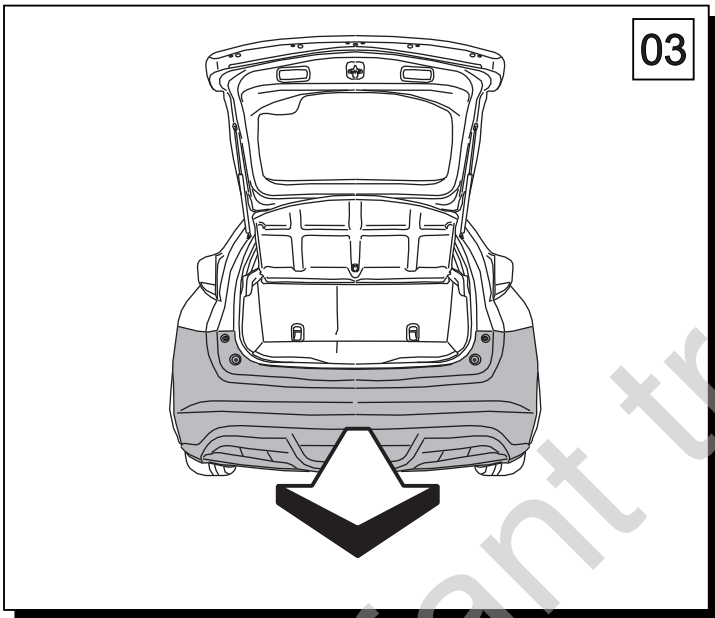
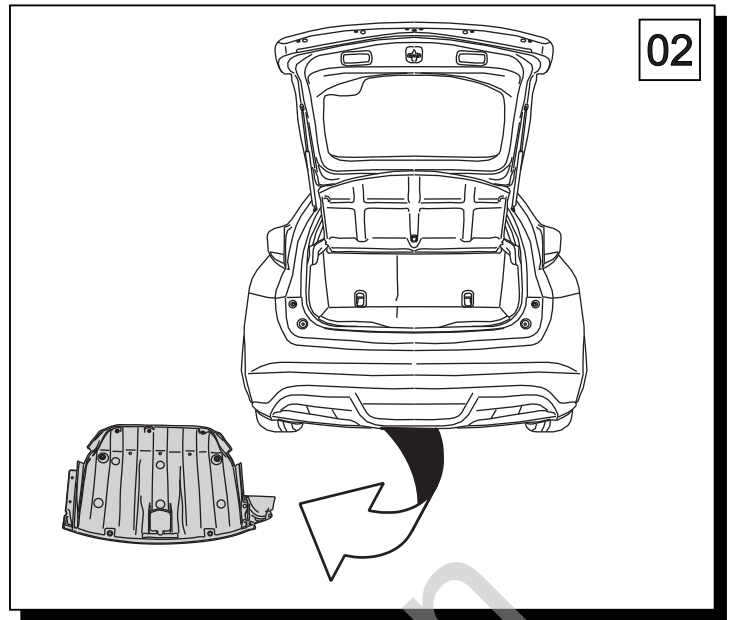
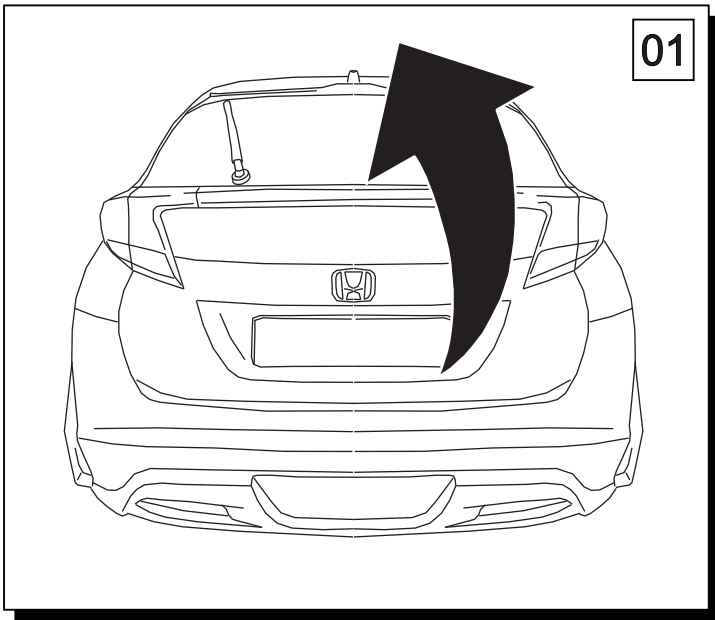

1	x1		9	M12x100	x1
2	x1	 Art.nr-KL1Y37A	10	M12x40	x6
			11	M10x35	x4
3	x1		12	M8x45	x1
			13	M8x35	x6
4	x1		14	∅ 13	x5
			15	∅ 37x∅13x3 13 (DIN 9021)	x2
5	x2		16	∅ 30x∅10.5x2.5 10 (DIN 9021)	x4
			17	∅ 24x∅8.5x2 8 (DIN 9021)	x6
6	x1	 Art.nr-BL1Y37A	18	∅ 8.3	x2
			19	∅ 12.2	x5
7	x2	 ∅25x5mm L=15mm	20	∅ 10.2	x4
			21	∅ 8.2	x6
8	x1		22	M12	x5
			23	M8	x1

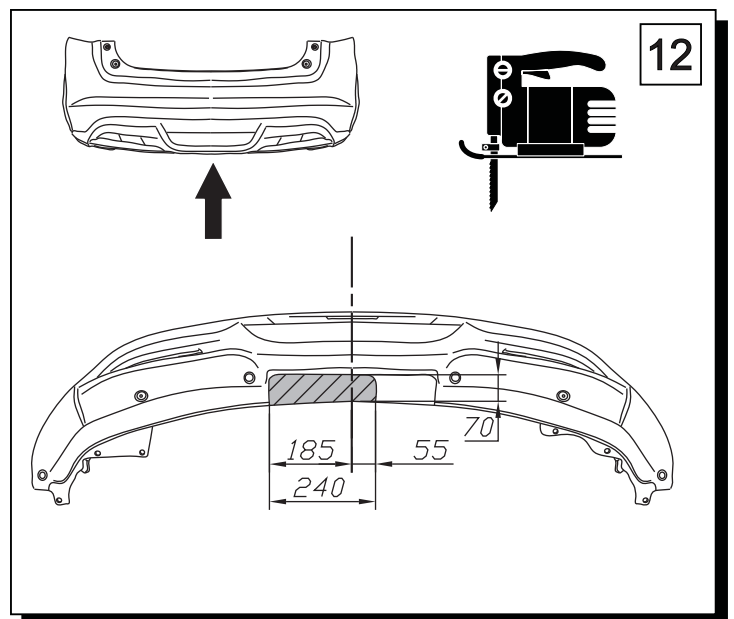
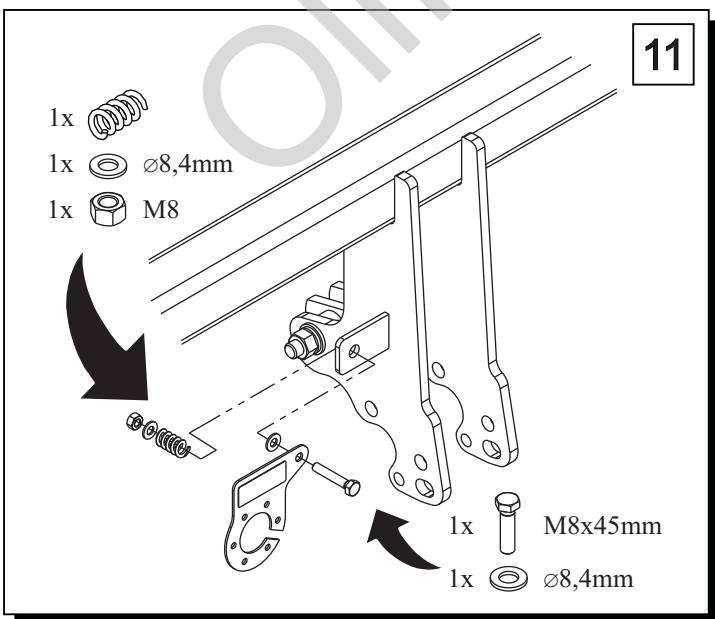
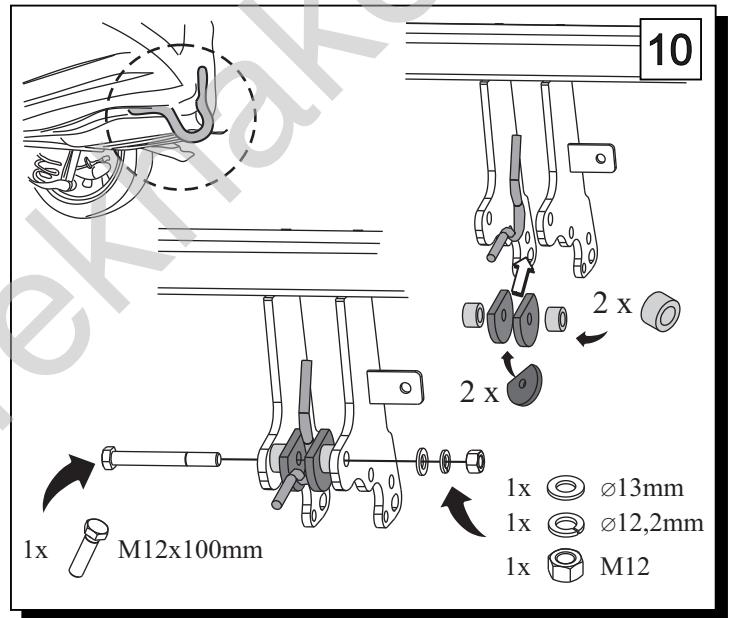
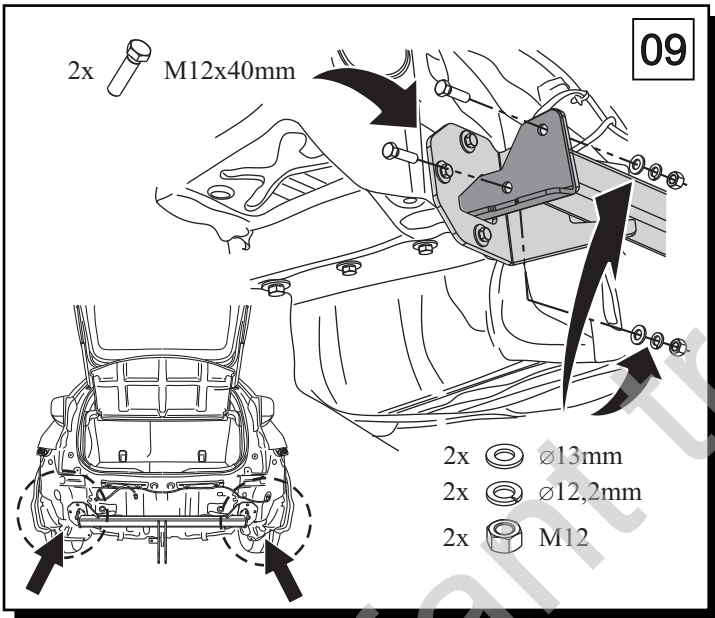
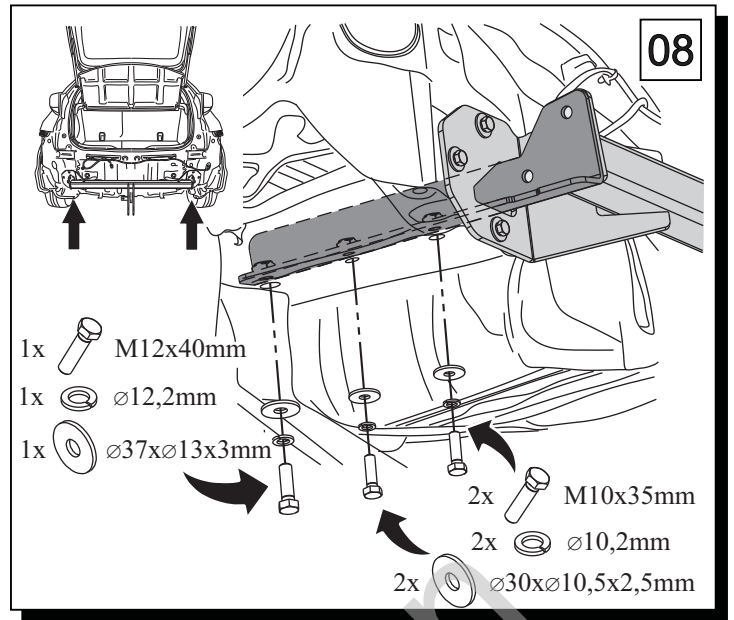
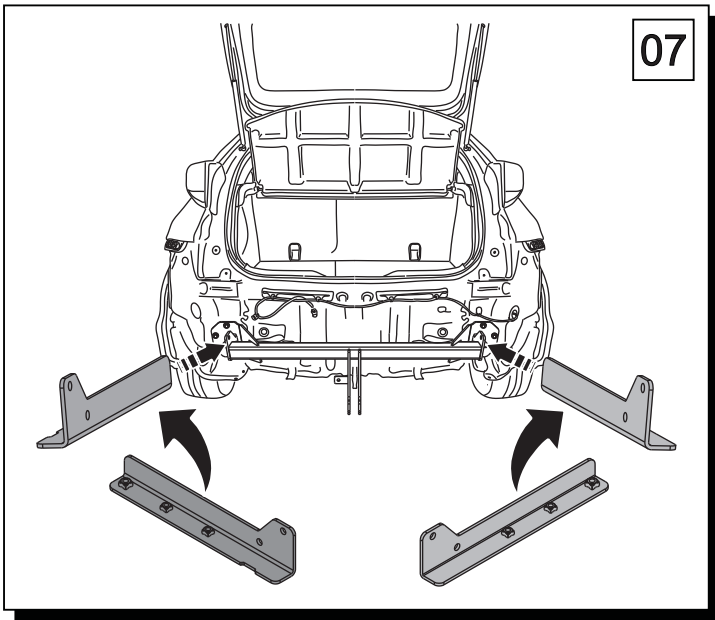

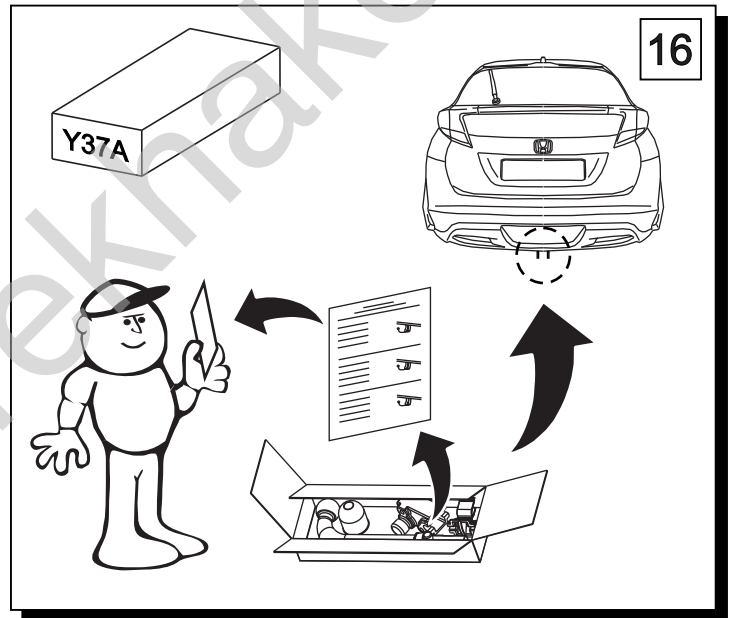
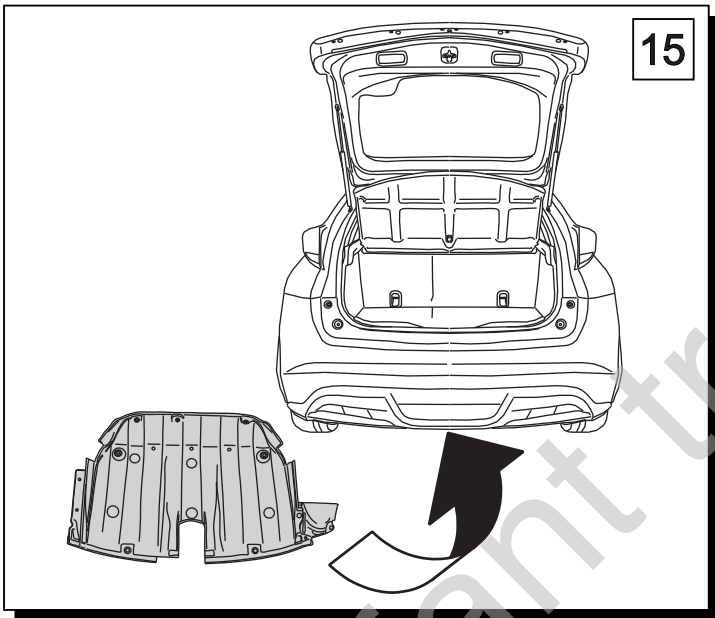
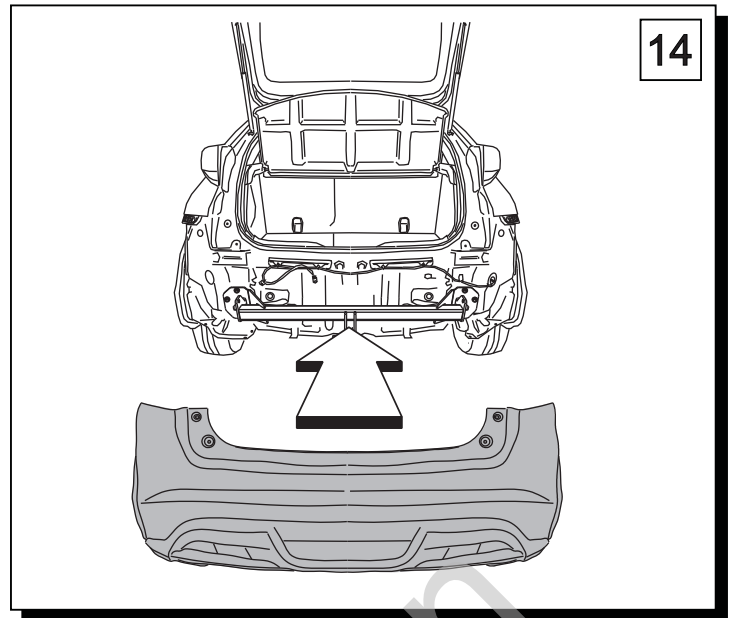
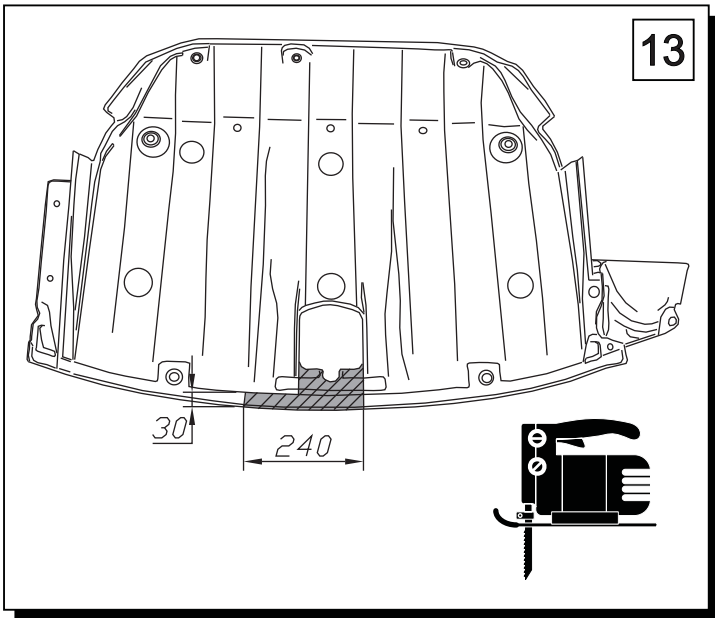



	<b>M6</b> - 11 Nm	<b>M8</b> - 25 Nm
	<b>M10</b> - 50 Nm	<b>M12</b> - 87 Nm
	<b>M14</b> - 138 Nm	<b>M16</b> - 210 Nm

 **0 km** →  **1000 km**