

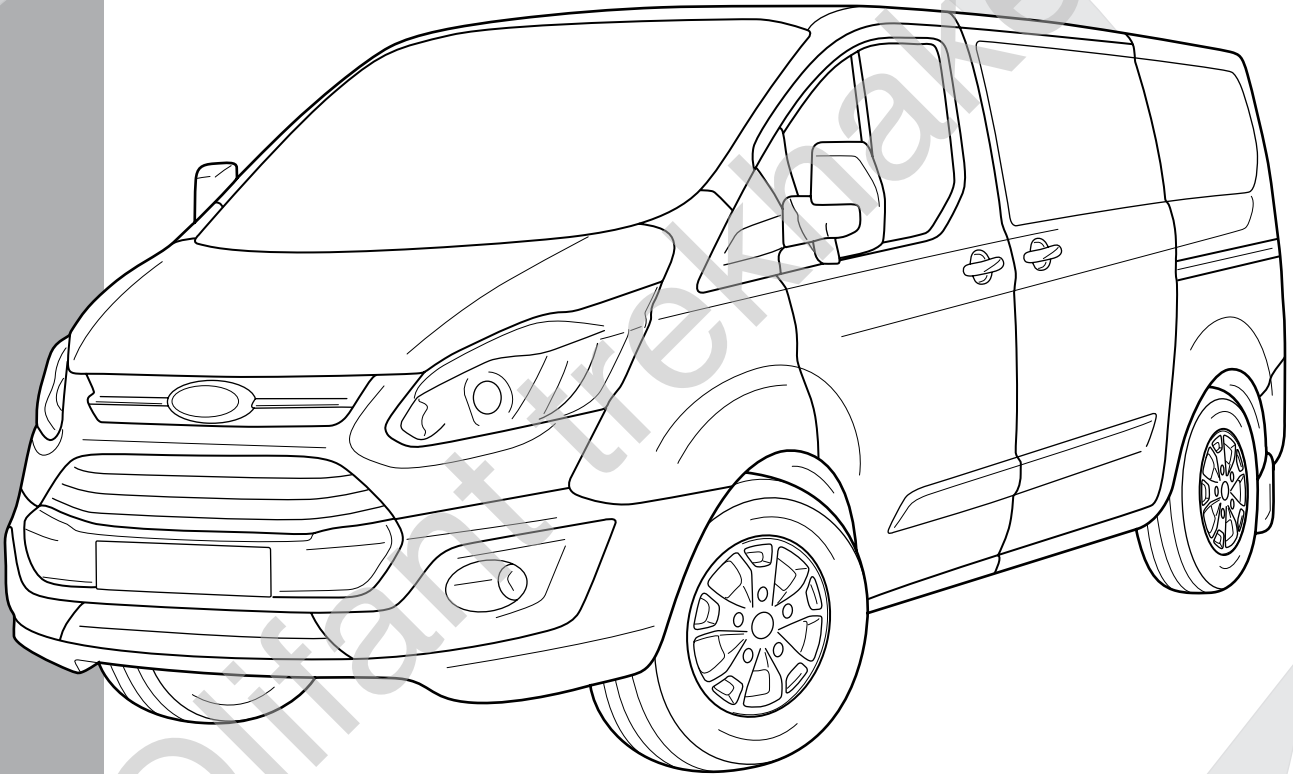

TREKHAKEN • ATTELAGES • ANHÄNGERVORRICHTUNGEN • TOWBARS • ENHANCES • ANHÆNGERTRÆK
Montagehandleiding | instructions de montage | Einbauanleitung | Mounting instruction
Instrucciones de montaje | monteringsvejledning



Ford Transit Custom Ford Tourneo Custom 12/'12-



IF THE SPARE WHEEL MOUNTING SYSTEM IS AT THE BOTTOM OF
THE VEHICLE, ALSO ORDER KIT **650.080**

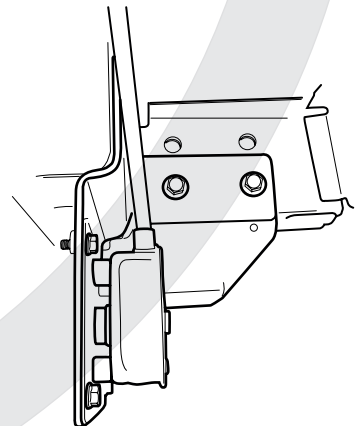

MADE BY



D 14,91

F

E6

BELGIUM

S 125

EC-N°

55R- 01 0996

REF N°

1942

SERIAL N°

XXXX

DESCRIPTION

Ford Transit Custom & Ford Tourneo Custom 12/'12-



D =

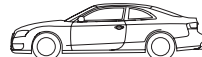

max kg

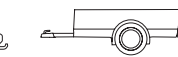

max kg

X

X 0.00981 ≤ 14,91 kN

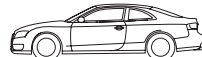

max kg

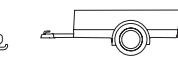

max kg

+

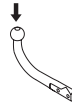

≤ 125 kg

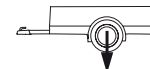

≤ 2800 kg



See the Certificate Of Conformity (COC) of your vehicle or contact your dealer to verify the max. trailer weight of your car!

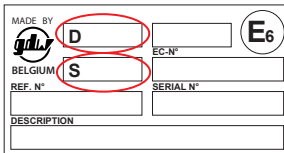
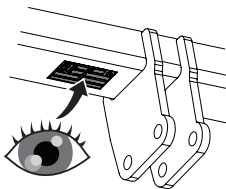
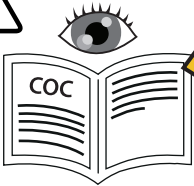

D-VALUE
S-LOAD

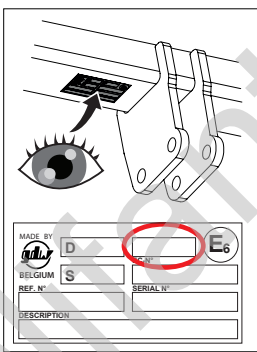
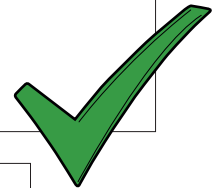
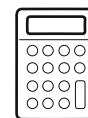

A50-X?

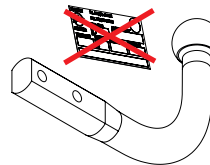

F?

+

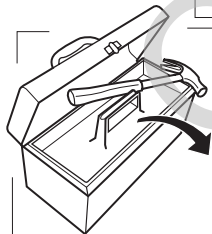
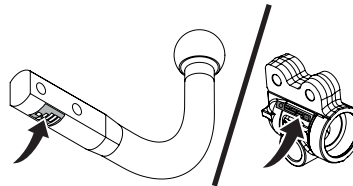

15

17

19

24

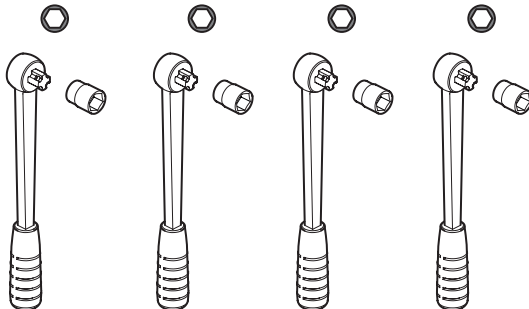

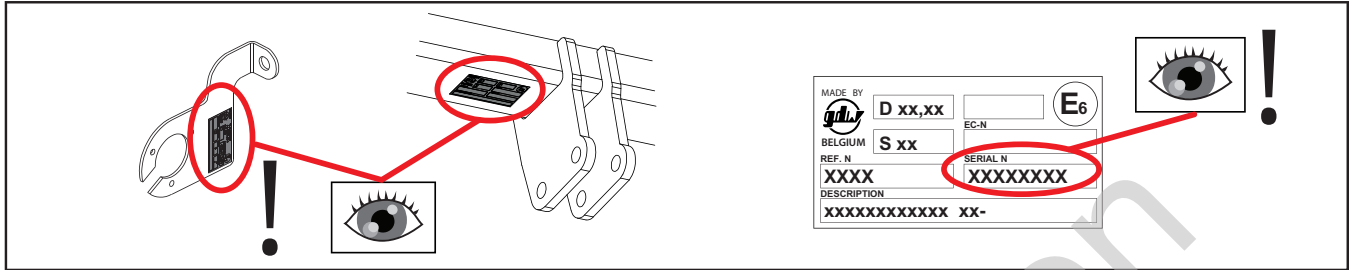

helpdesk@gdwtowbars.com
+32 56 62 77 79

Monday	08:00 - 12:00	12:30 - 16:30
Tuesday	08:00 - 12:00	12:30 - 16:30
Wednesday	08:00 - 12:00	12:30 - 16:30
Thursday	08:00 - 12:00	12:30 - 16:30
Friday	08:00 - 12:00	12:30 - 15:30

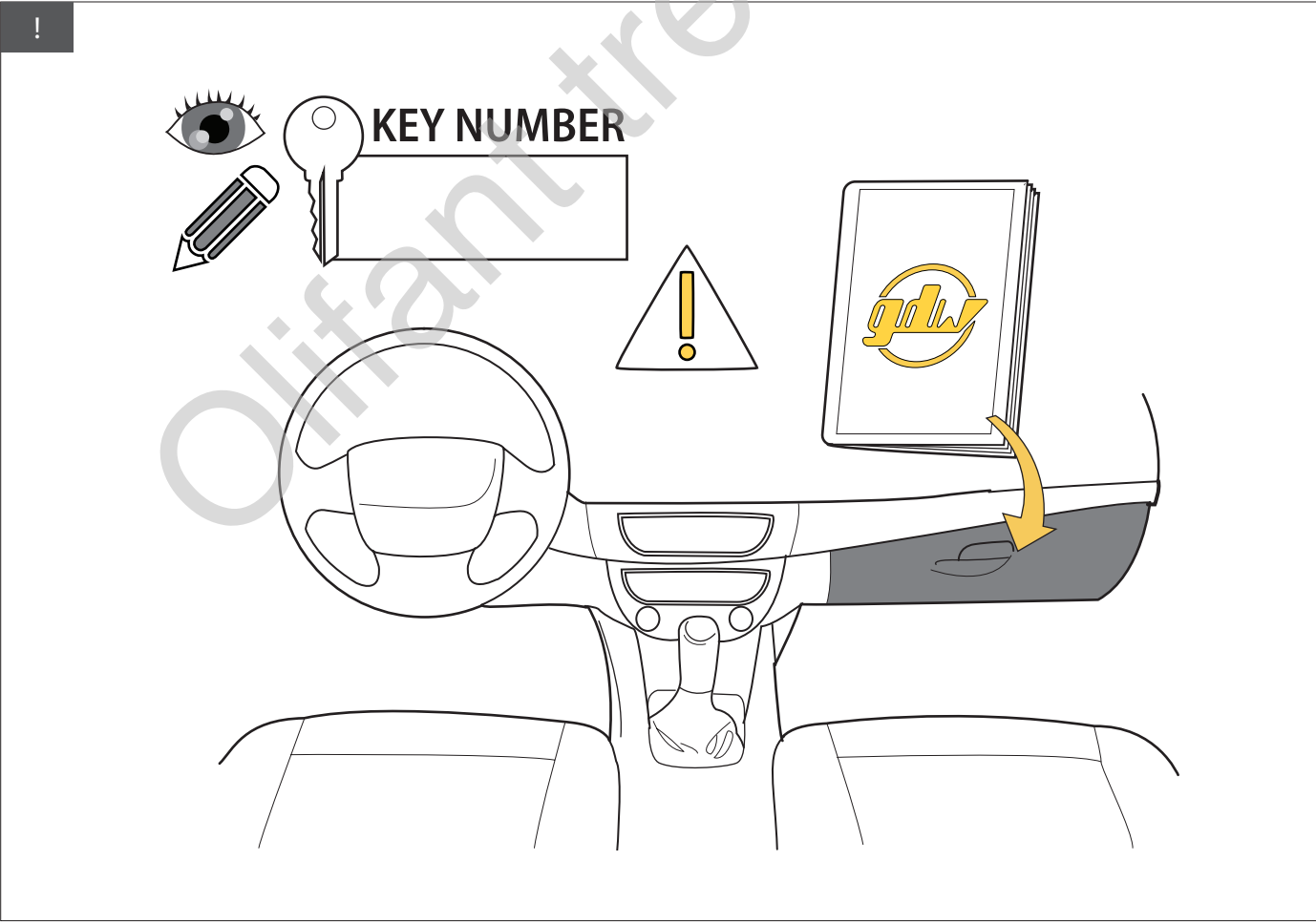

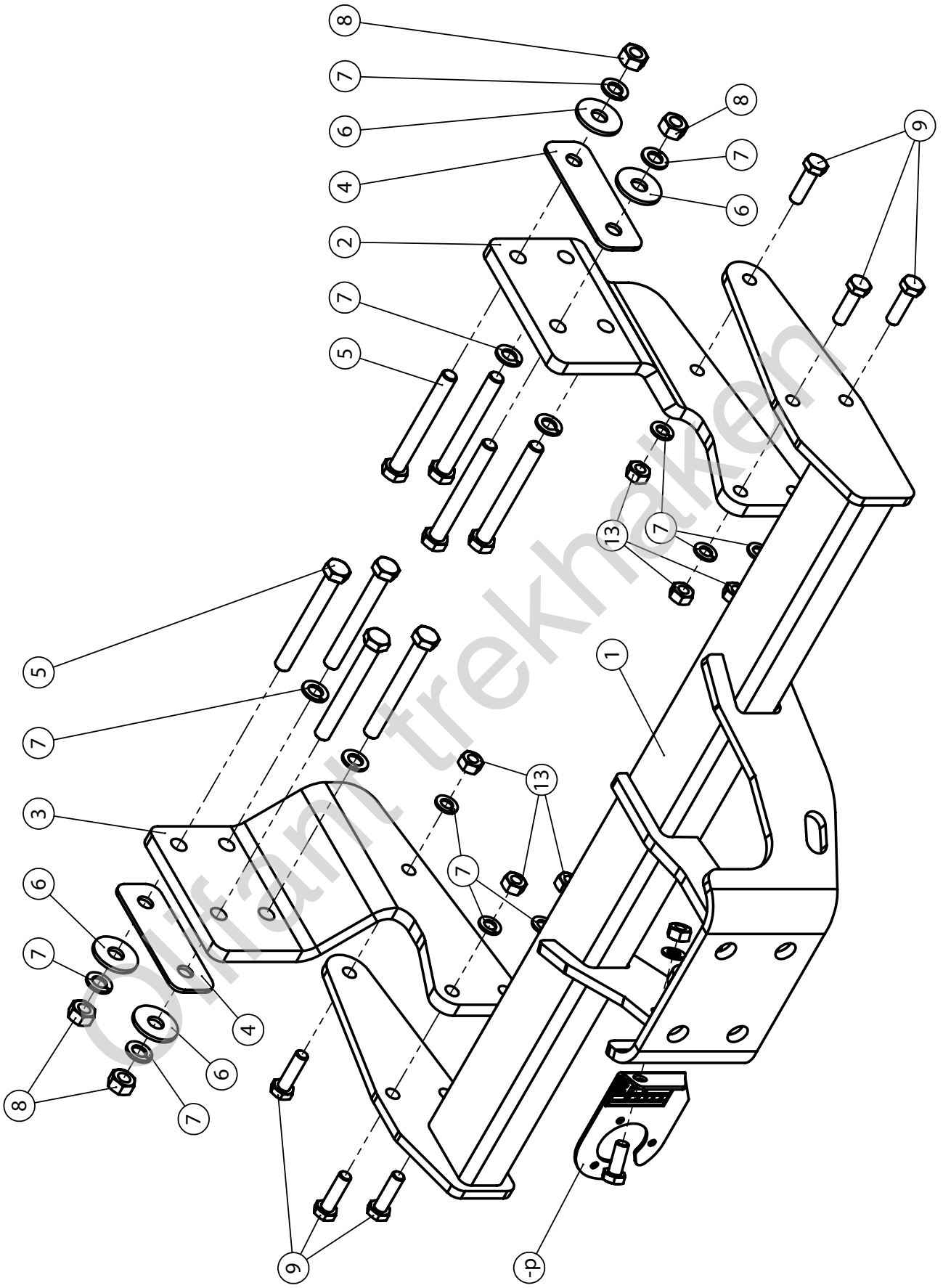

1		X1	GDW REF. 1942
2		X1	GDW REF. 2
3		X1	GDW REF. 3
4		X2	GDW REF. 4
5		X8	DIN931-M12X100
6		X4	DIN9021-M12-ELVZ Ø 37 X 13 X 3
7		X8	DIN128A-M12
8		X4	DIN934-M12
9		X6	DIN933-M10X35
10		X6	DIN128A-M10
11		X6	DIN934-M10
-P		X1	GDW REF. P29
↳		X1	DIN933-M10X25
↳		X1	DIN128A-M10
↳		X1	DIN934-M10

Geleverd met - Livré avec - Delivered with Geliiefert mit - Elementos adjuntos - Leveres med		X1	740.000
		X2	DIN128A-M16
		X2	DIN933-M16 X 50
		X2	DIN934-M16

1

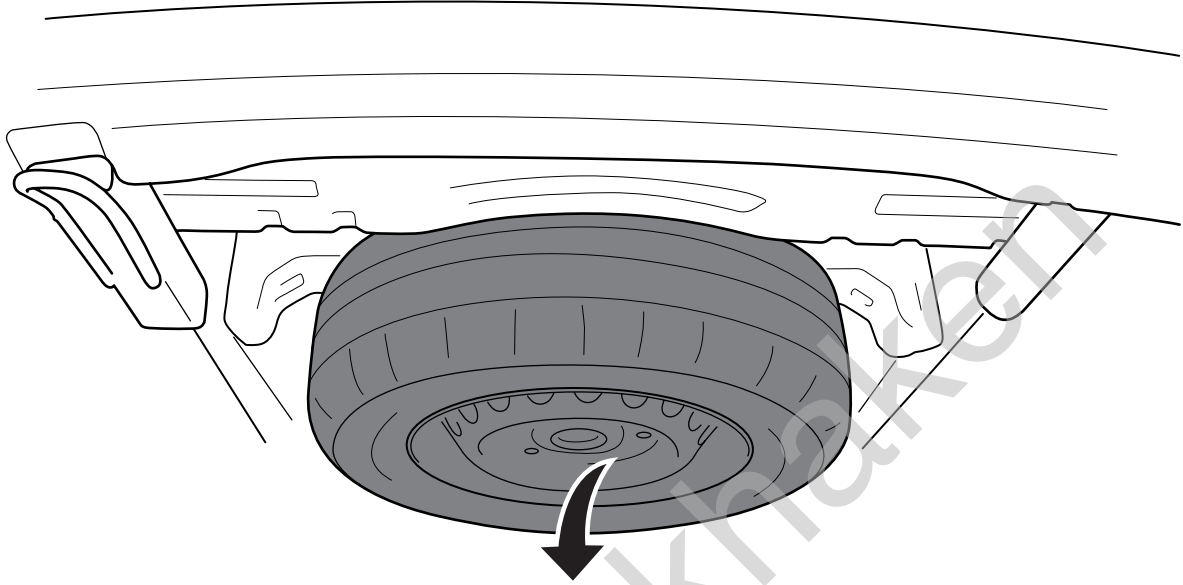
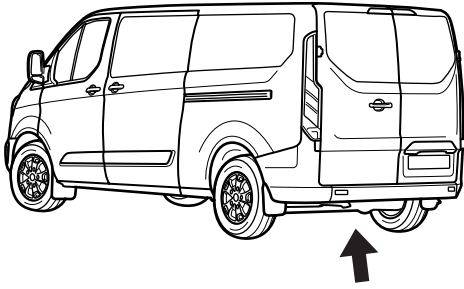

2

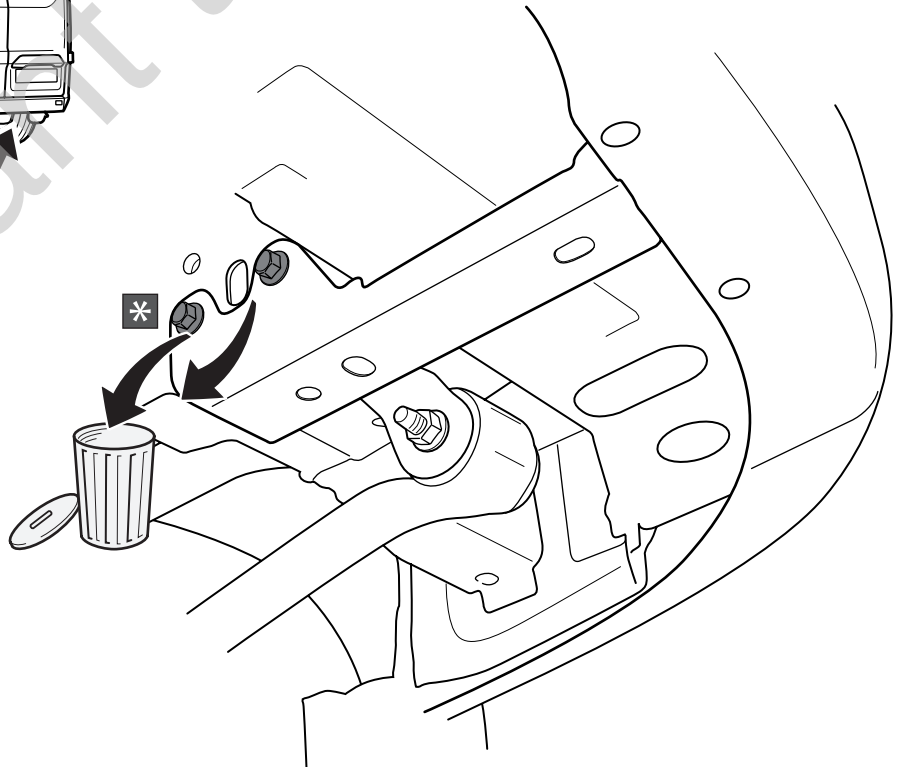
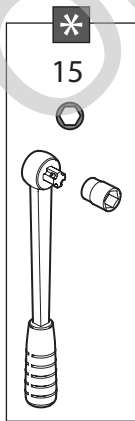
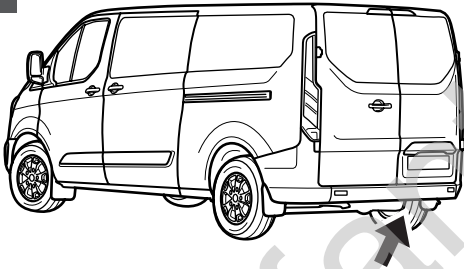

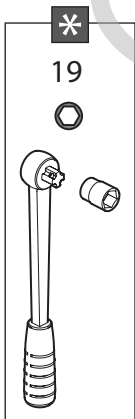
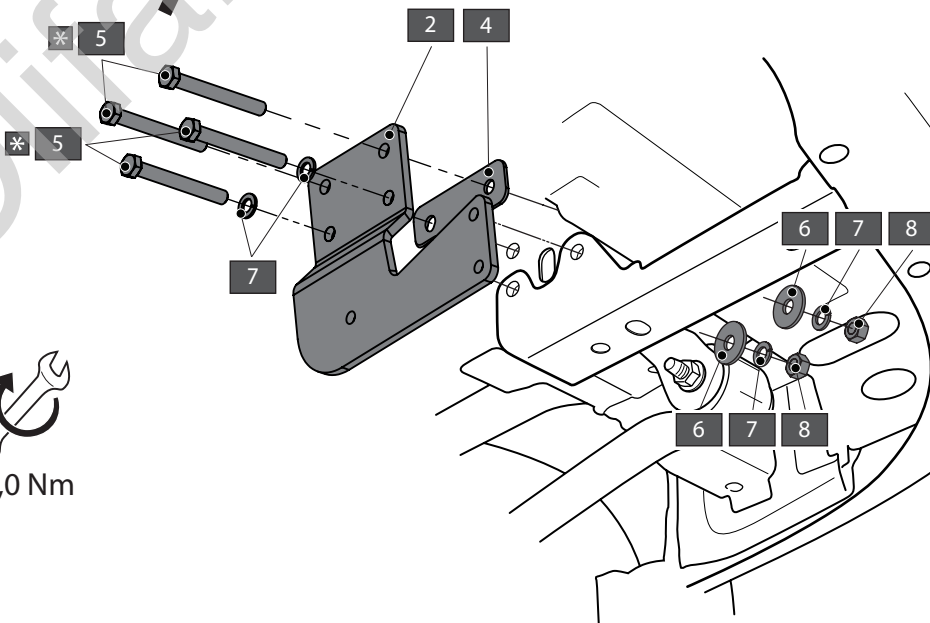
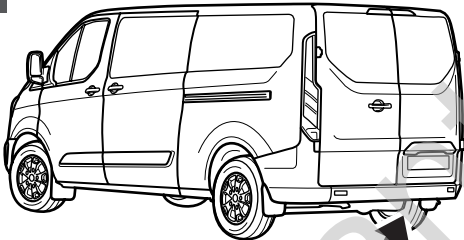
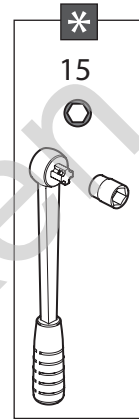
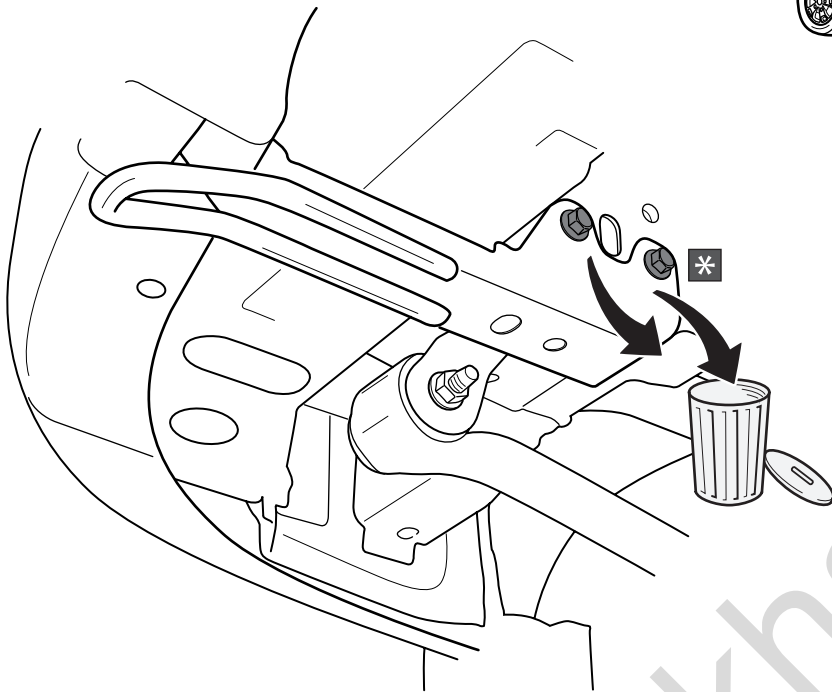
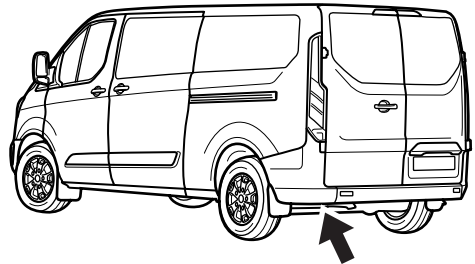

93,0 Nm

5

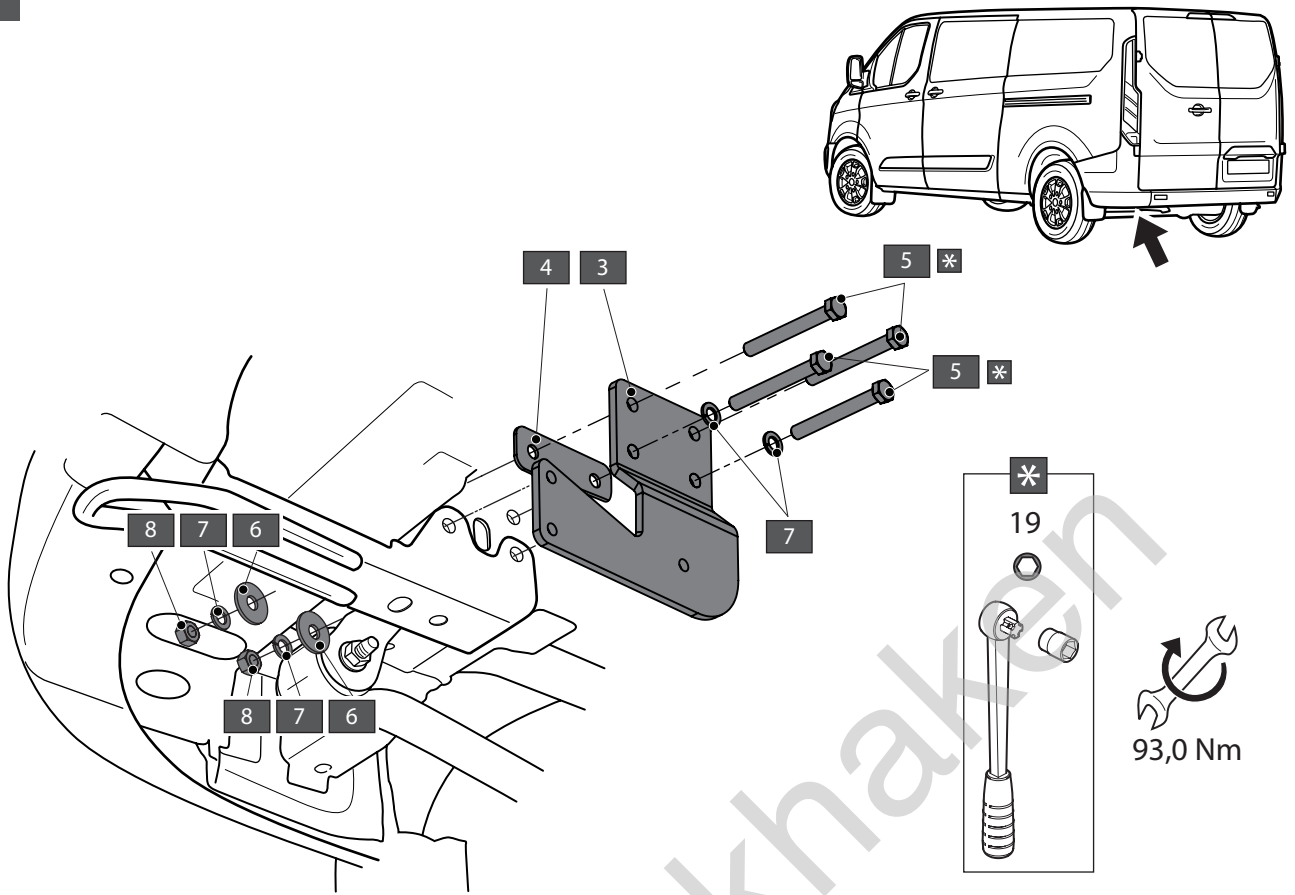

6

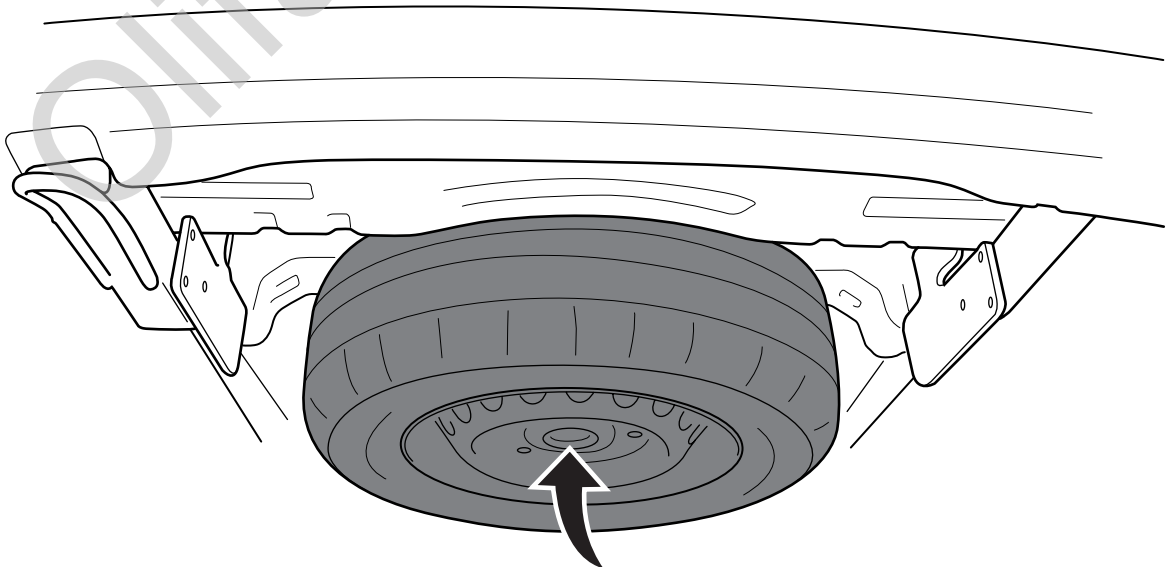
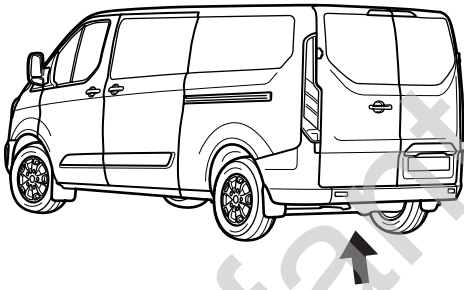

7

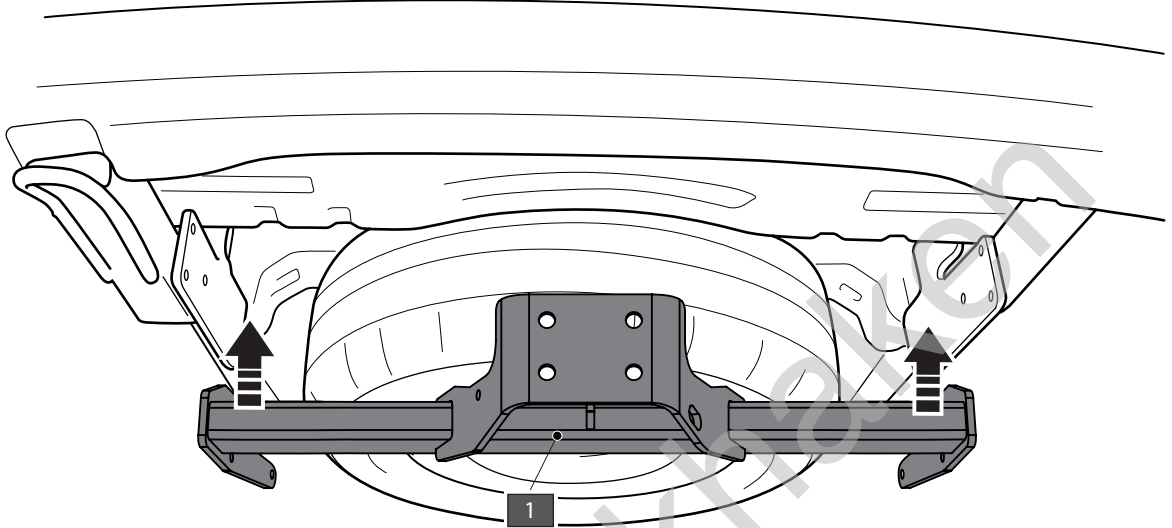
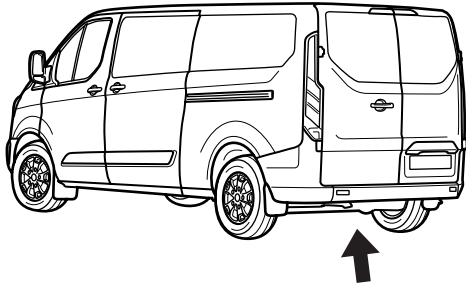

8

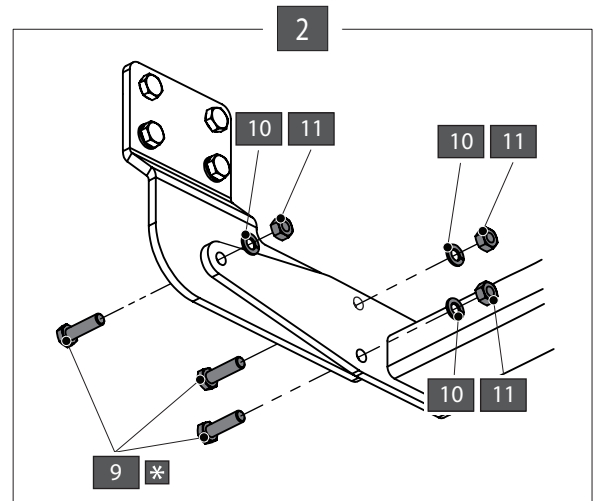
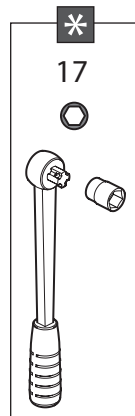
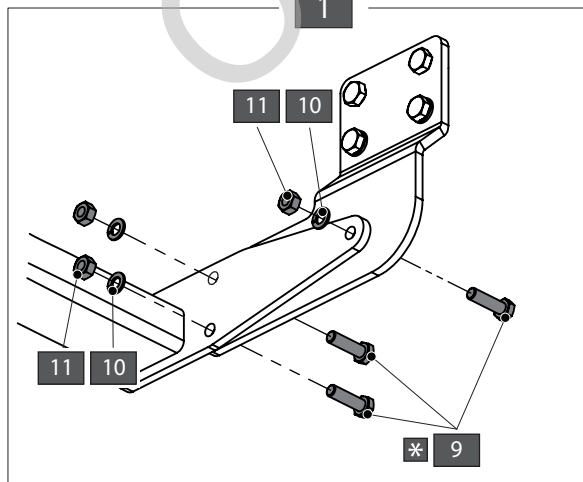
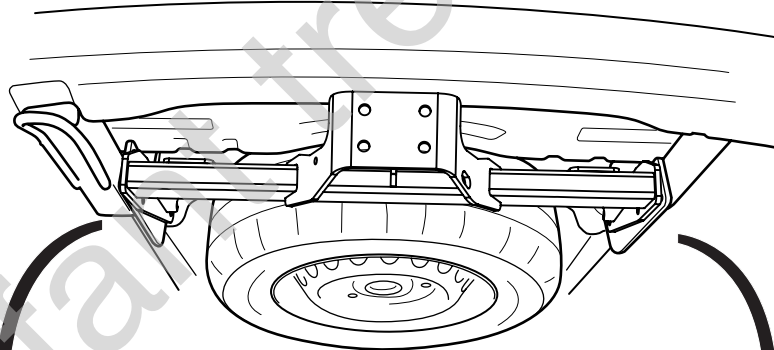

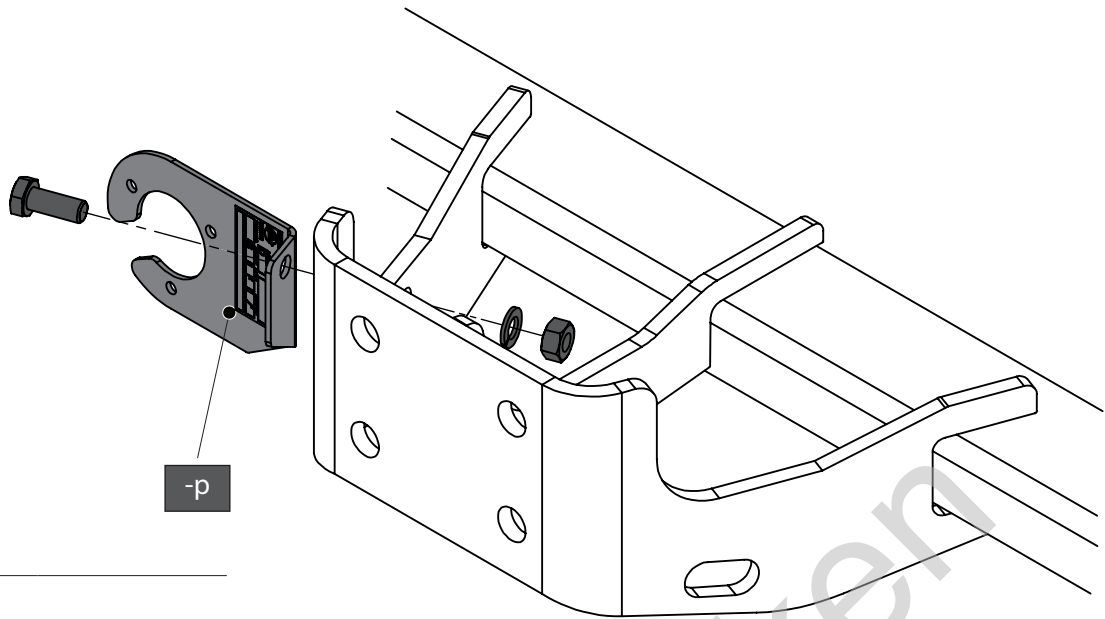

P		X1	GDW REF. P29
↳		X2	DIN933-M10X25
↳		X2	DIN128A-M10
↳		X2	DIN934-M10

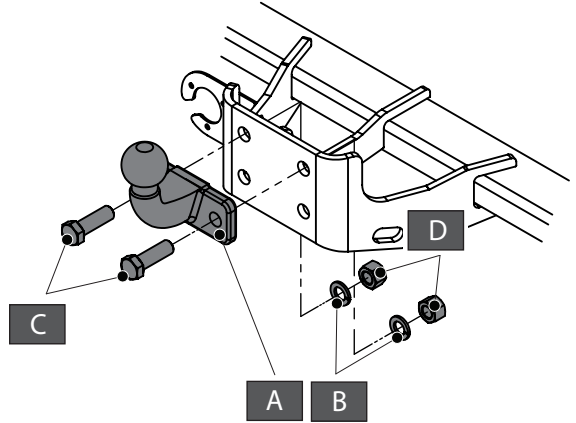
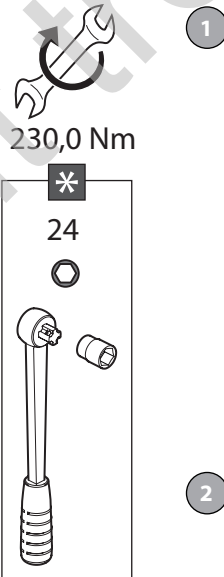
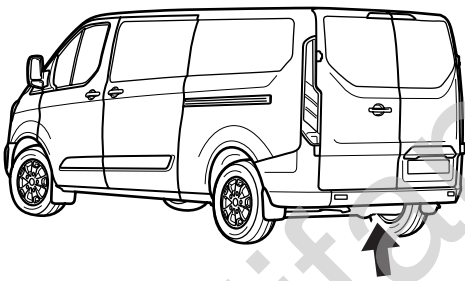

2

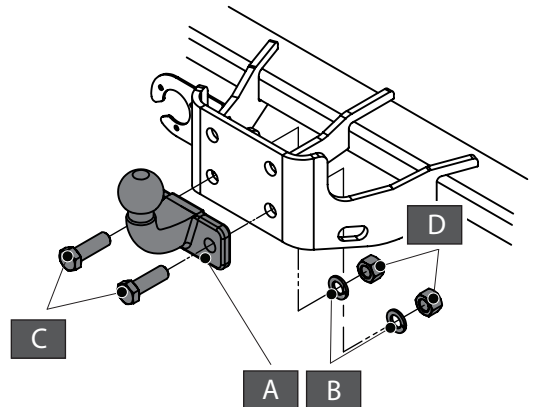

A		X1	740.000
B		X2	DIN128A-M16
C		X2	DIN933-M16 X 50
D		X2	DIN934-M16

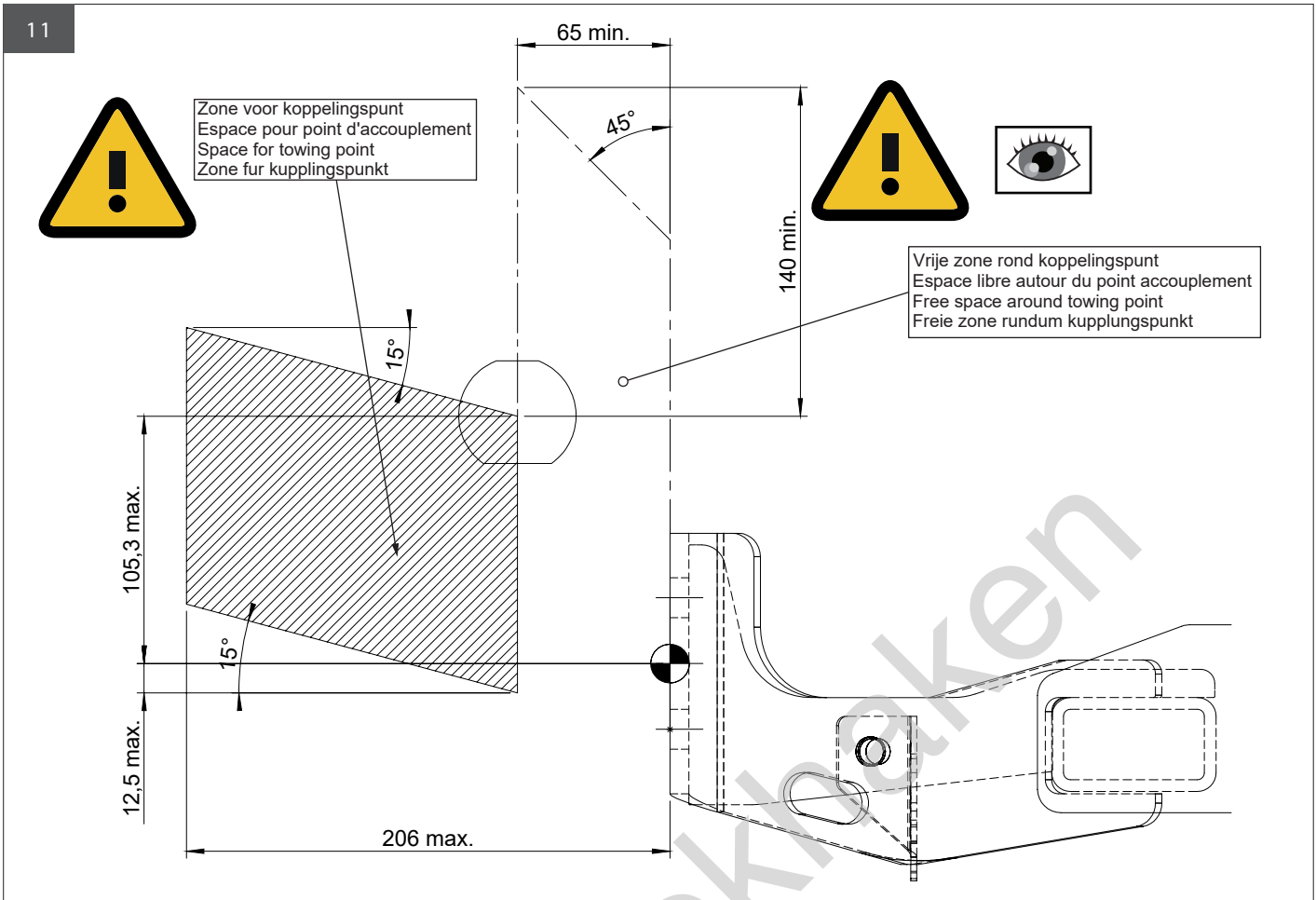

*

Opties - Options - Options - Optionen - Opciones - Muligheder

RK100WISSE

RK100BASIS

RK100KAP

VARIOBLOCK

RK243U115E

740.010

740.011

UNISTEP 630.100

UNISTEP 630.110

740.043

+

Warning symbols: exclamation mark in a triangle and an eye.

Warning symbol: exclamation mark in a triangle.

Art. ADAPT83x56

Warning symbols: eye and exclamation mark in a triangle.

Illustration of a vertical plate with a plus sign, a green checkmark, and a red X.

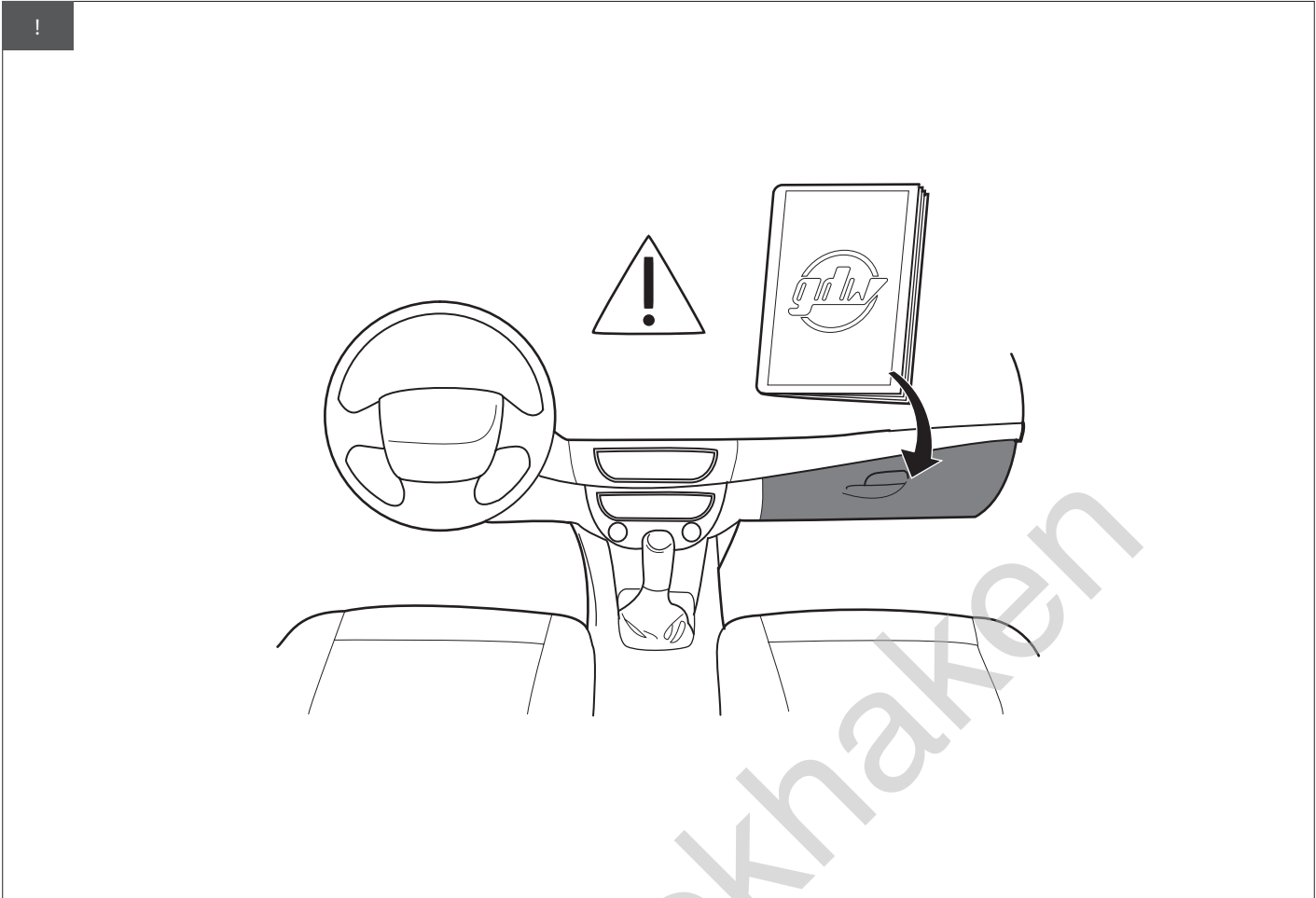

Olifant trekhaken